

**DONOHUE HEATING SERVICES  
ULTIMA DATA SHEETS**



# Content

|                                    |       |
|------------------------------------|-------|
| Range Overview                     | 02    |
| Horizontal Range Options           | 04-05 |
| LST Horizontal - E-Series emitter  | 06-40 |
| LST Horizontal - RT-Series emitter | 41-47 |
| Additional Options – Horizontal    | 48    |
| Vertical Range Options             | 50    |
| Vertical LST specifications        | 51-54 |
| Optional TRV Configurations        | 55-57 |

# Range Overview

## Product Description

The Merriott basic range of Low Surface Temperature (LST) radiators produce heat whilst having a low touch temperature. They are fitted over our range of Precision (E-Series), Primo (RT series) emitters and vertical Profile (S & D Series) emitters. For specific requirements, please contact your sales consultant.

Each basic LST cover consists of 2 endboxes, front panel, grilles, brackets and, depending on the style, a solid top. Every LST has at least 2 grilles to allow an inlet and outlet of air.

Heights are in increments of 70mm, from 280mm to 980mm. Lengths are in increments of 100mm from 300mm longer than the smallest length of the emitter (400mm). The maximum length of LST cover in one section is 3000mm, but longer length are achieved by joining cover with special joiner piece. (see page 53). Speak to your sales consultant.

The Merriott LST feature round edges making particularly suitable for hospitals, schools, nursing homes and sheltered accommodation as well as high security areas in prisons and low level protection in pediatric wards.

When coupled with a properly balanced LPHW (Low Pressure Hot Water) system operating with normal flow and return temperatures, the front panel will not exceed 43 °C. Please note, the lower the flow and return temperatures, the cooler the casing will be. Taller casings will provide more effective convection with lower issuing air temperatures.

## Features

Merriott's horizontal LST is available in seven styles and the vertical in 2 styles. They cater for all possible requirements, such as:

- Free standing unit (in front of full height glazing)
- Wall to wall applications
- Corner applications (internal and external 45 °, 90 °, 135 °)
- Elevated units (kitchens, toilets).

## Finish

Our standard paint finish is semi – gloss RAL 9016 (white) in epoxy polyester powder. An extensive range of other RAL and BS colours are available upon request.

## Options

Merriott offers a range of options for Thermostatic Radiator Valve (TRV) and grilles and can also meet special requirements such as wall to wall application with internal and external corners. Speak to Sales office for details.

## Quality

All Merriott emitters coupled with Merriott LST's are manufactured and tested in accordance with BS EN 442 and the NF quality mark requirements, in its state of the art BS EN ISO 9001:2008 accredited manufacturing facility.

## Design & Performance

As products are subject to continuous development to improve design and performance, Merriott reserves the right to alter specifications without notice.

## Materials

Merriott LST casings are manufactured from flat steel tubes, 70mm x 11mm, with a standard thickness of 1.5mm. Other thicknesses are available upon request.

## Warranty

Merriott radiators are guaranteed for a period of 10 years from date of purchase in respect of defective materials and workmanship. The system should be designed in accordance with the British Standard Code of Practice for Water Based Heating Systems in Buildings **BS EN 12828:2012+A1:2014** and **BS EN 12831: 2003**. The installation and commissioning of the system should comply with **BS EN 14336:2004**. On completion of the installation, the system should be properly flushed and filled in accordance with the British Code of Practice for the Treatment of Water in Domestic Hot Water Central Heating Systems **BS 7593:2006**, Part L of Building Regulations and Good Practice Guidance for Scotland. Merriott strongly recommends the use of corrosion inhibitor for all applications. Failure to observe these standards may invalidate the manufacturer's warranty.

# Horizontal Model Options

## Precision (E-Series) & Primo (RT-Series) LST Casing Styles

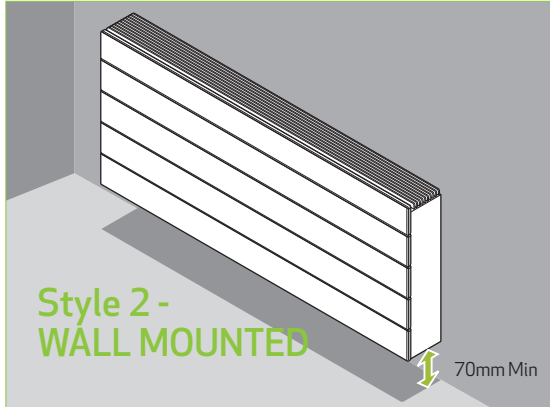

- Top grille
- Bottom grille

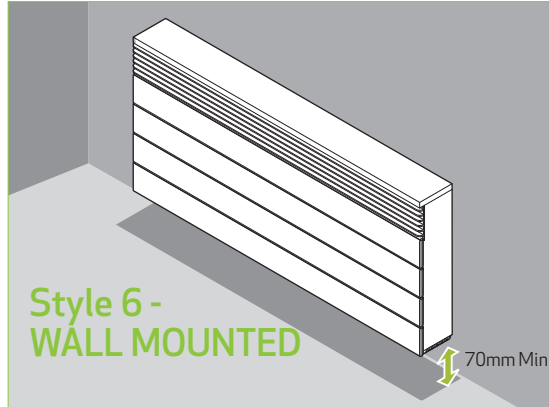

- Forward-facing top grille with solid top
- Bottom grille

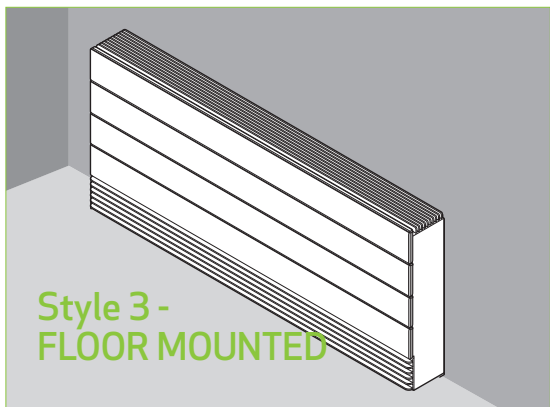

- Forward-facing bottom grille
- Top grille

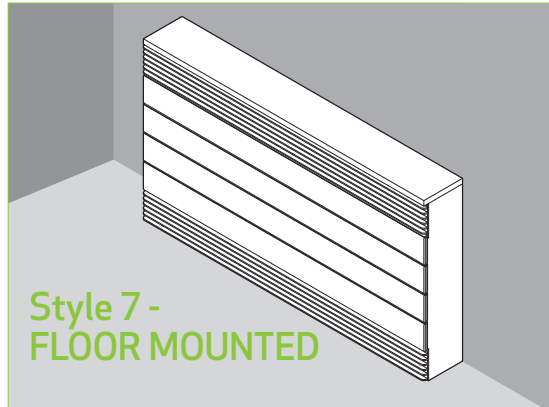

- Forward-facing bottom grille
- Forward-facing top grille with solid top

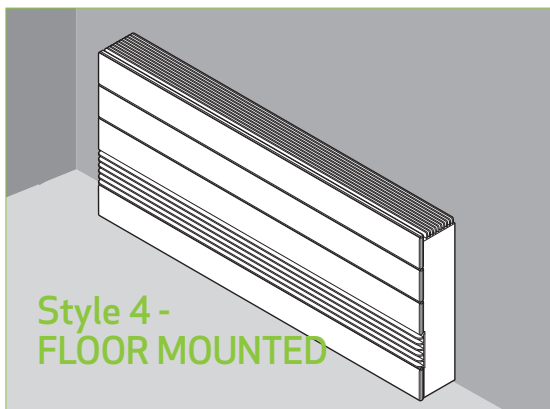

- Forward-facing bottom grille
- Top grille



- Forward-facing bottom grille
- Forward-facing top grille with solid top

# Horizontal Model Options

Freestanding option for Precision (E-Series)  
and Primo (RT-Series)

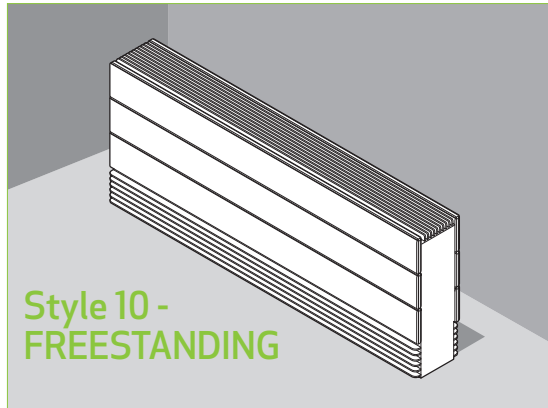

- Double-sided (free standing)
- Bottom front & back grilles
- Top grille

Emitters for all style 10 must be ordered with feet.

Please contact the Merriott Sales Office for more information.



# Emitter Model Options - Horizontal

## Precision (E-series)

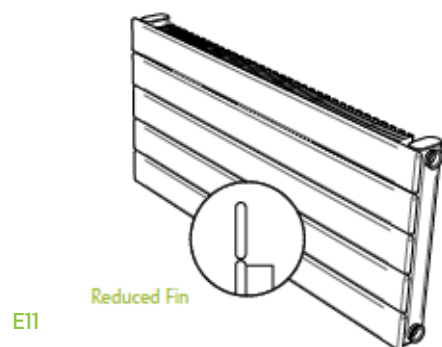

E11

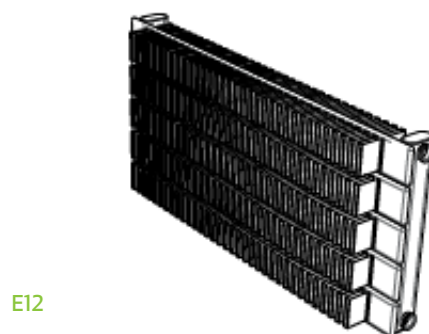

E12

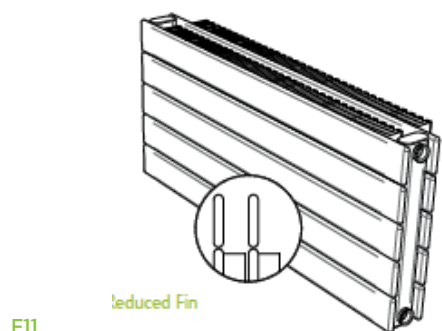

E11

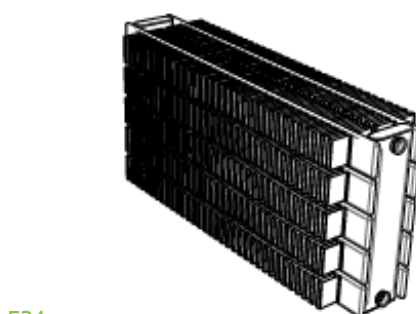

E24

## Primo (RT series)

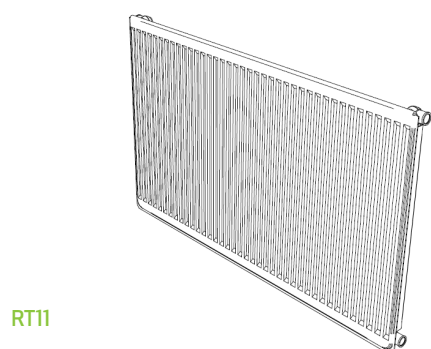

RT11

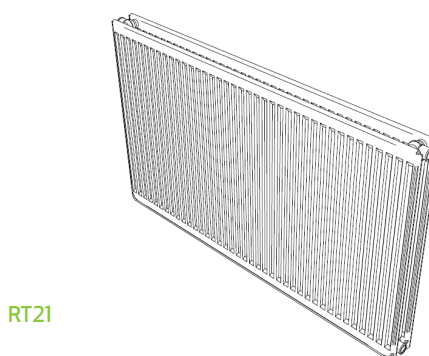

RT21

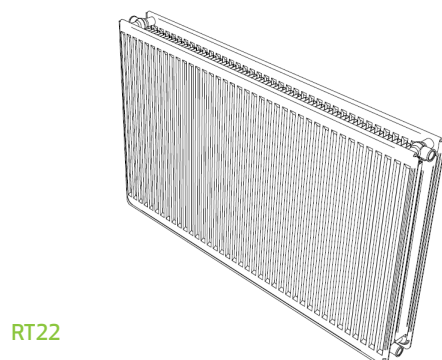

RT22

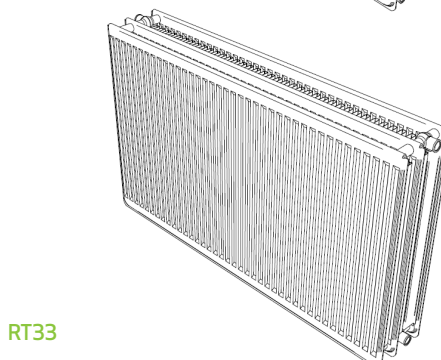

RT33

## Horizontal LST with Precision (E-Series) Emitter

# Technical Specifications – LST Horizontal Using Precision (E-Series) Emitter

## Dimensions for LST Cover Style 2 & 6

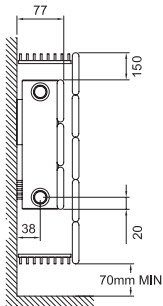

E11

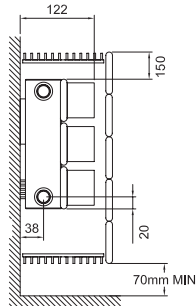

E12

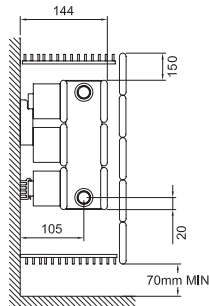

E22

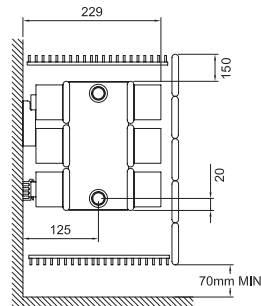

E24

## Dimensions for LST Cover Style 3, 4, 7 & 8

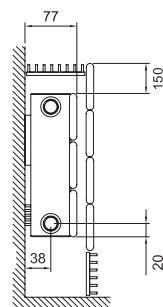

E11

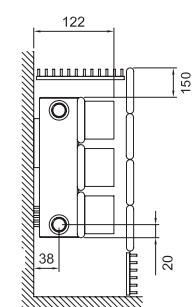

E12

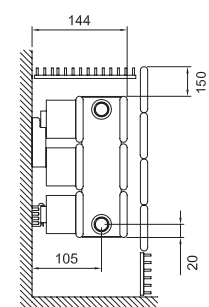

E22

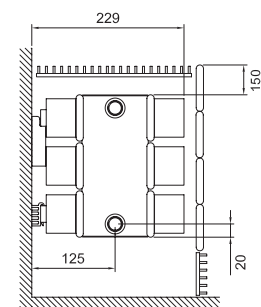

E24

## Dimensions for LST cover Style 10

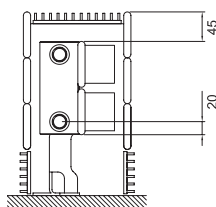

E12

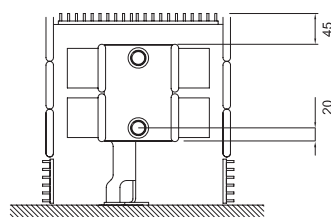

E24

Emitter heights in the following output tables are the maxima for the given casing heights. However, lower height emitters may be selected in order to increase space available within the casing for pipework. It may also be desirable to keep case heights consistent for aesthetic reasons.

Merriott recommends the casing should be 300mm longer than the emitter underneath. The output listed are based on this arrangement. For any additional information, please contact your Merriott sales consultant.



# Technical Specifications

## Precision (E-Series) Radiators

All data are provided per metre.

| Per Metre           | E11                            |                   |                 | E12                            |                   |                 | E22                            |                   |                 | E24                            |                   |                 |
|---------------------|--------------------------------|-------------------|-----------------|--------------------------------|-------------------|-----------------|--------------------------------|-------------------|-----------------|--------------------------------|-------------------|-----------------|
| Emitter Height (mm) | Surface Area (m <sup>2</sup> ) | Water Content (l) | Dry Weight (kg) | Surface Area (m <sup>2</sup> ) | Water Content (l) | Dry Weight (kg) | Surface Area (m <sup>2</sup> ) | Water Content (l) | Dry Weight (kg) | Surface Area (m <sup>2</sup> ) | Water Content (l) | Dry Weight (kg) |
| 143                 | 1.39                           | 1.05              | 6.75            | 2.43                           | 1.05              | 9.25            | 2.74                           | 2.50              | 13.67           | 4.83                           | 2.50              | 18.67           |
| 215                 | 2.09                           | 1.81              | 10.10           | 3.65                           | 1.81              | 13.94           | 4.11                           | 3.40              | 18.22           | 7.24                           | 3.40              | 25.90           |
| 288                 | 2.78                           | 2.58              | 13.50           | 4.87                           | 2.58              | 18.71           | 5.48                           | 4.30              | 22.84           | 9.65                           | 4.30              | 33.26           |
| 360                 | 3.47                           | 3.20              | 17.20           | 6.08                           | 3.20              | 24.10           | 6.85                           | 5.20              | 27.40           | 12.06                          | 5.20              | 41.20           |
| 433                 | 4.17                           | 4.01              | 20.65           | 7.30                           | 4.01              | 28.51           | 8.21                           | 7.31              | 35.81           | 14.48                          | 7.31              | 51.53           |
| 505                 | 4.87                           | 4.80              | 24.05           | 8.52                           | 4.80              | 32.85           | 9.58                           | 8.50              | 44.10           | 16.89                          | 8.50              | 61.70           |
| 578                 | 5.56                           | 5.43              | 27.50           | 9.74                           | 5.43              | 37.26           | 10.95                          | 10.16             | 50.51           | 19.30                          | 10.16             | 70.03           |
| 650                 | 6.26                           | 6.10              | 30.90           | 10.95                          | 6.10              | 41.60           | 12.32                          | 11.80             | 60.80           | 21.72                          | 11.80             | 82.20           |
| 723                 | 6.95                           | 6.84              | 34.15           | 12.17                          | 6.84              | 46.02           | 13.69                          | 13.21             | 67.56           | 24.13                          | 13.21             | 91.30           |
| 795                 | 7.65                           | 7.56              | 37.35           | 13.39                          | 7.56              | 50.38           | 15.06                          | 14.59             | 74.24           | 26.54                          | 14.59             | 100.30          |
| 868                 | 7.82                           | 8.30              | 40.60           | 13.56                          | 8.30              | 54.80           | 16.43                          | 16.00             | 81.00           | 27.91                          | 16.00             | 109.40          |

Conversion factors and resistance diagram for Precision emitters can be found in the Precision brochure.

# Style 2 - Case Height: 350mm & 420mm

## Precision (E-Series) Outputs

Emitter Height: 143mm  
Cover height: 350mm

| Emitter Type:<br>Case Depth: |                     | E11<br>103mm | E12<br>153mm | E22<br>176mm | E24<br>259mm |
|------------------------------|---------------------|--------------|--------------|--------------|--------------|
| Case Length (mm)             | Emitter Length (mm) | $\Delta T50$ | $\Delta T50$ | $\Delta T50$ | $\Delta T50$ |
| 700                          | 400                 | 99           | 144          | 244          | 320          |
| 800                          | 500                 | 124          | 180          | 305          | 400          |
| 900                          | 600                 | 149          | 215          | 366          | 479          |
| 1000                         | 700                 | 174          | 251          | 427          | 559          |
| 1100                         | 800                 | 198          | 287          | 488          | 639          |
| 1200                         | 900                 | 223          | 323          | 549          | 719          |
| 1300                         | 1000                | 248          | 359          | 610          | 799          |
| 1400                         | 1100                | 273          | 395          | 671          | 879          |
| 1500                         | 1200                | 298          | 431          | 732          | 959          |
| 1600                         | 1300                | 322          | 467          | 793          | 1039         |
| 1700                         | 1400                | 347          | 503          | 854          | 1119         |
| 1800                         | 1500                | 372          | 539          | 915          | 1199         |
| 1900                         | 1600                | 397          | 574          | 976          | 1278         |
| 2000                         | 1700                | 422          | 610          | 1037         | 1358         |
| 2100                         | 1800                | 446          | 646          | 1098         | 1438         |
| 2200                         | 1900                | 471          | 682          | 1159         | 1518         |
| 2300                         | 2000                | 496          | 718          | 1220         | 1598         |
| 2400                         | 2100                | 521          | 754          | 1281         | 1678         |
| 2500                         | 2200                | 546          | 790          | 1342         | 1758         |
| 2600                         | 2300                | 570          | 826          | 1403         | 1838         |
| 2700                         | 2400                | 595          | 862          | 1464         | 1918         |
| 2800                         | 2500                | 620          | 898          | 1525         | 1998         |
| 2900                         | 2600                | 645          | 933          | 1586         | 2077         |
| 3000                         | 2700                | 670          | 969          | 1647         | 2157         |

Emitter Height: 215mm  
Cover height: 420mm

| Emitter Type:<br>Case Depth: |                     | E11<br>103mm | E12<br>153mm | E22<br>176mm | E24<br>259mm |
|------------------------------|---------------------|--------------|--------------|--------------|--------------|
| Case Length (mm)             | Emitter Length (mm) | $\Delta T50$ | $\Delta T50$ | $\Delta T50$ | $\Delta T50$ |
| 700                          | 400                 | 145          | 204          | 335          | 439          |
| 800                          | 500                 | 182          | 256          | 419          | 549          |
| 900                          | 600                 | 218          | 307          | 503          | 658          |
| 1000                         | 700                 | 254          | 358          | 587          | 768          |
| 1100                         | 800                 | 290          | 409          | 670          | 878          |
| 1200                         | 900                 | 327          | 460          | 754          | 987          |
| 1300                         | 1000                | 363          | 511          | 838          | 1097         |
| 1400                         | 1100                | 399          | 562          | 922          | 1207         |
| 1500                         | 1200                | 436          | 613          | 1006         | 1316         |
| 1600                         | 1300                | 472          | 664          | 1089         | 1426         |
| 1700                         | 1400                | 508          | 715          | 1173         | 1536         |
| 1800                         | 1500                | 545          | 767          | 1257         | 1646         |
| 1900                         | 1600                | 581          | 818          | 1341         | 1755         |
| 2000                         | 1700                | 617          | 869          | 1425         | 1865         |
| 2100                         | 1800                | 653          | 920          | 1508         | 1975         |
| 2200                         | 1900                | 690          | 971          | 1592         | 2084         |
| 2300                         | 2000                | 726          | 1022         | 1676         | 2194         |
| 2400                         | 2100                | 762          | 1073         | 1760         | 2304         |
| 2500                         | 2200                | 799          | 1124         | 1844         | 2413         |
| 2600                         | 2300                | 835          | 1175         | 1927         | 2523         |
| 2700                         | 2400                | 871          | 1226         | 2011         | 2633         |
| 2800                         | 2500                | 908          | 1278         | 2095         | 2743         |
| 2900                         | 2600                | 944          | 1329         | 2179         | 2852         |
| 3000                         | 2700                | 980          | 1380         | 2263         | 2962         |

# Style 2 - Case Height: 490mm & 560mm

## Precision (E-Series) Outputs

Emitter Height: 288mm  
Cover Height: 490mm

| Emitter Type:<br>Case Depth: |                     | E11<br>103mm | E12<br>153mm | E22<br>176mm | E24<br>259mm |
|------------------------------|---------------------|--------------|--------------|--------------|--------------|
| Case Length (mm)             | Emitter Length (mm) | $\Delta T50$ | $\Delta T50$ | $\Delta T50$ | $\Delta T50$ |
| 700                          | 400                 | 192          | 264          | 420          | 550          |
| 800                          | 500                 | 240          | 330          | 526          | 688          |
| 900                          | 600                 | 287          | 396          | 631          | 825          |
| 1000                         | 700                 | 335          | 462          | 736          | 963          |
| 1100                         | 800                 | 383          | 528          | 841          | 1100         |
| 1200                         | 900                 | 431          | 594          | 946          | 1238         |
| 1300                         | 1000                | 479          | 660          | 1051         | 1375         |
| 1400                         | 1100                | 527          | 726          | 1156         | 1513         |
| 1500                         | 1200                | 575          | 792          | 1261         | 1650         |
| 1600                         | 1300                | 623          | 858          | 1366         | 1788         |
| 1700                         | 1400                | 671          | 924          | 1471         | 1925         |
| 1800                         | 1500                | 719          | 990          | 1577         | 2063         |
| 1900                         | 1600                | 766          | 1056         | 1682         | 2200         |
| 2000                         | 1700                | 814          | 1122         | 1787         | 2338         |
| 2100                         | 1800                | 862          | 1188         | 1892         | 2475         |
| 2200                         | 1900                | 910          | 1254         | 1997         | 2613         |
| 2300                         | 2000                | 958          | 1320         | 2102         | 2750         |
| 2400                         | 2100                | 1006         | 1386         | 2207         | 2888         |
| 2500                         | 2200                | 1054         | 1452         | 2312         | 3025         |
| 2600                         | 2300                | 1102         | 1518         | 2417         | 3163         |
| 2700                         | 2400                | 1150         | 1584         | 2522         | 3300         |
| 2800                         | 2500                | 1198         | 1650         | 2628         | 3438         |
| 2900                         | 2600                | 1245         | 1716         | 2733         | 3575         |
| 3000                         | 2700                | 1293         | 1782         | 2838         | 3713         |

Emitter Height: 360mm  
Cover Height: 560mm

| Emitter Type:<br>Case Depth: |                     | E11<br>103mm | E12<br>153mm | E22<br>176mm | E24<br>259mm |
|------------------------------|---------------------|--------------|--------------|--------------|--------------|
| Case Length (mm)             | Emitter Length (mm) | $\Delta T50$ | $\Delta T50$ | $\Delta T50$ | $\Delta T50$ |
| 700                          | 400                 | 252          | 332          | 499          | 664          |
| 800                          | 500                 | 315          | 416          | 624          | 831          |
| 900                          | 600                 | 378          | 499          | 749          | 997          |
| 1000                         | 700                 | 441          | 582          | 874          | 1163         |
| 1100                         | 800                 | 504          | 665          | 998          | 1329         |
| 1200                         | 900                 | 567          | 748          | 1123         | 1495         |
| 1300                         | 1000                | 630          | 831          | 1248         | 1661         |
| 1400                         | 1100                | 693          | 914          | 1373         | 1827         |
| 1500                         | 1200                | 756          | 997          | 1498         | 1993         |
| 1600                         | 1300                | 819          | 1080         | 1622         | 2159         |
| 1700                         | 1400                | 882          | 1163         | 1747         | 2325         |
| 1800                         | 1500                | 945          | 1247         | 1872         | 2492         |
| 1900                         | 1600                | 1008         | 1330         | 1997         | 2658         |
| 2000                         | 1700                | 1071         | 1413         | 2122         | 2824         |
| 2100                         | 1800                | 1134         | 1496         | 2246         | 2990         |
| 2200                         | 1900                | 1197         | 1579         | 2371         | 3156         |
| 2300                         | 2000                | 1260         | 1662         | 2496         | 3322         |
| 2400                         | 2100                | 1323         | 1745         | 2621         | 3488         |
| 2500                         | 2200                | 1386         | 1828         | 2746         | 3654         |
| 2600                         | 2300                | 1449         | 1911         | 2870         | 3820         |
| 2700                         | 2400                | 1512         | 1994         | 2995         | 3986         |
| 2800                         | 2500                | 1575         | 2078         | 3120         | 4153         |
| 2900                         | 2600                | 1638         | 2161         | 3245         | 4319         |
| 3000                         | 2700                | 1701         | 2244         | 3370         | 4485         |

# Style 2 - Case Height: 630mm & 700mm

## Precision (E-Series) Outputs

Emitter Height: 433mm

Cover Height: 630mm

| Emitter Type:<br>Case Depth: |                     | E11<br>103mm | E12<br>153mm | E22<br>176mm | E24<br>259mm |
|------------------------------|---------------------|--------------|--------------|--------------|--------------|
| Case Length (mm)             | Emitter Length (mm) | $\Delta T50$ | $\Delta T50$ | $\Delta T50$ | $\Delta T50$ |
| 700                          | 400                 | 294          | 378          | 575          | 758          |
| 800                          | 500                 | 367          | 472          | 719          | 948          |
| 900                          | 600                 | 440          | 566          | 863          | 1137         |
| 1000                         | 700                 | 514          | 661          | 1007         | 1327         |
| 1100                         | 800                 | 587          | 755          | 1150         | 1516         |
| 1200                         | 900                 | 661          | 850          | 1294         | 1706         |
| 1300                         | 1000                | 734          | 944          | 1438         | 1895         |
| 1400                         | 1100                | 807          | 1038         | 1582         | 2085         |
| 1500                         | 1200                | 881          | 1133         | 1726         | 2274         |
| 1600                         | 1300                | 954          | 1227         | 1869         | 2464         |
| 1700                         | 1400                | 1028         | 1322         | 2013         | 2653         |
| 1800                         | 1500                | 1101         | 1416         | 2157         | 2843         |
| 1900                         | 1600                | 1174         | 1510         | 2301         | 3032         |
| 2000                         | 1700                | 1248         | 1605         | 2445         | 3222         |
| 2100                         | 1800                | 1321         | 1699         | 2588         | 3411         |
| 2200                         | 1900                | 1395         | 1794         | 2732         | 3601         |
| 2300                         | 2000                | 1468         | 1888         | 2876         | 3790         |
| 2400                         | 2100                | 1541         | 1982         | 3020         | 3980         |
| 2500                         | 2200                | 1615         | 2077         | 3164         | 4169         |
| 2600                         | 2300                | 1688         | 2171         | 3307         | 4359         |
| 2700                         | 2400                | 1762         | 2266         | 3451         | 4548         |
| 2800                         | 2500                | 1835         | 2360         | 3595         | 4738         |
| 2900                         | 2600                | 1908         | 2454         | 3739         | 4927         |
| 3000                         | 2700                | 1982         | 2549         | 3883         | 5117         |

Emitter Height: 505mm

Cover Height: 700mm

| Emitter Type:<br>Case Depth: |                     | E11<br>103mm | E12<br>153mm | E22<br>176mm | E24<br>259mm |
|------------------------------|---------------------|--------------|--------------|--------------|--------------|
| Case Length (mm)             | Emitter Length (mm) | $\Delta T50$ | $\Delta T50$ | $\Delta T50$ | $\Delta T50$ |
| 700                          | 400                 | 333          | 422          | 647          | 844          |
| 800                          | 500                 | 417          | 528          | 809          | 1055         |
| 900                          | 600                 | 500          | 633          | 971          | 1265         |
| 1000                         | 700                 | 583          | 739          | 1133         | 1476         |
| 1100                         | 800                 | 666          | 844          | 1294         | 1687         |
| 1200                         | 900                 | 750          | 950          | 1456         | 1898         |
| 1300                         | 1000                | 833          | 1055         | 1618         | 2109         |
| 1400                         | 1100                | 916          | 1161         | 1780         | 2320         |
| 1500                         | 1200                | 1000         | 1266         | 1942         | 2531         |
| 1600                         | 1300                | 1083         | 1372         | 2103         | 2742         |
| 1700                         | 1400                | 1166         | 1477         | 2265         | 2953         |
| 1800                         | 1500                | 1250         | 1583         | 2427         | 3164         |
| 1900                         | 1600                | 1333         | 1688         | 2589         | 3374         |
| 2000                         | 1700                | 1416         | 1794         | 2751         | 3585         |
| 2100                         | 1800                | 1499         | 1899         | 2912         | 3796         |
| 2200                         | 1900                | 1583         | 2005         | 3074         | 4007         |
| 2300                         | 2000                | 1666         | 2110         | 3236         | 4218         |
| 2400                         | 2100                | 1749         | 2216         | 3398         | 4429         |
| 2500                         | 2200                | 1833         | 2321         | 3560         | 4640         |
| 2600                         | 2300                | 1916         | 2427         | 3721         | 4851         |
| 2700                         | 2400                | 1999         | 2532         | 3883         | 5062         |
| 2800                         | 2500                | 2083         | 2638         | 4045         | 5273         |
| 2900                         | 2600                | 2166         | 2743         | 4207         | 5483         |
| 3000                         | 2700                | 2249         | 2849         | 4369         | 5694         |

## Style 2 - Case Height: 770mm & 840mm Precision (E-Series) Outputs

Emitter Height: 578mm  
Cover Height: 770mm

| Emitter Type:<br>Case Depth: |                     | E11<br>103mm | E12<br>153mm | E22<br>176mm | E24<br>259mm |
|------------------------------|---------------------|--------------|--------------|--------------|--------------|
| Case Length (mm)             | Emitter Length (mm) | $\Delta T50$ | $\Delta T50$ | $\Delta T50$ | $\Delta T50$ |
| 700                          | 400                 | 372          | 468          | 717          | 925          |
| 800                          | 500                 | 466          | 585          | 897          | 1157         |
| 900                          | 600                 | 559          | 702          | 1076         | 1388         |
| 1000                         | 700                 | 652          | 819          | 1255         | 1619         |
| 1100                         | 800                 | 745          | 936          | 1434         | 1850         |
| 1200                         | 900                 | 838          | 1053         | 1614         | 2082         |
| 1300                         | 1000                | 931          | 1170         | 1793         | 2313         |
| 1400                         | 1100                | 1024         | 1287         | 1972         | 2544         |
| 1500                         | 1200                | 1117         | 1404         | 2152         | 2776         |
| 1600                         | 1300                | 1210         | 1521         | 2331         | 3007         |
| 1700                         | 1400                | 1303         | 1638         | 2510         | 3238         |
| 1800                         | 1500                | 1397         | 1755         | 2690         | 3470         |
| 1900                         | 1600                | 1490         | 1872         | 2869         | 3701         |
| 2000                         | 1700                | 1583         | 1989         | 3048         | 3932         |
| 2100                         | 1800                | 1676         | 2106         | 3227         | 4163         |
| 2200                         | 1900                | 1769         | 2223         | 3407         | 4395         |
| 2300                         | 2000                | 1862         | 2340         | 3586         | 4626         |
| 2400                         | 2100                | 1955         | 2457         | 3765         | 4857         |
| 2500                         | 2200                | 2048         | 2574         | 3945         | 5089         |
| 2600                         | 2300                | 2141         | 2691         | 4124         | 5320         |
| 2700                         | 2400                | 2234         | 2808         | 4303         | 5551         |
| 2800                         | 2500                | 2328         | 2925         | 4483         | 5783         |
| 2900                         | 2600                | 2421         | 3042         | 4662         | 6014         |
| 3000                         | 2700                | 2514         | 3159         | 4841         | 6245         |

Emitter Height: 650mm  
Cover Height: 840mm

| Emitter Type:<br>Case Depth: |                     | E11<br>103mm | E12<br>153mm | E22<br>176mm | E24<br>259mm |
|------------------------------|---------------------|--------------|--------------|--------------|--------------|
| Case Length (mm)             | Emitter Length (mm) | $\Delta T50$ | $\Delta T50$ | $\Delta T50$ | $\Delta T50$ |
| 700                          | 400                 | 410          | 514          | 784          | 999          |
| 800                          | 500                 | 512          | 643          | 980          | 1249         |
| 900                          | 600                 | 614          | 772          | 1176         | 1499         |
| 1000                         | 700                 | 717          | 900          | 1372         | 1749         |
| 1100                         | 800                 | 819          | 1029         | 1568         | 1998         |
| 1200                         | 900                 | 922          | 1157         | 1764         | 2248         |
| 1300                         | 1000                | 1024         | 1286         | 1960         | 2498         |
| 1400                         | 1100                | 1126         | 1415         | 2156         | 2748         |
| 1500                         | 1200                | 1229         | 1543         | 2352         | 2998         |
| 1600                         | 1300                | 1331         | 1672         | 2548         | 3247         |
| 1700                         | 1400                | 1434         | 1800         | 2744         | 3497         |
| 1800                         | 1500                | 1536         | 1929         | 2940         | 3747         |
| 1900                         | 1600                | 1638         | 2058         | 3136         | 3997         |
| 2000                         | 1700                | 1741         | 2186         | 3332         | 4247         |
| 2100                         | 1800                | 1843         | 2315         | 3528         | 4496         |
| 2200                         | 1900                | 1946         | 2443         | 3724         | 4746         |
| 2300                         | 2000                | 2048         | 2572         | 3920         | 4996         |
| 2400                         | 2100                | 2150         | 2701         | 4116         | 5246         |
| 2500                         | 2200                | 2253         | 2829         | 4312         | 5496         |
| 2600                         | 2300                | 2355         | 2958         | 4508         | 5745         |
| 2700                         | 2400                | 2458         | 3086         | 4704         | 5995         |
| 2800                         | 2500                | 2560         | 3215         | 4900         | 6245         |
| 2900                         | 2600                | 2662         | 3344         | 5096         | 6495         |
| 3000                         | 2700                | 2765         | 3472         | 5292         | 6745         |

# Style 2 - Case Height: 910mm & 980mm

## Precision (E-Series) Outputs

Emitter Height: 723mm  
Cover Height: 910mm

| Emitter Type:<br>Case Depth: |                     | E11<br>103mm | E12<br>153mm | E22<br>176mm | E24<br>259mm |
|------------------------------|---------------------|--------------|--------------|--------------|--------------|
| Case Length (mm)             | Emitter Length (mm) | $\Delta T50$ | $\Delta T50$ | $\Delta T50$ | $\Delta T50$ |
| 700                          | 400                 | 446          | 561          | 850          | 1067         |
| 800                          | 500                 | 558          | 702          | 1062         | 1334         |
| 900                          | 600                 | 670          | 842          | 1274         | 1601         |
| 1000                         | 700                 | 781          | 982          | 1487         | 1868         |
| 1100                         | 800                 | 893          | 1122         | 1699         | 2134         |
| 1200                         | 900                 | 1004         | 1263         | 1912         | 2401         |
| 1300                         | 1000                | 1116         | 1403         | 2124         | 2668         |
| 1400                         | 1100                | 1228         | 1543         | 2336         | 2935         |
| 1500                         | 1200                | 1339         | 1684         | 2549         | 3202         |
| 1600                         | 1300                | 1451         | 1824         | 2761         | 3468         |
| 1700                         | 1400                | 1562         | 1964         | 2974         | 3735         |
| 1800                         | 1500                | 1674         | 2105         | 3186         | 4002         |
| 1900                         | 1600                | 1786         | 2245         | 3398         | 4269         |
| 2000                         | 1700                | 1897         | 2385         | 3611         | 4536         |
| 2100                         | 1800                | 2009         | 2525         | 3823         | 4802         |
| 2200                         | 1900                | 2120         | 2666         | 4036         | 5069         |
| 2300                         | 2000                | 2232         | 2806         | 4248         | 5336         |
| 2400                         | 2100                | 2344         | 2946         | 4460         | 5603         |
| 2500                         | 2200                | 2455         | 3087         | 4673         | 5870         |
| 2600                         | 2300                | 2567         | 3227         | 4885         | 6136         |
| 2700                         | 2400                | 2678         | 3367         | 5098         | 6403         |
| 2800                         | 2500                | 2790         | 3508         | 5310         | 6670         |
| 2900                         | 2600                | 2902         | 3648         | 5522         | 6937         |
| 3000                         | 2700                | 3013         | 3788         | 5735         | 7204         |

Emitter Height: 795mm  
Cover Height: 980mm

| Emitter Type:<br>Case Depth: |                     | E11<br>103mm | E12<br>153mm | E22<br>176mm | E24<br>259mm |
|------------------------------|---------------------|--------------|--------------|--------------|--------------|
| Case Length (mm)             | Emitter Length (mm) | $\Delta T50$ | $\Delta T50$ | $\Delta T50$ | $\Delta T50$ |
| 700                          | 400                 | 482          | 609          | 912          | 1128         |
| 800                          | 500                 | 602          | 761          | 1141         | 1410         |
| 900                          | 600                 | 722          | 913          | 1369         | 1691         |
| 1000                         | 700                 | 843          | 1065         | 1597         | 1973         |
| 1100                         | 800                 | 963          | 1218         | 1825         | 2255         |
| 1200                         | 900                 | 1084         | 1370         | 2053         | 2537         |
| 1300                         | 1000                | 1204         | 1522         | 2281         | 2819         |
| 1400                         | 1100                | 1324         | 1674         | 2509         | 3101         |
| 1500                         | 1200                | 1445         | 1826         | 2737         | 3383         |
| 1600                         | 1300                | 1565         | 1979         | 2965         | 3665         |
| 1700                         | 1400                | 1686         | 2131         | 3193         | 3947         |
| 1800                         | 1500                | 1806         | 2283         | 3422         | 4229         |
| 1900                         | 1600                | 1926         | 2435         | 3650         | 4510         |
| 2000                         | 1700                | 2047         | 2587         | 3878         | 4792         |
| 2100                         | 1800                | 2167         | 2740         | 4106         | 5074         |
| 2200                         | 1900                | 2288         | 2892         | 4334         | 5356         |
| 2300                         | 2000                | 2408         | 3044         | 4562         | 5638         |
| 2400                         | 2100                | 2528         | 3196         | 4790         | 5920         |
| 2500                         | 2200                | 2649         | 3348         | 5018         | 6202         |
| 2600                         | 2300                | 2769         | 3501         | 5246         | 6484         |
| 2700                         | 2400                | 2890         | 3653         | 5474         | 6766         |
| 2800                         | 2500                | 3010         | 3805         | 5703         | 7048         |
| 2900                         | 2600                | 3130         | 3957         | 5931         | 7329         |
| 3000                         | 2700                | 3251         | 4109         | 6159         | 7611         |

# Style 3 - Case Height: 420mm & 490mm

## Precision (E-Series) Outputs

Emitter Height: 215mm  
Cover Height: 420mm

| Emitter Type:<br>Case Depth: |                     | E11<br>103mm | E12<br>153mm | E22<br>176mm | E24<br>259mm |
|------------------------------|---------------------|--------------|--------------|--------------|--------------|
| Case Length (mm)             | Emitter Length (mm) | $\Delta T50$ | $\Delta T50$ | $\Delta T50$ | $\Delta T50$ |
| 700                          | 400                 | 145          | 204          | 335          | 439          |
| 800                          | 500                 | 182          | 256          | 419          | 549          |
| 900                          | 600                 | 218          | 307          | 503          | 658          |
| 1000                         | 700                 | 254          | 358          | 587          | 768          |
| 1100                         | 800                 | 290          | 409          | 670          | 878          |
| 1200                         | 900                 | 327          | 460          | 754          | 987          |
| 1300                         | 1000                | 363          | 511          | 838          | 1097         |
| 1400                         | 1100                | 399          | 562          | 922          | 1207         |
| 1500                         | 1200                | 436          | 613          | 1006         | 1316         |
| 1600                         | 1300                | 472          | 664          | 1089         | 1426         |
| 1700                         | 1400                | 508          | 715          | 1173         | 1536         |
| 1800                         | 1500                | 545          | 767          | 1257         | 1646         |
| 1900                         | 1600                | 581          | 818          | 1341         | 1755         |
| 2000                         | 1700                | 617          | 869          | 1425         | 1865         |
| 2100                         | 1800                | 653          | 920          | 1508         | 1975         |
| 2200                         | 1900                | 690          | 971          | 1592         | 2084         |
| 2300                         | 2000                | 726          | 1022         | 1676         | 2194         |
| 2400                         | 2100                | 762          | 1073         | 1760         | 2304         |
| 2500                         | 2200                | 799          | 1124         | 1844         | 2413         |
| 2600                         | 2300                | 835          | 1175         | 1927         | 2523         |
| 2700                         | 2400                | 871          | 1226         | 2011         | 2633         |
| 2800                         | 2500                | 908          | 1278         | 2095         | 2743         |
| 2900                         | 2600                | 944          | 1329         | 2179         | 2852         |
| 3000                         | 2700                | 980          | 1380         | 2263         | 2962         |

Emitter Height: 288mm  
Cover Height: 490mm

| Emitter Type:<br>Case Depth: |                     | E11<br>103mm | E12<br>153mm | E22<br>176mm | E24<br>259mm |
|------------------------------|---------------------|--------------|--------------|--------------|--------------|
| Case Length (mm)             | Emitter Length (mm) | $\Delta T50$ | $\Delta T50$ | $\Delta T50$ | $\Delta T50$ |
| 700                          | 400                 | 192          | 264          | 420          | 550          |
| 800                          | 500                 | 240          | 330          | 526          | 688          |
| 900                          | 600                 | 287          | 396          | 631          | 825          |
| 1000                         | 700                 | 335          | 462          | 736          | 963          |
| 1100                         | 800                 | 383          | 528          | 841          | 1100         |
| 1200                         | 900                 | 431          | 594          | 946          | 1238         |
| 1300                         | 1000                | 479          | 660          | 1051         | 1375         |
| 1400                         | 1100                | 527          | 726          | 1156         | 1513         |
| 1500                         | 1200                | 575          | 792          | 1261         | 1650         |
| 1600                         | 1300                | 623          | 858          | 1366         | 1788         |
| 1700                         | 1400                | 671          | 924          | 1471         | 1925         |
| 1800                         | 1500                | 719          | 990          | 1577         | 2063         |
| 1900                         | 1600                | 766          | 1056         | 1682         | 2200         |
| 2000                         | 1700                | 814          | 1122         | 1787         | 2338         |
| 2100                         | 1800                | 862          | 1188         | 1892         | 2475         |
| 2200                         | 1900                | 910          | 1254         | 1997         | 2613         |
| 2300                         | 2000                | 958          | 1320         | 2102         | 2750         |
| 2400                         | 2100                | 1006         | 1386         | 2207         | 2888         |
| 2500                         | 2200                | 1054         | 1452         | 2312         | 3025         |
| 2600                         | 2300                | 1102         | 1518         | 2417         | 3163         |
| 2700                         | 2400                | 1150         | 1584         | 2522         | 3300         |
| 2800                         | 2500                | 1198         | 1650         | 2628         | 3438         |
| 2900                         | 2600                | 1245         | 1716         | 2733         | 3575         |
| 3000                         | 2700                | 1293         | 1782         | 2838         | 3713         |

Other cover heights are available to suits building parameters. Please contact your sales consultant.



# Style 3 - Case Height: 560mm & 630mm

## Precision (E-Series) Outputs

Emitter Height: 360mm  
Cover Height: 560mm

| Emitter Type:<br>Case Depth: |                     | E11<br>103mm | E12<br>153mm | E22<br>176mm | E24<br>259mm |
|------------------------------|---------------------|--------------|--------------|--------------|--------------|
| Case Length (mm)             | Emitter Length (mm) | $\Delta T50$ | $\Delta T50$ | $\Delta T50$ | $\Delta T50$ |
| 700                          | 400                 | 252          | 332          | 499          | 664          |
| 800                          | 500                 | 315          | 416          | 624          | 831          |
| 900                          | 600                 | 378          | 499          | 749          | 997          |
| 1000                         | 700                 | 441          | 582          | 874          | 1163         |
| 1100                         | 800                 | 504          | 665          | 998          | 1329         |
| 1200                         | 900                 | 567          | 748          | 1123         | 1495         |
| 1300                         | 1000                | 630          | 831          | 1248         | 1661         |
| 1400                         | 1100                | 693          | 914          | 1373         | 1827         |
| 1500                         | 1200                | 756          | 997          | 1498         | 1993         |
| 1600                         | 1300                | 819          | 1080         | 1622         | 2159         |
| 1700                         | 1400                | 882          | 1163         | 1747         | 2325         |
| 1800                         | 1500                | 945          | 1247         | 1872         | 2492         |
| 1900                         | 1600                | 1008         | 1330         | 1997         | 2658         |
| 2000                         | 1700                | 1071         | 1413         | 2122         | 2824         |
| 2100                         | 1800                | 1134         | 1496         | 2246         | 2990         |
| 2200                         | 1900                | 1197         | 1579         | 2371         | 3156         |
| 2300                         | 2000                | 1260         | 1662         | 2496         | 3322         |
| 2400                         | 2100                | 1323         | 1745         | 2621         | 3488         |
| 2500                         | 2200                | 1386         | 1828         | 2746         | 3654         |
| 2600                         | 2300                | 1449         | 1911         | 2870         | 3820         |
| 2700                         | 2400                | 1512         | 1994         | 2995         | 3986         |
| 2800                         | 2500                | 1575         | 2078         | 3120         | 4153         |
| 2900                         | 2600                | 1638         | 2161         | 3245         | 4319         |
| 3000                         | 2700                | 1701         | 2244         | 3370         | 4485         |

Emitter Height: 433mm  
Cover Height: 630mm

| Emitter Type:<br>Case Depth: |                     | E11<br>103mm | E12<br>153mm | E22<br>176mm | E24<br>kmm   |
|------------------------------|---------------------|--------------|--------------|--------------|--------------|
| Case Length (mm)             | Emitter Length (mm) | $\Delta T50$ | $\Delta T50$ | $\Delta T50$ | $\Delta T50$ |
| 700                          | 400                 | 294          | 378          | 575          | 758          |
| 800                          | 500                 | 367          | 472          | 719          | 948          |
| 900                          | 600                 | 440          | 566          | 863          | 1137         |
| 1000                         | 700                 | 514          | 661          | 1007         | 1327         |
| 1100                         | 800                 | 587          | 755          | 1150         | 1516         |
| 1200                         | 900                 | 661          | 850          | 1294         | 1706         |
| 1300                         | 1000                | 734          | 944          | 1438         | 1895         |
| 1400                         | 1100                | 807          | 1038         | 1582         | 2085         |
| 1500                         | 1200                | 881          | 1133         | 1726         | 2274         |
| 1600                         | 1300                | 954          | 1227         | 1869         | 2464         |
| 1700                         | 1400                | 1028         | 1322         | 2013         | 2653         |
| 1800                         | 1500                | 1101         | 1416         | 2157         | 2843         |
| 1900                         | 1600                | 1174         | 1510         | 2301         | 3032         |
| 2000                         | 1700                | 1248         | 1605         | 2445         | 3222         |
| 2100                         | 1800                | 1321         | 1699         | 2588         | 3411         |
| 2200                         | 1900                | 1395         | 1794         | 2732         | 3601         |
| 2300                         | 2000                | 1468         | 1888         | 2876         | 3790         |
| 2400                         | 2100                | 1541         | 1982         | 3020         | 3980         |
| 2500                         | 2200                | 1615         | 2077         | 3164         | 4169         |
| 2600                         | 2300                | 1688         | 2171         | 3307         | 4359         |
| 2700                         | 2400                | 1762         | 2266         | 3451         | 4548         |
| 2800                         | 2500                | 1835         | 2360         | 3595         | 4738         |
| 2900                         | 2600                | 1908         | 2454         | 3739         | 4927         |
| 3000                         | 2700                | 1982         | 2549         | 3883         | 5117         |

Other cover heights are available to suits building parameters. Please contact your sales consultant.

# Style 3 - Case Height: 700mm & 770mm

## Precision (E-Series) Outputs

Emitter Height: 578mm  
Cover Height: 700mm

| Emitter Type:<br>Case Depth: |                     | E11<br>103mm | E12<br>153mm | E22<br>176mm | E24<br>259mm |
|------------------------------|---------------------|--------------|--------------|--------------|--------------|
| Case Length (mm)             | Emitter Length (mm) | $\Delta T50$ | $\Delta T50$ | $\Delta T50$ | $\Delta T50$ |
| 700                          | 400                 | 333          | 422          | 647          | 844          |
| 800                          | 500                 | 417          | 528          | 809          | 1055         |
| 900                          | 600                 | 500          | 633          | 971          | 1265         |
| 1000                         | 700                 | 583          | 739          | 1133         | 1476         |
| 1100                         | 800                 | 666          | 844          | 1294         | 1687         |
| 1200                         | 900                 | 750          | 950          | 1456         | 1898         |
| 1300                         | 1000                | 833          | 1055         | 1618         | 2109         |
| 1400                         | 1100                | 916          | 1161         | 1780         | 2320         |
| 1500                         | 1200                | 1000         | 1266         | 1942         | 2531         |
| 1600                         | 1300                | 1083         | 1372         | 2103         | 2742         |
| 1700                         | 1400                | 1166         | 1477         | 2265         | 2953         |
| 1800                         | 1500                | 1250         | 1583         | 2427         | 3164         |
| 1900                         | 1600                | 1333         | 1688         | 2589         | 3374         |
| 2000                         | 1700                | 1416         | 1794         | 2751         | 3585         |
| 2100                         | 1800                | 1499         | 1899         | 2912         | 3796         |
| 2200                         | 1900                | 1583         | 2005         | 3074         | 4007         |
| 2300                         | 2000                | 1666         | 2110         | 3236         | 4218         |
| 2400                         | 2100                | 1749         | 2216         | 3398         | 4429         |
| 2500                         | 2200                | 1833         | 2321         | 3560         | 4640         |
| 2600                         | 2300                | 1916         | 2427         | 3721         | 4851         |
| 2700                         | 2400                | 1999         | 2532         | 3883         | 5062         |
| 2800                         | 2500                | 2083         | 2638         | 4045         | 5273         |
| 2900                         | 2600                | 2166         | 2743         | 4207         | 5483         |
| 3000                         | 2700                | 2249         | 2849         | 4369         | 5694         |

Emitter Height: 578mm  
Cover Height: 770mm

| Emitter Type:<br>Case Depth: |                     | E11<br>103mm | E12<br>153mm | E22<br>176mm | E24<br>259mm |
|------------------------------|---------------------|--------------|--------------|--------------|--------------|
| Case Length (mm)             | Emitter Length (mm) | $\Delta T50$ | $\Delta T50$ | $\Delta T50$ | $\Delta T50$ |
| 700                          | 400                 | 372          | 468          | 717          | 925          |
| 800                          | 500                 | 466          | 585          | 897          | 1157         |
| 900                          | 600                 | 559          | 702          | 1076         | 1388         |
| 1000                         | 700                 | 652          | 819          | 1255         | 1619         |
| 1100                         | 800                 | 745          | 936          | 1434         | 1850         |
| 1200                         | 900                 | 838          | 1053         | 1614         | 2082         |
| 1300                         | 1000                | 931          | 1170         | 1793         | 2313         |
| 1400                         | 1100                | 1024         | 1287         | 1972         | 2544         |
| 1500                         | 1200                | 1117         | 1404         | 2152         | 2776         |
| 1600                         | 1300                | 1210         | 1521         | 2331         | 3007         |
| 1700                         | 1400                | 1303         | 1638         | 2510         | 3238         |
| 1800                         | 1500                | 1397         | 1755         | 2690         | 3470         |
| 1900                         | 1600                | 1490         | 1872         | 2869         | 3701         |
| 2000                         | 1700                | 1583         | 1989         | 3048         | 3932         |
| 2100                         | 1800                | 1676         | 2106         | 3227         | 4163         |
| 2200                         | 1900                | 1769         | 2223         | 3407         | 4395         |
| 2300                         | 2000                | 1862         | 2340         | 3586         | 4626         |
| 2400                         | 2100                | 1955         | 2457         | 3765         | 4857         |
| 2500                         | 2200                | 2048         | 2574         | 3945         | 5089         |
| 2600                         | 2300                | 2141         | 2691         | 4124         | 5320         |
| 2700                         | 2400                | 2234         | 2808         | 4303         | 5551         |
| 2800                         | 2500                | 2328         | 2925         | 4483         | 5783         |
| 2900                         | 2600                | 2421         | 3042         | 4662         | 6014         |
| 3000                         | 2700                | 2514         | 3159         | 4841         | 6245         |

Other cover heights are available to suits building parameters. Please contact your sales consultant.

# Style 3 - Case Height: 840mm & 910mm

## Precision (E-Series) Outputs

Emitter Height: 650mm  
Cover Height: 840mm

| Emitter Type:<br>Case Depth: |                     | E11<br>103mm | E12<br>153mm | E22<br>176mm | E24<br>259mm |
|------------------------------|---------------------|--------------|--------------|--------------|--------------|
| Case Length (mm)             | Emitter Length (mm) | $\Delta T50$ | $\Delta T50$ | $\Delta T50$ | $\Delta T50$ |
| 700                          | 400                 | 410          | 514          | 784          | 999          |
| 800                          | 500                 | 512          | 643          | 980          | 1249         |
| 900                          | 600                 | 614          | 772          | 1176         | 1499         |
| 1000                         | 700                 | 717          | 900          | 1372         | 1749         |
| 1100                         | 800                 | 819          | 1029         | 1568         | 1998         |
| 1200                         | 900                 | 922          | 1157         | 1764         | 2248         |
| 1300                         | 1000                | 1024         | 1286         | 1960         | 2498         |
| 1400                         | 1100                | 1126         | 1415         | 2156         | 2748         |
| 1500                         | 1200                | 1229         | 1543         | 2352         | 2998         |
| 1600                         | 1300                | 1331         | 1672         | 2548         | 3247         |
| 1700                         | 1400                | 1434         | 1800         | 2744         | 3497         |
| 1800                         | 1500                | 1536         | 1929         | 2940         | 3747         |
| 1900                         | 1600                | 1638         | 2058         | 3136         | 3997         |
| 2000                         | 1700                | 1741         | 2186         | 3332         | 4247         |
| 2100                         | 1800                | 1843         | 2315         | 3528         | 4496         |
| 2200                         | 1900                | 1946         | 2443         | 3724         | 4746         |
| 2300                         | 2000                | 2048         | 2572         | 3920         | 4996         |
| 2400                         | 2100                | 2150         | 2701         | 4116         | 5246         |
| 2500                         | 2200                | 2253         | 2829         | 4312         | 5496         |
| 2600                         | 2300                | 2355         | 2958         | 4508         | 5745         |
| 2700                         | 2400                | 2458         | 3086         | 4704         | 5995         |
| 2800                         | 2500                | 2560         | 3215         | 4900         | 6245         |
| 2900                         | 2600                | 2662         | 3344         | 5096         | 6495         |
| 3000                         | 2700                | 2765         | 3472         | 5292         | 6745         |

Emitter Height: 723mm  
Cover Height: 910mm

| Emitter Type:<br>Case Depth: |                     | E11<br>103mm | E12<br>153mm | E22<br>176mm | E24<br>259mm |
|------------------------------|---------------------|--------------|--------------|--------------|--------------|
| Case Length (mm)             | Emitter Length (mm) | $\Delta T50$ | $\Delta T50$ | $\Delta T50$ | $\Delta T50$ |
| 700                          | 400                 | 446          | 561          | 850          | 1067         |
| 800                          | 500                 | 558          | 702          | 1062         | 1334         |
| 900                          | 600                 | 670          | 842          | 1274         | 1601         |
| 1000                         | 700                 | 781          | 982          | 1487         | 1868         |
| 1100                         | 800                 | 893          | 1122         | 1699         | 2134         |
| 1200                         | 900                 | 1004         | 1263         | 1912         | 2401         |
| 1300                         | 1000                | 1116         | 1403         | 2124         | 2668         |
| 1400                         | 1100                | 1228         | 1543         | 2336         | 2935         |
| 1500                         | 1200                | 1339         | 1684         | 2549         | 3202         |
| 1600                         | 1300                | 1451         | 1824         | 2761         | 3468         |
| 1700                         | 1400                | 1562         | 1964         | 2974         | 3735         |
| 1800                         | 1500                | 1674         | 2105         | 3186         | 4002         |
| 1900                         | 1600                | 1786         | 2245         | 3398         | 4269         |
| 2000                         | 1700                | 1897         | 2385         | 3611         | 4536         |
| 2100                         | 1800                | 2009         | 2525         | 3823         | 4802         |
| 2200                         | 1900                | 2120         | 2666         | 4036         | 5069         |
| 2300                         | 2000                | 2232         | 2806         | 4248         | 5336         |
| 2400                         | 2100                | 2344         | 2946         | 4460         | 5603         |
| 2500                         | 2200                | 2455         | 3087         | 4673         | 5870         |
| 2600                         | 2300                | 2567         | 3227         | 4885         | 6136         |
| 2700                         | 2400                | 2678         | 3367         | 5098         | 6403         |
| 2800                         | 2500                | 2790         | 3508         | 5310         | 6670         |
| 2900                         | 2600                | 2902         | 3648         | 5522         | 6937         |
| 3000                         | 2700                | 3013         | 3788         | 5735         | 7204         |

Other cover heights are available to suits building parameters. Please contact your sales consultant.

# Style 3 - Case Height: 980mm

## Precision (E-Series) Outputs

Emitter Height: 795mm  
Height: 980mm

| Emitter Type:<br>Case Depth: |                     | E11<br>103mm | E12<br>153mm | E22<br>176mm | E24<br>259mm |
|------------------------------|---------------------|--------------|--------------|--------------|--------------|
| Case Length (mm)             | Emitter Length (mm) | $\Delta T50$ | $\Delta T50$ | $\Delta T50$ | $\Delta T50$ |
| 700                          | 400                 | 482          | 609          | 912          | 1128         |
| 800                          | 500                 | 602          | 761          | 1141         | 1410         |
| 900                          | 600                 | 722          | 913          | 1369         | 1691         |
| 1000                         | 700                 | 843          | 1065         | 1597         | 1973         |
| 1100                         | 800                 | 963          | 1218         | 1825         | 2255         |
| 1200                         | 900                 | 1084         | 1370         | 2053         | 2537         |
| 1300                         | 1000                | 1204         | 1522         | 2281         | 2819         |
| 1400                         | 1100                | 1324         | 1674         | 2509         | 3101         |
| 1500                         | 1200                | 1445         | 1826         | 2737         | 3383         |
| 1600                         | 1300                | 1565         | 1979         | 2965         | 3665         |
| 1700                         | 1400                | 1686         | 2131         | 3193         | 3947         |
| 1800                         | 1500                | 1806         | 2283         | 3422         | 4229         |
| 1900                         | 1600                | 1926         | 2435         | 3650         | 4510         |
| 2000                         | 1700                | 2047         | 2587         | 3878         | 4792         |
| 2100                         | 1800                | 2167         | 2740         | 4106         | 5074         |
| 2200                         | 1900                | 2288         | 2892         | 4334         | 5356         |
| 2300                         | 2000                | 2408         | 3044         | 4562         | 5638         |
| 2400                         | 2100                | 2528         | 3196         | 4790         | 5920         |
| 2500                         | 2200                | 2649         | 3348         | 5018         | 6202         |
| 2600                         | 2300                | 2769         | 3501         | 5246         | 6484         |
| 2700                         | 2400                | 2890         | 3653         | 5474         | 6766         |
| 2800                         | 2500                | 3010         | 3805         | 5703         | 7048         |
| 2900                         | 2600                | 3130         | 3957         | 5931         | 7329         |
| 3000                         | 2700                | 3251         | 4109         | 6159         | 7611         |

Other cover heights are available to suits building parameters. Please contact your sales consultant.

# Style 4 - Case Height: 490mm & 560mm

## Precision (E-Series) Outputs

Emitter Height: 215mm

Cover Height: 490mm

| Emitter Type:<br>Case Depth: |                     | E11<br>103mm | E12<br>153mm | E22<br>176mm | E24<br>259mm |
|------------------------------|---------------------|--------------|--------------|--------------|--------------|
| Case Length (mm)             | Emitter Length (mm) | $\Delta T50$ | $\Delta T50$ | $\Delta T50$ | $\Delta T50$ |
| 700                          | 400                 | 145          | 204          | 335          | 439          |
| 800                          | 500                 | 182          | 256          | 419          | 549          |
| 900                          | 600                 | 218          | 307          | 503          | 658          |
| 1000                         | 700                 | 254          | 358          | 587          | 768          |
| 1100                         | 800                 | 290          | 409          | 670          | 878          |
| 1200                         | 900                 | 327          | 460          | 754          | 987          |
| 1300                         | 1000                | 363          | 511          | 838          | 1097         |
| 1400                         | 1100                | 399          | 562          | 922          | 1207         |
| 1500                         | 1200                | 436          | 613          | 1006         | 1316         |
| 1600                         | 1300                | 472          | 664          | 1089         | 1426         |
| 1700                         | 1400                | 508          | 715          | 1173         | 1536         |
| 1800                         | 1500                | 545          | 767          | 1257         | 1646         |
| 1900                         | 1600                | 581          | 818          | 1341         | 1755         |
| 2000                         | 1700                | 617          | 869          | 1425         | 1865         |
| 2100                         | 1800                | 653          | 920          | 1508         | 1975         |
| 2200                         | 1900                | 690          | 971          | 1592         | 2084         |
| 2300                         | 2000                | 726          | 1022         | 1676         | 2194         |
| 2400                         | 2100                | 762          | 1073         | 1760         | 2304         |
| 2500                         | 2200                | 799          | 1124         | 1844         | 2413         |
| 2600                         | 2300                | 835          | 1175         | 1927         | 2523         |
| 2700                         | 2400                | 871          | 1226         | 2011         | 2633         |
| 2800                         | 2500                | 908          | 1278         | 2095         | 2743         |
| 2900                         | 2600                | 944          | 1329         | 2179         | 2852         |
| 3000                         | 2700                | 980          | 1380         | 2263         | 2962         |

Emitter Height: 288mm

Cover Height: 560mm

| Emitter Type:<br>Case Depth: |                     | E11<br>103mm | E12<br>153mm | E22<br>176mm | E24<br>259mm |
|------------------------------|---------------------|--------------|--------------|--------------|--------------|
| Case Length (mm)             | Emitter Length (mm) | $\Delta T50$ | $\Delta T50$ | $\Delta T50$ | $\Delta T50$ |
| 700                          | 400                 | 192          | 264          | 420          | 550          |
| 800                          | 500                 | 240          | 330          | 526          | 688          |
| 900                          | 600                 | 287          | 396          | 631          | 825          |
| 1000                         | 700                 | 335          | 462          | 736          | 963          |
| 1100                         | 800                 | 383          | 528          | 841          | 1100         |
| 1200                         | 900                 | 431          | 594          | 946          | 1238         |
| 1300                         | 1000                | 479          | 660          | 1051         | 1375         |
| 1400                         | 1100                | 527          | 726          | 1156         | 1513         |
| 1500                         | 1200                | 575          | 792          | 1261         | 1650         |
| 1600                         | 1300                | 623          | 858          | 1366         | 1788         |
| 1700                         | 1400                | 671          | 924          | 1471         | 1925         |
| 1800                         | 1500                | 719          | 990          | 1577         | 2063         |
| 1900                         | 1600                | 766          | 1056         | 1682         | 2200         |
| 2000                         | 1700                | 814          | 1122         | 1787         | 2338         |
| 2100                         | 1800                | 862          | 1188         | 1892         | 2475         |
| 2200                         | 1900                | 910          | 1254         | 1997         | 2613         |
| 2300                         | 2000                | 958          | 1320         | 2102         | 2750         |
| 2400                         | 2100                | 1006         | 1386         | 2207         | 2888         |
| 2500                         | 2200                | 1054         | 1452         | 2312         | 3025         |
| 2600                         | 2300                | 1102         | 1518         | 2417         | 3163         |
| 2700                         | 2400                | 1150         | 1584         | 2522         | 3300         |
| 2800                         | 2500                | 1198         | 1650         | 2628         | 3438         |
| 2900                         | 2600                | 1245         | 1716         | 2733         | 3575         |
| 3000                         | 2700                | 1293         | 1782         | 2838         | 3713         |

Other cover heights are available to suits building parameters. Please contact your sales consultant.

# Style 4 - Case Height: 630mm & 700mm

## Precision (E-Series) Outputs

Emitter Height: 360mm

Cover Height: 630mm

| Emitter Type:<br>Case Depth: |                     | E11<br>103mm | E12<br>153mm | E22<br>176mm | E24<br>259mm |
|------------------------------|---------------------|--------------|--------------|--------------|--------------|
| Case Length (mm)             | Emitter Length (mm) | $\Delta T50$ | $\Delta T50$ | $\Delta T50$ | $\Delta T50$ |
| 700                          | 400                 | 252          | 332          | 499          | 664          |
| 800                          | 500                 | 315          | 416          | 624          | 831          |
| 900                          | 600                 | 378          | 499          | 749          | 997          |
| 1000                         | 700                 | 441          | 582          | 874          | 1163         |
| 1100                         | 800                 | 504          | 665          | 998          | 1329         |
| 1200                         | 900                 | 567          | 748          | 1123         | 1495         |
| 1300                         | 1000                | 630          | 831          | 1248         | 1661         |
| 1400                         | 1100                | 693          | 914          | 1373         | 1827         |
| 1500                         | 1200                | 756          | 997          | 1498         | 1993         |
| 1600                         | 1300                | 819          | 1080         | 1622         | 2159         |
| 1700                         | 1400                | 882          | 1163         | 1747         | 2325         |
| 1800                         | 1500                | 945          | 1247         | 1872         | 2492         |
| 1900                         | 1600                | 1008         | 1330         | 1997         | 2658         |
| 2000                         | 1700                | 1071         | 1413         | 2122         | 2824         |
| 2100                         | 1800                | 1134         | 1496         | 2246         | 2990         |
| 2200                         | 1900                | 1197         | 1579         | 2371         | 3156         |
| 2300                         | 2000                | 1260         | 1662         | 2496         | 3322         |
| 2400                         | 2100                | 1323         | 1745         | 2621         | 3488         |
| 2500                         | 2200                | 1386         | 1828         | 2746         | 3654         |
| 2600                         | 2300                | 1449         | 1911         | 2870         | 3820         |
| 2700                         | 2400                | 1512         | 1994         | 2995         | 3986         |
| 2800                         | 2500                | 1575         | 2078         | 3120         | 4153         |
| 2900                         | 2600                | 1638         | 2161         | 3245         | 4319         |
| 3000                         | 2700                | 1701         | 2244         | 3370         | 4485         |

Emitter Height: 433mm

Cover Height: 700mm

| Emitter Type:<br>Case Depth: |                     | E11<br>103mm | E12<br>153mm | E22<br>176mm | E24<br>259mm |
|------------------------------|---------------------|--------------|--------------|--------------|--------------|
| Case Length (mm)             | Emitter Length (mm) | $\Delta T50$ | $\Delta T50$ | $\Delta T50$ | $\Delta T50$ |
| 700                          | 400                 | 294          | 378          | 575          | 758          |
| 800                          | 500                 | 367          | 472          | 719          | 948          |
| 900                          | 600                 | 440          | 566          | 863          | 1137         |
| 1000                         | 700                 | 514          | 661          | 1007         | 1327         |
| 1100                         | 800                 | 587          | 755          | 1150         | 1516         |
| 1200                         | 900                 | 661          | 850          | 1294         | 1706         |
| 1300                         | 1000                | 734          | 944          | 1438         | 1895         |
| 1400                         | 1100                | 807          | 1038         | 1582         | 2085         |
| 1500                         | 1200                | 881          | 1133         | 1726         | 2274         |
| 1600                         | 1300                | 954          | 1227         | 1869         | 2464         |
| 1700                         | 1400                | 1028         | 1322         | 2013         | 2653         |
| 1800                         | 1500                | 1101         | 1416         | 2157         | 2843         |
| 1900                         | 1600                | 1174         | 1510         | 2301         | 3032         |
| 2000                         | 1700                | 1248         | 1605         | 2445         | 3222         |
| 2100                         | 1800                | 1321         | 1699         | 2588         | 3411         |
| 2200                         | 1900                | 1395         | 1794         | 2732         | 3601         |
| 2300                         | 2000                | 1468         | 1888         | 2876         | 3790         |
| 2400                         | 2100                | 1541         | 1982         | 3020         | 3980         |
| 2500                         | 2200                | 1615         | 2077         | 3164         | 4169         |
| 2600                         | 2300                | 1688         | 2171         | 3307         | 4359         |
| 2700                         | 2400                | 1762         | 2266         | 3451         | 4548         |
| 2800                         | 2500                | 1835         | 2360         | 3595         | 4738         |
| 2900                         | 2600                | 1908         | 2454         | 3739         | 4927         |
| 3000                         | 2700                | 1982         | 2549         | 3883         | 5117         |

Other cover heights are available to suits building parameters. Please contact your sales consultant.

# Style 4 - Case Height: 770mm & 840mm

## Precision (E-Series) Outputs

Emitter Height: 505mm

Cover Height: 770mm

| Emitter Type:<br>Case Depth: |                     | E11<br>103mm | E12<br>153mm | E22<br>176mm | E24<br>259mm |
|------------------------------|---------------------|--------------|--------------|--------------|--------------|
| Case Length (mm)             | Emitter Length (mm) | $\Delta T50$ | $\Delta T50$ | $\Delta T50$ | $\Delta T50$ |
| 700                          | 400                 | 333          | 422          | 647          | 844          |
| 800                          | 500                 | 417          | 528          | 809          | 1055         |
| 900                          | 600                 | 500          | 633          | 971          | 1265         |
| 1000                         | 700                 | 583          | 739          | 1133         | 1476         |
| 1100                         | 800                 | 666          | 844          | 1294         | 1687         |
| 1200                         | 900                 | 750          | 950          | 1456         | 1898         |
| 1300                         | 1000                | 833          | 1055         | 1618         | 2109         |
| 1400                         | 1100                | 916          | 1161         | 1780         | 2320         |
| 1500                         | 1200                | 1000         | 1266         | 1942         | 2531         |
| 1600                         | 1300                | 1083         | 1372         | 2103         | 2742         |
| 1700                         | 1400                | 1166         | 1477         | 2265         | 2953         |
| 1800                         | 1500                | 1250         | 1583         | 2427         | 3164         |
| 1900                         | 1600                | 1333         | 1688         | 2589         | 3374         |
| 2000                         | 1700                | 1416         | 1794         | 2751         | 3585         |
| 2100                         | 1800                | 1499         | 1899         | 2912         | 3796         |
| 2200                         | 1900                | 1583         | 2005         | 3074         | 4007         |
| 2300                         | 2000                | 1666         | 2110         | 3236         | 4218         |
| 2400                         | 2100                | 1749         | 2216         | 3398         | 4429         |
| 2500                         | 2200                | 1833         | 2321         | 3560         | 4640         |
| 2600                         | 2300                | 1916         | 2427         | 3721         | 4851         |
| 2700                         | 2400                | 1999         | 2532         | 3883         | 5062         |
| 2800                         | 2500                | 2083         | 2638         | 4045         | 5273         |
| 2900                         | 2600                | 2166         | 2743         | 4207         | 5483         |
| 3000                         | 2700                | 2249         | 2849         | 4369         | 5694         |

Emitter Height: 578mm

Cover Height: 840mm

| Emitter Type:<br>Case Depth: |                     | E11<br>103mm | E12<br>153mm | E22<br>176mm | E24<br>259mm |
|------------------------------|---------------------|--------------|--------------|--------------|--------------|
| Case Length (mm)             | Emitter Length (mm) | $\Delta T50$ | $\Delta T50$ | $\Delta T50$ | $\Delta T50$ |
| 700                          | 400                 | 372          | 468          | 717          | 925          |
| 800                          | 500                 | 466          | 585          | 897          | 1157         |
| 900                          | 600                 | 559          | 702          | 1076         | 1388         |
| 1000                         | 700                 | 652          | 819          | 1255         | 1619         |
| 1100                         | 800                 | 745          | 936          | 1434         | 1850         |
| 1200                         | 900                 | 838          | 1053         | 1614         | 2082         |
| 1300                         | 1000                | 931          | 1170         | 1793         | 2313         |
| 1400                         | 1100                | 1024         | 1287         | 1972         | 2544         |
| 1500                         | 1200                | 1117         | 1404         | 2152         | 2776         |
| 1600                         | 1300                | 1210         | 1521         | 2331         | 3007         |
| 1700                         | 1400                | 1303         | 1638         | 2510         | 3238         |
| 1800                         | 1500                | 1397         | 1755         | 2690         | 3470         |
| 1900                         | 1600                | 1490         | 1872         | 2869         | 3701         |
| 2000                         | 1700                | 1583         | 1989         | 3048         | 3932         |
| 2100                         | 1800                | 1676         | 2106         | 3227         | 4163         |
| 2200                         | 1900                | 1769         | 2223         | 3407         | 4395         |
| 2300                         | 2000                | 1862         | 2340         | 3586         | 4626         |
| 2400                         | 2100                | 1955         | 2457         | 3765         | 4857         |
| 2500                         | 2200                | 2048         | 2574         | 3945         | 5089         |
| 2600                         | 2300                | 2141         | 2691         | 4124         | 5320         |
| 2700                         | 2400                | 2234         | 2808         | 4303         | 5551         |
| 2800                         | 2500                | 2328         | 2925         | 4483         | 5783         |
| 2900                         | 2600                | 2421         | 3042         | 4662         | 6014         |
| 3000                         | 2700                | 2514         | 3159         | 4841         | 6245         |

Other cover heights are available to suits building parameters. Please contact your sales consultant.



# Style 4 - Case Height: 910mm & 980mm

## Precision (E-Series) Outputs

Emitter Height: 650mm  
Height: 910mm

| Emitter Type:<br>Case Depth: |                     | E11<br>103mm | E12<br>153mm | E22<br>176mm | E24<br>259mm |
|------------------------------|---------------------|--------------|--------------|--------------|--------------|
| Case Length (mm)             | Emitter Length (mm) | $\Delta T50$ | $\Delta T50$ | $\Delta T50$ | $\Delta T50$ |
| 700                          | 400                 | 410          | 514          | 784          | 999          |
| 800                          | 500                 | 512          | 643          | 980          | 1249         |
| 900                          | 600                 | 614          | 772          | 1176         | 1499         |
| 1000                         | 700                 | 717          | 900          | 1372         | 1749         |
| 1100                         | 800                 | 819          | 1029         | 1568         | 1998         |
| 1200                         | 900                 | 922          | 1157         | 1764         | 2248         |
| 1300                         | 1000                | 1024         | 1286         | 1960         | 2498         |
| 1400                         | 1100                | 1126         | 1415         | 2156         | 2748         |
| 1500                         | 1200                | 1229         | 1543         | 2352         | 2998         |
| 1600                         | 1300                | 1331         | 1672         | 2548         | 3247         |
| 1700                         | 1400                | 1434         | 1800         | 2744         | 3497         |
| 1800                         | 1500                | 1536         | 1929         | 2940         | 3747         |
| 1900                         | 1600                | 1638         | 2058         | 3136         | 3997         |
| 2000                         | 1700                | 1741         | 2186         | 3332         | 4247         |
| 2100                         | 1800                | 1843         | 2315         | 3528         | 4496         |
| 2200                         | 1900                | 1946         | 2443         | 3724         | 4746         |
| 2300                         | 2000                | 2048         | 2572         | 3920         | 4996         |
| 2400                         | 2100                | 2150         | 2701         | 4116         | 5246         |
| 2500                         | 2200                | 2253         | 2829         | 4312         | 5496         |
| 2600                         | 2300                | 2355         | 2958         | 4508         | 5745         |
| 2700                         | 2400                | 2458         | 3086         | 4704         | 5995         |
| 2800                         | 2500                | 2560         | 3215         | 4900         | 6245         |
| 2900                         | 2600                | 2662         | 3344         | 5096         | 6495         |
| 3000                         | 2700                | 2765         | 3472         | 5292         | 6745         |

Emitter Height: 723mm  
Cover Height: 980mm

| Emitter Type:<br>Case Depth: |                     | E11<br>103mm | E12<br>153mm | E22<br>176mm | E24<br>259mm |
|------------------------------|---------------------|--------------|--------------|--------------|--------------|
| Case Length (mm)             | Emitter Length (mm) | $\Delta T50$ | $\Delta T50$ | $\Delta T50$ | $\Delta T50$ |
| 700                          | 400                 | 446          | 561          | 850          | 1067         |
| 800                          | 500                 | 558          | 702          | 1062         | 1334         |
| 900                          | 600                 | 670          | 842          | 1274         | 1601         |
| 1000                         | 700                 | 781          | 982          | 1487         | 1868         |
| 1100                         | 800                 | 893          | 1122         | 1699         | 2134         |
| 1200                         | 900                 | 1004         | 1263         | 1912         | 2401         |
| 1300                         | 1000                | 1116         | 1403         | 2124         | 2668         |
| 1400                         | 1100                | 1228         | 1543         | 2336         | 2935         |
| 1500                         | 1200                | 1339         | 1684         | 2549         | 3202         |
| 1600                         | 1300                | 1451         | 1824         | 2761         | 3468         |
| 1700                         | 1400                | 1562         | 1964         | 2974         | 3735         |
| 1800                         | 1500                | 1674         | 2105         | 3186         | 4002         |
| 1900                         | 1600                | 1786         | 2245         | 3398         | 4269         |
| 2000                         | 1700                | 1897         | 2385         | 3611         | 4536         |
| 2100                         | 1800                | 2009         | 2525         | 3823         | 4802         |
| 2200                         | 1900                | 2120         | 2666         | 4036         | 5069         |
| 2300                         | 2000                | 2232         | 2806         | 4248         | 5336         |
| 2400                         | 2100                | 2344         | 2946         | 4460         | 5603         |
| 2500                         | 2200                | 2455         | 3087         | 4673         | 5870         |
| 2600                         | 2300                | 2567         | 3227         | 4885         | 6136         |
| 2700                         | 2400                | 2678         | 3367         | 5098         | 6403         |
| 2800                         | 2500                | 2790         | 3508         | 5310         | 6670         |
| 2900                         | 2600                | 2902         | 3648         | 5522         | 6937         |
| 3000                         | 2700                | 3013         | 3788         | 5735         | 7204         |

Other cover heights are available to suits building parameters. Please contact your sales consultant.

# Style 4 - Case Height: 1050mm

## Precision (E-Series) Outputs

Emitter Height: 795mm

Cover Height: 1050mm

| Emitter Type:<br>Case Depth: |                     | E11<br>103mm | E12<br>153mm | E22<br>176mm | E24<br>259mm |
|------------------------------|---------------------|--------------|--------------|--------------|--------------|
| Case Length (mm)             | Emitter Length (mm) | Δ            | Δ            | Δ            | Δ            |
| 700                          | 400                 | 482          | 609          | 912          | 1128         |
| 800                          | 500                 | 602          | 761          | 1141         | 1410         |
| 900                          | 600                 | 722          | 913          | 1369         | 1691         |
| 1000                         | 700                 | 843          | 1065         | 1597         | 1973         |
| 1100                         | 800                 | 963          | 1218         | 1825         | 2255         |
| 1200                         | 900                 | 1084         | 1370         | 2053         | 2537         |
| 1300                         | 1000                | 1204         | 1522         | 2281         | 2819         |
| 1400                         | 1100                | 1324         | 1674         | 2509         | 3101         |
| 1500                         | 1200                | 1445         | 1826         | 2737         | 3383         |
| 1600                         | 1300                | 1565         | 1979         | 2965         | 3665         |
| 1700                         | 1400                | 1686         | 2131         | 3193         | 3947         |
| 1800                         | 1500                | 1806         | 2283         | 3422         | 4229         |
| 1900                         | 1600                | 1926         | 2435         | 3650         | 4510         |
| 2000                         | 1700                | 2047         | 2587         | 3878         | 4792         |
| 2100                         | 1800                | 2167         | 2740         | 4106         | 5074         |
| 2200                         | 1900                | 2288         | 2892         | 4334         | 5356         |
| 2300                         | 2000                | 2408         | 3044         | 4562         | 5638         |
| 2400                         | 2100                | 2528         | 3196         | 4790         | 5920         |
| 2500                         | 2200                | 2649         | 3348         | 5018         | 6202         |
| 2600                         | 2300                | 2769         | 3501         | 5246         | 6484         |
| 2700                         | 2400                | 2890         | 3653         | 5474         | 6766         |
| 2800                         | 2500                | 3010         | 3805         | 5703         | 7048         |
| 2900                         | 2600                | 3130         | 3957         | 5931         | 7329         |
| 3000                         | 2700                | 3251         | 4109         | 6159         | 7611         |

Other cover heights are available to suits building parameters. Please contact your sales consultant.

# Style 6 - Case Height: 445mm & 515mm

## Precision (E-Series) Outputs

Emitter Height: 143mm  
Cover Height: 445mm

| Emitter Type:<br>Case Depth: |                     | E11<br>103mm | E12<br>153mm | E22<br>176mm | E24<br>259mm |
|------------------------------|---------------------|--------------|--------------|--------------|--------------|
| Case Length (mm)             | Emitter Length (mm) | $\Delta T50$ | $\Delta T50$ | $\Delta T50$ | $\Delta T50$ |
| 700                          | 400                 | 99           | 144          | 244          | 320          |
| 800                          | 500                 | 124          | 180          | 305          | 400          |
| 900                          | 600                 | 149          | 215          | 366          | 479          |
| 1000                         | 700                 | 174          | 251          | 427          | 559          |
| 1100                         | 800                 | 198          | 287          | 488          | 639          |
| 1200                         | 900                 | 223          | 323          | 549          | 719          |
| 1300                         | 1000                | 248          | 359          | 610          | 799          |
| 1400                         | 1100                | 273          | 395          | 671          | 879          |
| 1500                         | 1200                | 298          | 431          | 732          | 959          |
| 1600                         | 1300                | 322          | 467          | 793          | 1039         |
| 1700                         | 1400                | 347          | 503          | 854          | 1119         |
| 1800                         | 1500                | 372          | 539          | 915          | 1199         |
| 1900                         | 1600                | 397          | 574          | 976          | 1278         |
| 2000                         | 1700                | 422          | 610          | 1037         | 1358         |
| 2100                         | 1800                | 446          | 646          | 1098         | 1438         |
| 2200                         | 1900                | 471          | 682          | 1159         | 1518         |
| 2300                         | 2000                | 496          | 718          | 1220         | 1598         |
| 2400                         | 2100                | 521          | 754          | 1281         | 1678         |
| 2500                         | 2200                | 546          | 790          | 1342         | 1758         |
| 2600                         | 2300                | 570          | 826          | 1403         | 1838         |
| 2700                         | 2400                | 595          | 862          | 1464         | 1918         |
| 2800                         | 2500                | 620          | 898          | 1525         | 1998         |
| 2900                         | 2600                | 645          | 933          | 1586         | 2077         |
| 3000                         | 2700                | 670          | 969          | 1647         | 2157         |

Emitter Height: 215mm  
Cover Height: 515mm

| Emitter Type:<br>Case Depth: |                     | E11<br>103mm | E12<br>153mm | E22<br>176mm | E24<br>259mm |
|------------------------------|---------------------|--------------|--------------|--------------|--------------|
| Case Length (mm)             | Emitter Length (mm) | $\Delta T50$ | $\Delta T50$ | $\Delta T50$ | $\Delta T50$ |
| 700                          | 400                 | 145          | 204          | 335          | 439          |
| 800                          | 500                 | 182          | 256          | 419          | 549          |
| 900                          | 600                 | 218          | 307          | 503          | 658          |
| 1000                         | 700                 | 254          | 358          | 587          | 768          |
| 1100                         | 800                 | 290          | 409          | 670          | 878          |
| 1200                         | 900                 | 327          | 460          | 754          | 987          |
| 1300                         | 1000                | 363          | 511          | 838          | 1097         |
| 1400                         | 1100                | 399          | 562          | 922          | 1207         |
| 1500                         | 1200                | 436          | 613          | 1006         | 1316         |
| 1600                         | 1300                | 472          | 664          | 1089         | 1426         |
| 1700                         | 1400                | 508          | 715          | 1173         | 1536         |
| 1800                         | 1500                | 545          | 767          | 1257         | 1646         |
| 1900                         | 1600                | 581          | 818          | 1341         | 1755         |
| 2000                         | 1700                | 617          | 869          | 1425         | 1865         |
| 2100                         | 1800                | 653          | 920          | 1508         | 1975         |
| 2200                         | 1900                | 690          | 971          | 1592         | 2084         |
| 2300                         | 2000                | 726          | 1022         | 1676         | 2194         |
| 2400                         | 2100                | 762          | 1073         | 1760         | 2304         |
| 2500                         | 2200                | 799          | 1124         | 1844         | 2413         |
| 2600                         | 2300                | 835          | 1175         | 1927         | 2523         |
| 2700                         | 2400                | 871          | 1226         | 2011         | 2633         |
| 2800                         | 2500                | 908          | 1278         | 2095         | 2743         |
| 2900                         | 2600                | 944          | 1329         | 2179         | 2852         |
| 3000                         | 2700                | 980          | 1380         | 2263         | 2962         |

Other cover heights are available to suits building parameters. Please contact your sales consultant.

# Style 6 - Case Height: 585mm & 655mm

## Precision (E-Series) Outputs

Emitter Height: 288mm  
Cover Height: 585mm

| Emitter Type:<br>Case Depth: |                     | E11<br>103mm | E12<br>153mm | E22<br>176mm | E24<br>259mm |
|------------------------------|---------------------|--------------|--------------|--------------|--------------|
| Case Length (mm)             | Emitter Length (mm) | $\Delta T50$ | $\Delta T50$ | $\Delta T50$ | $\Delta T50$ |
| 700                          | 400                 | 192          | 264          | 420          | 550          |
| 800                          | 500                 | 240          | 330          | 526          | 688          |
| 900                          | 600                 | 287          | 396          | 631          | 825          |
| 1000                         | 700                 | 335          | 462          | 736          | 963          |
| 1100                         | 800                 | 383          | 528          | 841          | 1100         |
| 1200                         | 900                 | 431          | 594          | 946          | 1238         |
| 1300                         | 1000                | 479          | 660          | 1051         | 1375         |
| 1400                         | 1100                | 527          | 726          | 1156         | 1513         |
| 1500                         | 1200                | 575          | 792          | 1261         | 1650         |
| 1600                         | 1300                | 623          | 858          | 1366         | 1788         |
| 1700                         | 1400                | 671          | 924          | 1471         | 1925         |
| 1800                         | 1500                | 719          | 990          | 1577         | 2063         |
| 1900                         | 1600                | 766          | 1056         | 1682         | 2200         |
| 2000                         | 1700                | 814          | 1122         | 1787         | 2338         |
| 2100                         | 1800                | 862          | 1188         | 1892         | 2475         |
| 2200                         | 1900                | 910          | 1254         | 1997         | 2613         |
| 2300                         | 2000                | 958          | 1320         | 2102         | 2750         |
| 2400                         | 2100                | 1006         | 1386         | 2207         | 2888         |
| 2500                         | 2200                | 1054         | 1452         | 2312         | 3025         |
| 2600                         | 2300                | 1102         | 1518         | 2417         | 3163         |
| 2700                         | 2400                | 1150         | 1584         | 2522         | 3300         |
| 2800                         | 2500                | 1198         | 1650         | 2628         | 3438         |
| 2900                         | 2600                | 1245         | 1716         | 2733         | 3575         |
| 3000                         | 2700                | 1293         | 1782         | 2838         | 3713         |

Emitter Height: 360mm  
Cover Height: 655mm

| Emitter Type:<br>Case Depth: |                     | E11<br>103mm | E12<br>153mm | E22<br>176mm | E24<br>259mm |
|------------------------------|---------------------|--------------|--------------|--------------|--------------|
| Case Length (mm)             | Emitter Length (mm) | $\Delta T50$ | $\Delta T50$ | $\Delta T50$ | $\Delta T50$ |
| 700                          | 400                 | 252          | 332          | 499          | 664          |
| 800                          | 500                 | 315          | 416          | 624          | 831          |
| 900                          | 600                 | 378          | 499          | 749          | 997          |
| 1000                         | 700                 | 441          | 582          | 874          | 1163         |
| 1100                         | 800                 | 504          | 665          | 998          | 1329         |
| 1200                         | 900                 | 567          | 748          | 1123         | 1495         |
| 1300                         | 1000                | 630          | 831          | 1248         | 1661         |
| 1400                         | 1100                | 693          | 914          | 1373         | 1827         |
| 1500                         | 1200                | 756          | 997          | 1498         | 1993         |
| 1600                         | 1300                | 819          | 1080         | 1622         | 2159         |
| 1700                         | 1400                | 882          | 1163         | 1747         | 2325         |
| 1800                         | 1500                | 945          | 1247         | 1872         | 2492         |
| 1900                         | 1600                | 1008         | 1330         | 1997         | 2658         |
| 2000                         | 1700                | 1071         | 1413         | 2122         | 2824         |
| 2100                         | 1800                | 1134         | 1496         | 2246         | 2990         |
| 2200                         | 1900                | 1197         | 1579         | 2371         | 3156         |
| 2300                         | 2000                | 1260         | 1662         | 2496         | 3322         |
| 2400                         | 2100                | 1323         | 1745         | 2621         | 3488         |
| 2500                         | 2200                | 1386         | 1828         | 2746         | 3654         |
| 2600                         | 2300                | 1449         | 1911         | 2870         | 3820         |
| 2700                         | 2400                | 1512         | 1994         | 2995         | 3986         |
| 2800                         | 2500                | 1575         | 2078         | 3120         | 4153         |
| 2900                         | 2600                | 1638         | 2161         | 3245         | 4319         |
| 3000                         | 2700                | 1701         | 2244         | 3370         | 4485         |

Other cover heights are available to suits building parameters. Please contact your sales consultant.

# Style 6 - Case Height: 725mm & 795mm

## Precision (E-Series) Outputs

Emitter Height: 433mm  
Cover Height: 725mm

| Emitter Type:<br>Case Depth: |                     | E11<br>103mm | E12<br>153mm | E22<br>176mm | E24<br>259mm |
|------------------------------|---------------------|--------------|--------------|--------------|--------------|
| Case Length (mm)             | Emitter Length (mm) | $\Delta T50$ | $\Delta T50$ | $\Delta T50$ | $\Delta T50$ |
| 700                          | 400                 | 294          | 378          | 575          | 758          |
| 800                          | 500                 | 367          | 472          | 719          | 948          |
| 900                          | 600                 | 440          | 566          | 863          | 1137         |
| 1000                         | 700                 | 514          | 661          | 1007         | 1327         |
| 1100                         | 800                 | 587          | 755          | 1150         | 1516         |
| 1200                         | 900                 | 661          | 850          | 1294         | 1706         |
| 1300                         | 1000                | 734          | 944          | 1438         | 1895         |
| 1400                         | 1100                | 807          | 1038         | 1582         | 2085         |
| 1500                         | 1200                | 881          | 1133         | 1726         | 2274         |
| 1600                         | 1300                | 954          | 1227         | 1869         | 2464         |
| 1700                         | 1400                | 1028         | 1322         | 2013         | 2653         |
| 1800                         | 1500                | 1101         | 1416         | 2157         | 2843         |
| 1900                         | 1600                | 1174         | 1510         | 2301         | 3032         |
| 2000                         | 1700                | 1248         | 1605         | 2445         | 3222         |
| 2100                         | 1800                | 1321         | 1699         | 2588         | 3411         |
| 2200                         | 1900                | 1395         | 1794         | 2732         | 3601         |
| 2300                         | 2000                | 1468         | 1888         | 2876         | 3790         |
| 2400                         | 2100                | 1541         | 1982         | 3020         | 3980         |
| 2500                         | 2200                | 1615         | 2077         | 3164         | 4169         |
| 2600                         | 2300                | 1688         | 2171         | 3307         | 4359         |
| 2700                         | 2400                | 1762         | 2266         | 3451         | 4548         |
| 2800                         | 2500                | 1835         | 2360         | 3595         | 4738         |
| 2900                         | 2600                | 1908         | 2454         | 3739         | 4927         |
| 3000                         | 2700                | 1982         | 2549         | 3883         | 5117         |

Emitter Height: 505mm  
Cover Height: 795mm

| Emitter Type:<br>Case Depth: |                     | E11<br>103mm | E12<br>153mm | E22<br>176mm | E24<br>259mm |
|------------------------------|---------------------|--------------|--------------|--------------|--------------|
| Case Length (mm)             | Emitter Length (mm) | $\Delta T50$ | $\Delta T50$ | $\Delta T50$ | $\Delta T50$ |
| 700                          | 400                 | 333          | 422          | 647          | 844          |
| 800                          | 500                 | 417          | 528          | 809          | 1055         |
| 900                          | 600                 | 500          | 633          | 971          | 1265         |
| 1000                         | 700                 | 583          | 739          | 1133         | 1476         |
| 1100                         | 800                 | 666          | 844          | 1294         | 1687         |
| 1200                         | 900                 | 750          | 950          | 1456         | 1898         |
| 1300                         | 1000                | 833          | 1055         | 1618         | 2109         |
| 1400                         | 1100                | 916          | 1161         | 1780         | 2320         |
| 1500                         | 1200                | 1000         | 1266         | 1942         | 2531         |
| 1600                         | 1300                | 1083         | 1372         | 2103         | 2742         |
| 1700                         | 1400                | 1166         | 1477         | 2265         | 2953         |
| 1800                         | 1500                | 1250         | 1583         | 2427         | 3164         |
| 1900                         | 1600                | 1333         | 1688         | 2589         | 3374         |
| 2000                         | 1700                | 1416         | 1794         | 2751         | 3585         |
| 2100                         | 1800                | 1499         | 1899         | 2912         | 3796         |
| 2200                         | 1900                | 1583         | 2005         | 3074         | 4007         |
| 2300                         | 2000                | 1666         | 2110         | 3236         | 4218         |
| 2400                         | 2100                | 1749         | 2216         | 3398         | 4429         |
| 2500                         | 2200                | 1833         | 2321         | 3560         | 4640         |
| 2600                         | 2300                | 1916         | 2427         | 3721         | 4851         |
| 2700                         | 2400                | 1999         | 2532         | 3883         | 5062         |
| 2800                         | 2500                | 2083         | 2638         | 4045         | 5273         |
| 2900                         | 2600                | 2166         | 2743         | 4207         | 5483         |
| 3000                         | 2700                | 2249         | 2849         | 4369         | 5694         |

Other cover heights are available to suits building parameters. Please contact your sales consultant.

# Style 6 - Case Height: 865mm & 935mm

## Precision (E-Series) Outputs

Emitter Height: 578mm  
Cover Height: 865mm

| Emitter Type:<br>Case Depth: |                     | E11<br>103mm | E12<br>153mm | E22<br>176mm | E24<br>259mm |
|------------------------------|---------------------|--------------|--------------|--------------|--------------|
| Case Length (mm)             | Emitter Length (mm) | $\Delta T50$ | $\Delta T50$ | $\Delta T50$ | $\Delta T50$ |
| 700                          | 400                 | 372          | 468          | 717          | 925          |
| 800                          | 500                 | 466          | 585          | 897          | 1157         |
| 900                          | 600                 | 559          | 702          | 1076         | 1388         |
| 1000                         | 700                 | 652          | 819          | 1255         | 1619         |
| 1100                         | 800                 | 745          | 936          | 1434         | 1850         |
| 1200                         | 900                 | 838          | 1053         | 1614         | 2082         |
| 1300                         | 1000                | 931          | 1170         | 1793         | 2313         |
| 1400                         | 1100                | 1024         | 1287         | 1972         | 2544         |
| 1500                         | 1200                | 1117         | 1404         | 2152         | 2776         |
| 1600                         | 1300                | 1210         | 1521         | 2331         | 3007         |
| 1700                         | 1400                | 1303         | 1638         | 2510         | 3238         |
| 1800                         | 1500                | 1397         | 1755         | 2690         | 3470         |
| 1900                         | 1600                | 1490         | 1872         | 2869         | 3701         |
| 2000                         | 1700                | 1583         | 1989         | 3048         | 3932         |
| 2100                         | 1800                | 1676         | 2106         | 3227         | 4163         |
| 2200                         | 1900                | 1769         | 2223         | 3407         | 4395         |
| 2300                         | 2000                | 1862         | 2340         | 3586         | 4626         |
| 2400                         | 2100                | 1955         | 2457         | 3765         | 4857         |
| 2500                         | 2200                | 2048         | 2574         | 3945         | 5089         |
| 2600                         | 2300                | 2141         | 2691         | 4124         | 5320         |
| 2700                         | 2400                | 2234         | 2808         | 4303         | 5551         |
| 2800                         | 2500                | 2328         | 2925         | 4483         | 5783         |
| 2900                         | 2600                | 2421         | 3042         | 4662         | 6014         |
| 3000                         | 2700                | 2514         | 3159         | 4841         | 6245         |

Emitter Height: 650mm  
Cover Height: 935mm

| Emitter Type:<br>Case Depth: |                     | E11<br>103mm | E12<br>153mm | E22<br>176mm | E24<br>259mm |
|------------------------------|---------------------|--------------|--------------|--------------|--------------|
| Case Length (mm)             | Emitter Length (mm) | $\Delta T50$ | $\Delta T50$ | $\Delta T50$ | $\Delta T50$ |
| 700                          | 400                 | 410          | 514          | 784          | 999          |
| 800                          | 500                 | 512          | 643          | 980          | 1249         |
| 900                          | 600                 | 614          | 772          | 1176         | 1499         |
| 1000                         | 700                 | 717          | 900          | 1372         | 1749         |
| 1100                         | 800                 | 819          | 1029         | 1568         | 1998         |
| 1200                         | 900                 | 922          | 1157         | 1764         | 2248         |
| 1300                         | 1000                | 1024         | 1286         | 1960         | 2498         |
| 1400                         | 1100                | 1126         | 1415         | 2156         | 2748         |
| 1500                         | 1200                | 1229         | 1543         | 2352         | 2998         |
| 1600                         | 1300                | 1331         | 1672         | 2548         | 3247         |
| 1700                         | 1400                | 1434         | 1800         | 2744         | 3497         |
| 1800                         | 1500                | 1536         | 1929         | 2940         | 3747         |
| 1900                         | 1600                | 1638         | 2058         | 3136         | 3997         |
| 2000                         | 1700                | 1741         | 2186         | 3332         | 4247         |
| 2100                         | 1800                | 1843         | 2315         | 3528         | 4496         |
| 2200                         | 1900                | 1946         | 2443         | 3724         | 4746         |
| 2300                         | 2000                | 2048         | 2572         | 3920         | 4996         |
| 2400                         | 2100                | 2150         | 2701         | 4116         | 5246         |
| 2500                         | 2200                | 2253         | 2829         | 4312         | 5496         |
| 2600                         | 2300                | 2355         | 2958         | 4508         | 5745         |
| 2700                         | 2400                | 2458         | 3086         | 4704         | 5995         |
| 2800                         | 2500                | 2560         | 3215         | 4900         | 6245         |
| 2900                         | 2600                | 2662         | 3344         | 5096         | 6495         |
| 3000                         | 2700                | 2765         | 3472         | 5292         | 6745         |

# Style 6 - Case Height: 1005mm & 1075mm

## Precision (E-Series) Outputs

Emitter Height: 723mm  
Cover Height: 1005mm

| Emitter Type:<br>Case Depth: |                     | E11<br>103mm | E12<br>153mm | E22<br>176mm | E24<br>259mm |
|------------------------------|---------------------|--------------|--------------|--------------|--------------|
| Case Length (mm)             | Emitter Length (mm) | $\Delta T50$ | $\Delta T50$ | $\Delta T50$ | $\Delta T50$ |
| 700                          | 400                 | 446          | 561          | 850          | 1067         |
| 800                          | 500                 | 558          | 702          | 1062         | 1334         |
| 900                          | 600                 | 670          | 842          | 1274         | 1601         |
| 1000                         | 700                 | 781          | 982          | 1487         | 1868         |
| 1100                         | 800                 | 893          | 1122         | 1699         | 2134         |
| 1200                         | 900                 | 1004         | 1263         | 1912         | 2401         |
| 1300                         | 1000                | 1116         | 1403         | 2124         | 2668         |
| 1400                         | 1100                | 1228         | 1543         | 2336         | 2935         |
| 1500                         | 1200                | 1339         | 1684         | 2549         | 3202         |
| 1600                         | 1300                | 1451         | 1824         | 2761         | 3468         |
| 1700                         | 1400                | 1562         | 1964         | 2974         | 3735         |
| 1800                         | 1500                | 1674         | 2105         | 3186         | 4002         |
| 1900                         | 1600                | 1786         | 2245         | 3398         | 4269         |
| 2000                         | 1700                | 1897         | 2385         | 3611         | 4536         |
| 2100                         | 1800                | 2009         | 2525         | 3823         | 4802         |
| 2200                         | 1900                | 2120         | 2666         | 4036         | 5069         |
| 2300                         | 2000                | 2232         | 2806         | 4248         | 5336         |
| 2400                         | 2100                | 2344         | 2946         | 4460         | 5603         |
| 2500                         | 2200                | 2455         | 3087         | 4673         | 5870         |
| 2600                         | 2300                | 2567         | 3227         | 4885         | 6136         |
| 2700                         | 2400                | 2678         | 3367         | 5098         | 6403         |
| 2800                         | 2500                | 2790         | 3508         | 5310         | 6670         |
| 2900                         | 2600                | 2902         | 3648         | 5522         | 6937         |
| 3000                         | 2700                | 3013         | 3788         | 5735         | 7204         |

Emitter Height: 795mm  
Cover Height: 1075mm

| Emitter Type:<br>Case Depth: |                     | E11<br>103mm | E12<br>153mm | E22<br>176mm | E24<br>259mm |
|------------------------------|---------------------|--------------|--------------|--------------|--------------|
| Case Length (mm)             | Emitter Length (mm) | $\Delta T50$ | $\Delta T50$ | $\Delta T50$ | $\Delta T50$ |
| 700                          | 400                 | 482          | 609          | 912          | 1128         |
| 800                          | 500                 | 602          | 761          | 1141         | 1410         |
| 900                          | 600                 | 722          | 913          | 1369         | 1691         |
| 1000                         | 700                 | 843          | 1065         | 1597         | 1973         |
| 1100                         | 800                 | 963          | 1218         | 1825         | 2255         |
| 1200                         | 900                 | 1084         | 1370         | 2053         | 2537         |
| 1300                         | 1000                | 1204         | 1522         | 2281         | 2819         |
| 1400                         | 1100                | 1324         | 1674         | 2509         | 3101         |
| 1500                         | 1200                | 1445         | 1826         | 2737         | 3383         |
| 1600                         | 1300                | 1565         | 1979         | 2965         | 3665         |
| 1700                         | 1400                | 1686         | 2131         | 3193         | 3947         |
| 1800                         | 1500                | 1806         | 2283         | 3422         | 4229         |
| 1900                         | 1600                | 1926         | 2435         | 3650         | 4510         |
| 2000                         | 1700                | 2047         | 2587         | 3878         | 4792         |
| 2100                         | 1800                | 2167         | 2740         | 4106         | 5074         |
| 2200                         | 1900                | 2288         | 2892         | 4334         | 5356         |
| 2300                         | 2000                | 2408         | 3044         | 4562         | 5638         |
| 2400                         | 2100                | 2528         | 3196         | 4790         | 5920         |
| 2500                         | 2200                | 2649         | 3348         | 5018         | 6202         |
| 2600                         | 2300                | 2769         | 3501         | 5246         | 6484         |
| 2700                         | 2400                | 2890         | 3653         | 5474         | 6766         |
| 2800                         | 2500                | 3010         | 3805         | 5703         | 7048         |
| 2900                         | 2600                | 3130         | 3957         | 5931         | 7329         |
| 3000                         | 2700                | 3251         | 4109         | 6159         | 7611         |

Other cover heights are available to suits building parameters. Please contact your sales consultant.



# Style 7 - Case Height: 445mm & 515mm

## Precision (E-Series) Outputs

Emitter Height: 143mm

Cover Height: 445mm

| Emitter Type:<br>Case Depth: |                     | E11<br>103mm | E12<br>153mm | E22<br>176mm | E24<br>259mm |
|------------------------------|---------------------|--------------|--------------|--------------|--------------|
| Case Length (mm)             | Emitter Length (mm) | $\Delta T50$ | $\Delta T50$ | $\Delta T50$ | $\Delta T50$ |
| 700                          | 400                 | 99           | 144          | 244          | 320          |
| 800                          | 500                 | 124          | 180          | 305          | 400          |
| 900                          | 600                 | 149          | 215          | 366          | 479          |
| 1000                         | 700                 | 174          | 251          | 427          | 559          |
| 1100                         | 800                 | 198          | 287          | 488          | 639          |
| 1200                         | 900                 | 223          | 323          | 549          | 719          |
| 1300                         | 1000                | 248          | 359          | 610          | 799          |
| 1400                         | 1100                | 273          | 395          | 671          | 879          |
| 1500                         | 1200                | 298          | 431          | 732          | 959          |
| 1600                         | 1300                | 322          | 467          | 793          | 1039         |
| 1700                         | 1400                | 347          | 503          | 854          | 1119         |
| 1800                         | 1500                | 372          | 539          | 915          | 1199         |
| 1900                         | 1600                | 397          | 574          | 976          | 1278         |
| 2000                         | 1700                | 422          | 610          | 1037         | 1358         |
| 2100                         | 1800                | 446          | 646          | 1098         | 1438         |
| 2200                         | 1900                | 471          | 682          | 1159         | 1518         |
| 2300                         | 2000                | 496          | 718          | 1220         | 1598         |
| 2400                         | 2100                | 521          | 754          | 1281         | 1678         |
| 2500                         | 2200                | 546          | 790          | 1342         | 1758         |
| 2600                         | 2300                | 570          | 826          | 1403         | 1838         |
| 2700                         | 2400                | 595          | 862          | 1464         | 1918         |
| 2800                         | 2500                | 620          | 898          | 1525         | 1998         |
| 2900                         | 2600                | 645          | 933          | 1586         | 2077         |
| 3000                         | 2700                | 670          | 969          | 1647         | 2157         |

Emitter Height: 215mm

Cover Height: 515mm

| Emitter Type:<br>Case Depth: |                     | E11<br>103mm | E12<br>153mm | E22<br>176mm | E24<br>259mm |
|------------------------------|---------------------|--------------|--------------|--------------|--------------|
| Case Length (mm)             | Emitter Length (mm) | $\Delta T50$ | $\Delta T50$ | $\Delta T50$ | $\Delta T50$ |
| 700                          | 400                 | 145          | 204          | 335          | 439          |
| 800                          | 500                 | 182          | 256          | 419          | 549          |
| 900                          | 600                 | 218          | 307          | 503          | 658          |
| 1000                         | 700                 | 254          | 358          | 587          | 768          |
| 1100                         | 800                 | 290          | 409          | 670          | 878          |
| 1200                         | 900                 | 327          | 460          | 754          | 987          |
| 1300                         | 1000                | 363          | 511          | 838          | 1097         |
| 1400                         | 1100                | 399          | 562          | 922          | 1207         |
| 1500                         | 1200                | 436          | 613          | 1006         | 1316         |
| 1600                         | 1300                | 472          | 664          | 1089         | 1426         |
| 1700                         | 1400                | 508          | 715          | 1173         | 1536         |
| 1800                         | 1500                | 545          | 767          | 1257         | 1646         |
| 1900                         | 1600                | 581          | 818          | 1341         | 1755         |
| 2000                         | 1700                | 617          | 869          | 1425         | 1865         |
| 2100                         | 1800                | 653          | 920          | 1508         | 1975         |
| 2200                         | 1900                | 690          | 971          | 1592         | 2084         |
| 2300                         | 2000                | 726          | 1022         | 1676         | 2194         |
| 2400                         | 2100                | 762          | 1073         | 1760         | 2304         |
| 2500                         | 2200                | 799          | 1124         | 1844         | 2413         |
| 2600                         | 2300                | 835          | 1175         | 1927         | 2523         |
| 2700                         | 2400                | 871          | 1226         | 2011         | 2633         |
| 2800                         | 2500                | 908          | 1278         | 2095         | 2743         |
| 2900                         | 2600                | 944          | 1329         | 2179         | 2852         |
| 3000                         | 2700                | 980          | 1380         | 2263         | 2962         |

Other cover heights are available to suits building parameters. Please contact your sales consultant.

# Style 7 - Case Height: 585mm & 655mm

## Precision (E-Series) Outputs

Emitter Height: 288mm  
Cover Height: 585mm

| Emitter Type:<br>Case Depth: |                     | E11<br>103mm | E12<br>153mm | E22<br>176mm | E24<br>259mm |
|------------------------------|---------------------|--------------|--------------|--------------|--------------|
| Case Length (mm)             | Emitter Length (mm) | $\Delta T50$ | $\Delta T50$ | $\Delta T50$ | $\Delta T50$ |
| 700                          | 400                 | 192          | 264          | 420          | 550          |
| 800                          | 500                 | 240          | 330          | 526          | 688          |
| 900                          | 600                 | 287          | 396          | 631          | 825          |
| 1000                         | 700                 | 335          | 462          | 736          | 963          |
| 1100                         | 800                 | 383          | 528          | 841          | 1100         |
| 1200                         | 900                 | 431          | 594          | 946          | 1238         |
| 1300                         | 1000                | 479          | 660          | 1051         | 1375         |
| 1400                         | 1100                | 527          | 726          | 1156         | 1513         |
| 1500                         | 1200                | 575          | 792          | 1261         | 1650         |
| 1600                         | 1300                | 623          | 858          | 1366         | 1788         |
| 1700                         | 1400                | 671          | 924          | 1471         | 1925         |
| 1800                         | 1500                | 719          | 990          | 1577         | 2063         |
| 1900                         | 1600                | 766          | 1056         | 1682         | 2200         |
| 2000                         | 1700                | 814          | 1122         | 1787         | 2338         |
| 2100                         | 1800                | 862          | 1188         | 1892         | 2475         |
| 2200                         | 1900                | 910          | 1254         | 1997         | 2613         |
| 2300                         | 2000                | 958          | 1320         | 2102         | 2750         |
| 2400                         | 2100                | 1006         | 1386         | 2207         | 2888         |
| 2500                         | 2200                | 1054         | 1452         | 2312         | 3025         |
| 2600                         | 2300                | 1102         | 1518         | 2417         | 3163         |
| 2700                         | 2400                | 1150         | 1584         | 2522         | 3300         |
| 2800                         | 2500                | 1198         | 1650         | 2628         | 3438         |
| 2900                         | 2600                | 1245         | 1716         | 2733         | 3575         |
| 3000                         | 2700                | 1293         | 1782         | 2838         | 3713         |

Emitter Height: 360mm  
Cover Height: 655mm

| Emitter Type:<br>Case Depth: |                     | E11<br>103mm | E12<br>153mm | E22<br>176mm | E24<br>259mm |
|------------------------------|---------------------|--------------|--------------|--------------|--------------|
| Case Length (mm)             | Emitter Length (mm) | $\Delta T50$ | $\Delta T50$ | $\Delta T50$ | $\Delta T50$ |
| 700                          | 400                 | 252          | 332          | 499          | 664          |
| 800                          | 500                 | 315          | 416          | 624          | 831          |
| 900                          | 600                 | 378          | 499          | 749          | 997          |
| 1000                         | 700                 | 441          | 582          | 874          | 1163         |
| 1100                         | 800                 | 504          | 665          | 998          | 1329         |
| 1200                         | 900                 | 567          | 748          | 1123         | 1495         |
| 1300                         | 1000                | 630          | 831          | 1248         | 1661         |
| 1400                         | 1100                | 693          | 914          | 1373         | 1827         |
| 1500                         | 1200                | 756          | 997          | 1498         | 1993         |
| 1600                         | 1300                | 819          | 1080         | 1622         | 2159         |
| 1700                         | 1400                | 882          | 1163         | 1747         | 2325         |
| 1800                         | 1500                | 945          | 1247         | 1872         | 2492         |
| 1900                         | 1600                | 1008         | 1330         | 1997         | 2658         |
| 2000                         | 1700                | 1071         | 1413         | 2122         | 2824         |
| 2100                         | 1800                | 1134         | 1496         | 2246         | 2990         |
| 2200                         | 1900                | 1197         | 1579         | 2371         | 3156         |
| 2300                         | 2000                | 1260         | 1662         | 2496         | 3322         |
| 2400                         | 2100                | 1323         | 1745         | 2621         | 3488         |
| 2500                         | 2200                | 1386         | 1828         | 2746         | 3654         |
| 2600                         | 2300                | 1449         | 1911         | 2870         | 3820         |
| 2700                         | 2400                | 1512         | 1994         | 2995         | 3986         |
| 2800                         | 2500                | 1575         | 2078         | 3120         | 4153         |
| 2900                         | 2600                | 1638         | 2161         | 3245         | 4319         |
| 3000                         | 2700                | 1701         | 2244         | 3370         | 4485         |

# Style 7 - Case Height: 725mm & 795mm

## Precision (E-Series) Outputs

Emitter Height: 433mm

Cover Height: 725mm

| Emitter Type:    |                     | E11          | E12          | E22          | E24          |
|------------------|---------------------|--------------|--------------|--------------|--------------|
| Case Depth:      |                     | 103mm        | 153mm        | 176mm        | 259mm        |
| Case Length (mm) | Emitter Length (mm) | $\Delta T50$ | $\Delta T50$ | $\Delta T50$ | $\Delta T50$ |
| 700              | 400                 | 294          | 378          | 575          | 758          |
| 800              | 500                 | 367          | 472          | 719          | 948          |
| 900              | 600                 | 440          | 566          | 863          | 1137         |
| 1000             | 700                 | 514          | 661          | 1007         | 1327         |
| 1100             | 800                 | 587          | 755          | 1150         | 1516         |
| 1200             | 900                 | 661          | 850          | 1294         | 1706         |
| 1300             | 1000                | 734          | 944          | 1438         | 1895         |
| 1400             | 1100                | 807          | 1038         | 1582         | 2085         |
| 1500             | 1200                | 881          | 1133         | 1726         | 2274         |
| 1600             | 1300                | 954          | 1227         | 1869         | 2464         |
| 1700             | 1400                | 1028         | 1322         | 2013         | 2653         |
| 1800             | 1500                | 1101         | 1416         | 2157         | 2843         |
| 1900             | 1600                | 1174         | 1510         | 2301         | 3032         |
| 2000             | 1700                | 1248         | 1605         | 2445         | 3222         |
| 2100             | 1800                | 1321         | 1699         | 2588         | 3411         |
| 2200             | 1900                | 1395         | 1794         | 2732         | 3601         |
| 2300             | 2000                | 1468         | 1888         | 2876         | 3790         |
| 2400             | 2100                | 1541         | 1982         | 3020         | 3980         |
| 2500             | 2200                | 1615         | 2077         | 3164         | 4169         |
| 2600             | 2300                | 1688         | 2171         | 3307         | 4359         |
| 2700             | 2400                | 1762         | 2266         | 3451         | 4548         |
| 2800             | 2500                | 1835         | 2360         | 3595         | 4738         |
| 2900             | 2600                | 1908         | 2454         | 3739         | 4927         |
| 3000             | 2700                | 1982         | 2549         | 3883         | 5117         |

Emitter Height: 505mm

Cover Height: 795mm

| Emitter Type:    |                     | E11          | E12          | E22          | E24          |
|------------------|---------------------|--------------|--------------|--------------|--------------|
| Case Depth:      |                     | 103mm        | 153mm        | 176mm        | 259mm        |
| Case Length (mm) | Emitter Length (mm) | $\Delta T50$ | $\Delta T50$ | $\Delta T50$ | $\Delta T50$ |
| 700              | 400                 | 333          | 422          | 647          | 844          |
| 800              | 500                 | 417          | 528          | 809          | 1055         |
| 900              | 600                 | 500          | 633          | 971          | 1265         |
| 1000             | 700                 | 583          | 739          | 1133         | 1476         |
| 1100             | 800                 | 666          | 844          | 1294         | 1687         |
| 1200             | 900                 | 750          | 950          | 1456         | 1898         |
| 1300             | 1000                | 833          | 1055         | 1618         | 2109         |
| 1400             | 1100                | 916          | 1161         | 1780         | 2320         |
| 1500             | 1200                | 1000         | 1266         | 1942         | 2531         |
| 1600             | 1300                | 1083         | 1372         | 2103         | 2742         |
| 1700             | 1400                | 1166         | 1477         | 2265         | 2953         |
| 1800             | 1500                | 1250         | 1583         | 2427         | 3164         |
| 1900             | 1600                | 1333         | 1688         | 2589         | 3374         |
| 2000             | 1700                | 1416         | 1794         | 2751         | 3585         |
| 2100             | 1800                | 1499         | 1899         | 2912         | 3796         |
| 2200             | 1900                | 1583         | 2005         | 3074         | 4007         |
| 2300             | 2000                | 1666         | 2110         | 3236         | 4218         |
| 2400             | 2100                | 1749         | 2216         | 3398         | 4429         |
| 2500             | 2200                | 1833         | 2321         | 3560         | 4640         |
| 2600             | 2300                | 1916         | 2427         | 3721         | 4851         |
| 2700             | 2400                | 1999         | 2532         | 3883         | 5062         |
| 2800             | 2500                | 2083         | 2638         | 4045         | 5273         |
| 2900             | 2600                | 2166         | 2743         | 4207         | 5483         |
| 3000             | 2700                | 2249         | 2849         | 4369         | 5694         |

Other cover heights are available to suits building parameters. Please contact your sales consultant.

# Style 7 - Case Height: 865mm & 935mm

## Precision (E-Series) Outputs

Emitter Height: 578mm  
Cover Height: 865mm

| Emitter Type:<br>Case Depth: |                     | E11<br>103mm | E12<br>153mm | E22<br>176mm | E24<br>259mm |
|------------------------------|---------------------|--------------|--------------|--------------|--------------|
| Case Length (mm)             | Emitter Length (mm) | $\Delta T50$ | $\Delta T50$ | $\Delta T50$ | $\Delta T50$ |
| 700                          | 400                 | 372          | 468          | 717          | 925          |
| 800                          | 500                 | 466          | 585          | 897          | 1157         |
| 900                          | 600                 | 559          | 702          | 1076         | 1388         |
| 1000                         | 700                 | 652          | 819          | 1255         | 1619         |
| 1100                         | 800                 | 745          | 936          | 1434         | 1850         |
| 1200                         | 900                 | 838          | 1053         | 1614         | 2082         |
| 1300                         | 1000                | 931          | 1170         | 1793         | 2313         |
| 1400                         | 1100                | 1024         | 1287         | 1972         | 2544         |
| 1500                         | 1200                | 1117         | 1404         | 2152         | 2776         |
| 1600                         | 1300                | 1210         | 1521         | 2331         | 3007         |
| 1700                         | 1400                | 1303         | 1638         | 2510         | 3238         |
| 1800                         | 1500                | 1397         | 1755         | 2690         | 3470         |
| 1900                         | 1600                | 1490         | 1872         | 2869         | 3701         |
| 2000                         | 1700                | 1583         | 1989         | 3048         | 3932         |
| 2100                         | 1800                | 1676         | 2106         | 3227         | 4163         |
| 2200                         | 1900                | 1769         | 2223         | 3407         | 4395         |
| 2300                         | 2000                | 1862         | 2340         | 3586         | 4626         |
| 2400                         | 2100                | 1955         | 2457         | 3765         | 4857         |
| 2500                         | 2200                | 2048         | 2574         | 3945         | 5089         |
| 2600                         | 2300                | 2141         | 2691         | 4124         | 5320         |
| 2700                         | 2400                | 2234         | 2808         | 4303         | 5551         |
| 2800                         | 2500                | 2328         | 2925         | 4483         | 5783         |
| 2900                         | 2600                | 2421         | 3042         | 4662         | 6014         |
| 3000                         | 2700                | 2514         | 3159         | 4841         | 6245         |

Emitter Height: 650mm  
Cover Height: 935mm

| Emitter Type:<br>Case Depth: |                     | E11<br>103mm | E12<br>153mm | E22<br>176mm | E24<br>259mm |
|------------------------------|---------------------|--------------|--------------|--------------|--------------|
| Case Length (mm)             | Emitter Length (mm) | $\Delta T50$ | $\Delta T50$ | $\Delta T50$ | $\Delta T50$ |
| 700                          | 400                 | 410          | 514          | 784          | 999          |
| 800                          | 500                 | 512          | 643          | 980          | 1249         |
| 900                          | 600                 | 614          | 772          | 1176         | 1499         |
| 1000                         | 700                 | 717          | 900          | 1372         | 1749         |
| 1100                         | 800                 | 819          | 1029         | 1568         | 1998         |
| 1200                         | 900                 | 922          | 1157         | 1764         | 2248         |
| 1300                         | 1000                | 1024         | 1286         | 1960         | 2498         |
| 1400                         | 1100                | 1126         | 1415         | 2156         | 2748         |
| 1500                         | 1200                | 1229         | 1543         | 2352         | 2998         |
| 1600                         | 1300                | 1331         | 1672         | 2548         | 3247         |
| 1700                         | 1400                | 1434         | 1800         | 2744         | 3497         |
| 1800                         | 1500                | 1536         | 1929         | 2940         | 3747         |
| 1900                         | 1600                | 1638         | 2058         | 3136         | 3997         |
| 2000                         | 1700                | 1741         | 2186         | 3332         | 4247         |
| 2100                         | 1800                | 1843         | 2315         | 3528         | 4496         |
| 2200                         | 1900                | 1946         | 2443         | 3724         | 4746         |
| 2300                         | 2000                | 2048         | 2572         | 3920         | 4996         |
| 2400                         | 2100                | 2150         | 2701         | 4116         | 5246         |
| 2500                         | 2200                | 2253         | 2829         | 4312         | 5496         |
| 2600                         | 2300                | 2355         | 2958         | 4508         | 5745         |
| 2700                         | 2400                | 2458         | 3086         | 4704         | 5995         |
| 2800                         | 2500                | 2560         | 3215         | 4900         | 6245         |
| 2900                         | 2600                | 2662         | 3344         | 5096         | 6495         |
| 3000                         | 2700                | 2765         | 3472         | 5292         | 6745         |

Other cover heights are available to suits building parameters. Please contact your sales consultant.

# Style 7 - Case Height: 1005mm & 1075mm

## Precision (E-Series) Outputs

Emitter Height: 723mm  
Cover Height: 1005mm

| Emitter Type:<br>Case Depth: |                     | E11<br>103mm | E12<br>153mm | E22<br>176mm | E24<br>259mm |
|------------------------------|---------------------|--------------|--------------|--------------|--------------|
| Case Length (mm)             | Emitter Length (mm) | $\Delta T50$ | $\Delta T50$ | $\Delta T50$ | $\Delta T50$ |
| 700                          | 400                 | 446          | 561          | 850          | 1067         |
| 800                          | 500                 | 558          | 702          | 1062         | 1334         |
| 900                          | 600                 | 670          | 842          | 1274         | 1601         |
| 1000                         | 700                 | 781          | 982          | 1487         | 1868         |
| 1100                         | 800                 | 893          | 1122         | 1699         | 2134         |
| 1200                         | 900                 | 1004         | 1263         | 1912         | 2401         |
| 1300                         | 1000                | 1116         | 1403         | 2124         | 2668         |
| 1400                         | 1100                | 1228         | 1543         | 2336         | 2935         |
| 1500                         | 1200                | 1339         | 1684         | 2549         | 3202         |
| 1600                         | 1300                | 1451         | 1824         | 2761         | 3468         |
| 1700                         | 1400                | 1562         | 1964         | 2974         | 3735         |
| 1800                         | 1500                | 1674         | 2105         | 3186         | 4002         |
| 1900                         | 1600                | 1786         | 2245         | 3398         | 4269         |
| 2000                         | 1700                | 1897         | 2385         | 3611         | 4536         |
| 2100                         | 1800                | 2009         | 2525         | 3823         | 4802         |
| 2200                         | 1900                | 2120         | 2666         | 4036         | 5069         |
| 2300                         | 2000                | 2232         | 2806         | 4248         | 5336         |
| 2400                         | 2100                | 2344         | 2946         | 4460         | 5603         |
| 2500                         | 2200                | 2455         | 3087         | 4673         | 5870         |
| 2600                         | 2300                | 2567         | 3227         | 4885         | 6136         |
| 2700                         | 2400                | 2678         | 3367         | 5098         | 6403         |
| 2800                         | 2500                | 2790         | 3508         | 5310         | 6670         |
| 2900                         | 2600                | 2902         | 3648         | 5522         | 6937         |
| 3000                         | 2700                | 3013         | 3788         | 5735         | 7204         |

Emitter Height: 795mm  
Cover Height: 1075mm

| Emitter Type:<br>Case Depth: |                     | E11<br>103mm | E12<br>153mm | E22<br>176mm | E24<br>259mm |
|------------------------------|---------------------|--------------|--------------|--------------|--------------|
| Case Length (mm)             | Emitter Length (mm) | $\Delta T50$ | $\Delta T50$ | $\Delta T50$ | $\Delta T50$ |
| 700                          | 400                 | 482          | 609          | 912          | 1128         |
| 800                          | 500                 | 602          | 761          | 1141         | 1410         |
| 900                          | 600                 | 722          | 913          | 1369         | 1691         |
| 1000                         | 700                 | 843          | 1065         | 1597         | 1973         |
| 1100                         | 800                 | 963          | 1218         | 1825         | 2255         |
| 1200                         | 900                 | 1084         | 1370         | 2053         | 2537         |
| 1300                         | 1000                | 1204         | 1522         | 2281         | 2819         |
| 1400                         | 1100                | 1324         | 1674         | 2509         | 3101         |
| 1500                         | 1200                | 1445         | 1826         | 2737         | 3383         |
| 1600                         | 1300                | 1565         | 1979         | 2965         | 3665         |
| 1700                         | 1400                | 1686         | 2131         | 3193         | 3947         |
| 1800                         | 1500                | 1806         | 2283         | 3422         | 4229         |
| 1900                         | 1600                | 1926         | 2435         | 3650         | 4510         |
| 2000                         | 1700                | 2047         | 2587         | 3878         | 4792         |
| 2100                         | 1800                | 2167         | 2740         | 4106         | 5074         |
| 2200                         | 1900                | 2288         | 2892         | 4334         | 5356         |
| 2300                         | 2000                | 2408         | 3044         | 4562         | 5638         |
| 2400                         | 2100                | 2528         | 3196         | 4790         | 5920         |
| 2500                         | 2200                | 2649         | 3348         | 5018         | 6202         |
| 2600                         | 2300                | 2769         | 3501         | 5246         | 6484         |
| 2700                         | 2400                | 2890         | 3653         | 5474         | 6766         |
| 2800                         | 2500                | 3010         | 3805         | 5703         | 7048         |
| 2900                         | 2600                | 3130         | 3957         | 5931         | 7329         |
| 3000                         | 2700                | 3251         | 4109         | 6159         | 7611         |

# Style 8 - Case Height: 515mm & 585mm

## Precision (E-Series) Outputs

Emitter Height: 143mm  
Cover Height: 515mm

| Emitter Type:<br>Case Depth: |                     | E11<br>103mm | E12<br>153mm | E22<br>176mm | E24<br>259mm |
|------------------------------|---------------------|--------------|--------------|--------------|--------------|
| Case Length (mm)             | Emitter Length (mm) | $\Delta T50$ | $\Delta T50$ | $\Delta T50$ | $\Delta T50$ |
| 700                          | 400                 | 99           | 144          | 244          | 320          |
| 800                          | 500                 | 124          | 180          | 305          | 400          |
| 900                          | 600                 | 149          | 215          | 366          | 479          |
| 1000                         | 700                 | 174          | 251          | 427          | 559          |
| 1100                         | 800                 | 198          | 287          | 488          | 639          |
| 1200                         | 900                 | 223          | 323          | 549          | 719          |
| 1300                         | 1000                | 248          | 359          | 610          | 799          |
| 1400                         | 1100                | 273          | 395          | 671          | 879          |
| 1500                         | 1200                | 298          | 431          | 732          | 959          |
| 1600                         | 1300                | 322          | 467          | 793          | 1039         |
| 1700                         | 1400                | 347          | 503          | 854          | 1119         |
| 1800                         | 1500                | 372          | 539          | 915          | 1199         |
| 1900                         | 1600                | 397          | 574          | 976          | 1278         |
| 2000                         | 1700                | 422          | 610          | 1037         | 1358         |
| 2100                         | 1800                | 446          | 646          | 1098         | 1438         |
| 2200                         | 1900                | 471          | 682          | 1159         | 1518         |
| 2300                         | 2000                | 496          | 718          | 1220         | 1598         |
| 2400                         | 2100                | 521          | 754          | 1281         | 1678         |
| 2500                         | 2200                | 546          | 790          | 1342         | 1758         |
| 2600                         | 2300                | 570          | 826          | 1403         | 1838         |
| 2700                         | 2400                | 595          | 862          | 1464         | 1918         |
| 2800                         | 2500                | 620          | 898          | 1525         | 1998         |
| 2900                         | 2600                | 645          | 933          | 1586         | 2077         |
| 3000                         | 2700                | 670          | 969          | 1647         | 2157         |

Emitter Height: 215mm  
Cover Height: 585mm

| Emitter Type:<br>Case Depth: |                     | E11<br>103mm | E12<br>153mm | E22<br>176mm | E24<br>259mm |
|------------------------------|---------------------|--------------|--------------|--------------|--------------|
| Case Length (mm)             | Emitter Length (mm) | $\Delta T50$ | $\Delta T50$ | $\Delta T50$ | $\Delta T50$ |
| 700                          | 400                 | 145          | 204          | 335          | 439          |
| 800                          | 500                 | 182          | 256          | 419          | 549          |
| 900                          | 600                 | 218          | 307          | 503          | 658          |
| 1000                         | 700                 | 254          | 358          | 587          | 768          |
| 1100                         | 800                 | 290          | 409          | 670          | 878          |
| 1200                         | 900                 | 327          | 460          | 754          | 987          |
| 1300                         | 1000                | 363          | 511          | 838          | 1097         |
| 1400                         | 1100                | 399          | 562          | 922          | 1207         |
| 1500                         | 1200                | 436          | 613          | 1006         | 1316         |
| 1600                         | 1300                | 472          | 664          | 1089         | 1426         |
| 1700                         | 1400                | 508          | 715          | 1173         | 1536         |
| 1800                         | 1500                | 545          | 767          | 1257         | 1646         |
| 1900                         | 1600                | 581          | 818          | 1341         | 1755         |
| 2000                         | 1700                | 617          | 869          | 1425         | 1865         |
| 2100                         | 1800                | 653          | 920          | 1508         | 1975         |
| 2200                         | 1900                | 690          | 971          | 1592         | 2084         |
| 2300                         | 2000                | 726          | 1022         | 1676         | 2194         |
| 2400                         | 2100                | 762          | 1073         | 1760         | 2304         |
| 2500                         | 2200                | 799          | 1124         | 1844         | 2413         |
| 2600                         | 2300                | 835          | 1175         | 1927         | 2523         |
| 2700                         | 2400                | 871          | 1226         | 2011         | 2633         |
| 2800                         | 2500                | 908          | 1278         | 2095         | 2743         |
| 2900                         | 2600                | 944          | 1329         | 2179         | 2852         |
| 3000                         | 2700                | 980          | 1380         | 2263         | 2962         |

Other cover heights are available to suits building parameters. Please contact your sales consultant.

# Style 8 - Case Height: 655mm & 725mm

## Precision (E-Series) Outputs

Emitter Height: 288mm

Cover Height: 655mm

| Emitter Type:    |                     | E11          | E12          | E22          | E24          |
|------------------|---------------------|--------------|--------------|--------------|--------------|
| Case Depth:      |                     | 103mm        | 153mm        | 176mm        | 259mm        |
| Case Length (mm) | Emitter Length (mm) | $\Delta T50$ | $\Delta T50$ | $\Delta T50$ | $\Delta T50$ |
| 700              | 400                 | 192          | 264          | 420          | 550          |
| 800              | 500                 | 240          | 330          | 526          | 688          |
| 900              | 600                 | 287          | 396          | 631          | 825          |
| 1000             | 700                 | 335          | 462          | 736          | 963          |
| 1100             | 800                 | 383          | 528          | 841          | 1100         |
| 1200             | 900                 | 431          | 594          | 946          | 1238         |
| 1300             | 1000                | 479          | 660          | 1051         | 1375         |
| 1400             | 1100                | 527          | 726          | 1156         | 1513         |
| 1500             | 1200                | 575          | 792          | 1261         | 1650         |
| 1600             | 1300                | 623          | 858          | 1366         | 1788         |
| 1700             | 1400                | 671          | 924          | 1471         | 1925         |
| 1800             | 1500                | 719          | 990          | 1577         | 2063         |
| 1900             | 1600                | 766          | 1056         | 1682         | 2200         |
| 2000             | 1700                | 814          | 1122         | 1787         | 2338         |
| 2100             | 1800                | 862          | 1188         | 1892         | 2475         |
| 2200             | 1900                | 910          | 1254         | 1997         | 2613         |
| 2300             | 2000                | 958          | 1320         | 2102         | 2750         |
| 2400             | 2100                | 1006         | 1386         | 2207         | 2888         |
| 2500             | 2200                | 1054         | 1452         | 2312         | 3025         |
| 2600             | 2300                | 1102         | 1518         | 2417         | 3163         |
| 2700             | 2400                | 1150         | 1584         | 2522         | 3300         |
| 2800             | 2500                | 1198         | 1650         | 2628         | 3438         |
| 2900             | 2600                | 1245         | 1716         | 2733         | 3575         |
| 3000             | 2700                | 1293         | 1782         | 2838         | 3713         |

Emitter Height: 360mm

Cover Height: 725mm

| Emitter Type:    |                     | E11          | E12          | E22          | E24          |
|------------------|---------------------|--------------|--------------|--------------|--------------|
| Case Depth:      |                     | 103mm        | 153mm        | 176mm        | 259mm        |
| Case Length (mm) | Emitter Length (mm) | $\Delta T50$ | $\Delta T50$ | $\Delta T50$ | $\Delta T50$ |
| 700              | 400                 | 252          | 332          | 499          | 664          |
| 800              | 500                 | 315          | 416          | 624          | 831          |
| 900              | 600                 | 378          | 499          | 749          | 997          |
| 1000             | 700                 | 441          | 582          | 874          | 1163         |
| 1100             | 800                 | 504          | 665          | 998          | 1329         |
| 1200             | 900                 | 567          | 748          | 1123         | 1495         |
| 1300             | 1000                | 630          | 831          | 1248         | 1661         |
| 1400             | 1100                | 693          | 914          | 1373         | 1827         |
| 1500             | 1200                | 756          | 997          | 1498         | 1993         |
| 1600             | 1300                | 819          | 1080         | 1622         | 2159         |
| 1700             | 1400                | 882          | 1163         | 1747         | 2325         |
| 1800             | 1500                | 945          | 1247         | 1872         | 2492         |
| 1900             | 1600                | 1008         | 1330         | 1997         | 2658         |
| 2000             | 1700                | 1071         | 1413         | 2122         | 2824         |
| 2100             | 1800                | 1134         | 1496         | 2246         | 2990         |
| 2200             | 1900                | 1197         | 1579         | 2371         | 3156         |
| 2300             | 2000                | 1260         | 1662         | 2496         | 3322         |
| 2400             | 2100                | 1323         | 1745         | 2621         | 3488         |
| 2500             | 2200                | 1386         | 1828         | 2746         | 3654         |
| 2600             | 2300                | 1449         | 1911         | 2870         | 3820         |
| 2700             | 2400                | 1512         | 1994         | 2995         | 3986         |
| 2800             | 2500                | 1575         | 2078         | 3120         | 4153         |
| 2900             | 2600                | 1638         | 2161         | 3245         | 4319         |
| 3000             | 2700                | 1701         | 2244         | 3370         | 4485         |

Other cover heights are available to suits building parameters. Please contact your sales consultant.



# Style 8 - Case Height: 795mm & 865mm

## Precision (E-Series) Outputs

Emitter Height: 433mm  
Cover Height: 795mm

| Emitter Type:<br>Case Depth: |                     | E11<br>103mm | E12<br>153mm | E22<br>176mm | E24<br>259mm |
|------------------------------|---------------------|--------------|--------------|--------------|--------------|
| Case Length (mm)             | Emitter Length (mm) | $\Delta T50$ | $\Delta T50$ | $\Delta T50$ | $\Delta T50$ |
| 700                          | 400                 | 294          | 378          | 575          | 758          |
| 800                          | 500                 | 367          | 472          | 719          | 948          |
| 900                          | 600                 | 440          | 566          | 863          | 1137         |
| 1000                         | 700                 | 514          | 661          | 1007         | 1327         |
| 1100                         | 800                 | 587          | 755          | 1150         | 1516         |
| 1200                         | 900                 | 661          | 850          | 1294         | 1706         |
| 1300                         | 1000                | 734          | 944          | 1438         | 1895         |
| 1400                         | 1100                | 807          | 1038         | 1582         | 2085         |
| 1500                         | 1200                | 881          | 1133         | 1726         | 2274         |
| 1600                         | 1300                | 954          | 1227         | 1869         | 2464         |
| 1700                         | 1400                | 1028         | 1322         | 2013         | 2653         |
| 1800                         | 1500                | 1101         | 1416         | 2157         | 2843         |
| 1900                         | 1600                | 1174         | 1510         | 2301         | 3032         |
| 2000                         | 1700                | 1248         | 1605         | 2445         | 3222         |
| 2100                         | 1800                | 1321         | 1699         | 2588         | 3411         |
| 2200                         | 1900                | 1395         | 1794         | 2732         | 3601         |
| 2300                         | 2000                | 1468         | 1888         | 2876         | 3790         |
| 2400                         | 2100                | 1541         | 1982         | 3020         | 3980         |
| 2500                         | 2200                | 1615         | 2077         | 3164         | 4169         |
| 2600                         | 2300                | 1688         | 2171         | 3307         | 4359         |
| 2700                         | 2400                | 1762         | 2266         | 3451         | 4548         |
| 2800                         | 2500                | 1835         | 2360         | 3595         | 4738         |
| 2900                         | 2600                | 1908         | 2454         | 3739         | 4927         |
| 3000                         | 2700                | 1982         | 2549         | 3883         | 5117         |

Emitter Height: 505mm  
Cover Height: 865mm

| Emitter Type:<br>Case Depth: |                     | E11<br>103mm | E12<br>153mm | E22<br>176mm | E24<br>259mm |
|------------------------------|---------------------|--------------|--------------|--------------|--------------|
| Case Length (mm)             | Emitter Length (mm) | $\Delta T50$ | $\Delta T50$ | $\Delta T50$ | $\Delta T50$ |
| 700                          | 400                 | 333          | 422          | 647          | 844          |
| 800                          | 500                 | 417          | 528          | 809          | 1055         |
| 900                          | 600                 | 500          | 633          | 971          | 1265         |
| 1000                         | 700                 | 583          | 739          | 1133         | 1476         |
| 1100                         | 800                 | 666          | 844          | 1294         | 1687         |
| 1200                         | 900                 | 750          | 950          | 1456         | 1898         |
| 1300                         | 1000                | 833          | 1055         | 1618         | 2109         |
| 1400                         | 1100                | 916          | 1161         | 1780         | 2320         |
| 1500                         | 1200                | 1000         | 1266         | 1942         | 2531         |
| 1600                         | 1300                | 1083         | 1372         | 2103         | 2742         |
| 1700                         | 1400                | 1166         | 1477         | 2265         | 2953         |
| 1800                         | 1500                | 1250         | 1583         | 2427         | 3164         |
| 1900                         | 1600                | 1333         | 1688         | 2589         | 3374         |
| 2000                         | 1700                | 1416         | 1794         | 2751         | 3585         |
| 2100                         | 1800                | 1499         | 1899         | 2912         | 3796         |
| 2200                         | 1900                | 1583         | 2005         | 3074         | 4007         |
| 2300                         | 2000                | 1666         | 2110         | 3236         | 4218         |
| 2400                         | 2100                | 1749         | 2216         | 3398         | 4429         |
| 2500                         | 2200                | 1833         | 2321         | 3560         | 4640         |
| 2600                         | 2300                | 1916         | 2427         | 3721         | 4851         |
| 2700                         | 2400                | 1999         | 2532         | 3883         | 5062         |
| 2800                         | 2500                | 2083         | 2638         | 4045         | 5273         |
| 2900                         | 2600                | 2166         | 2743         | 4207         | 5483         |
| 3000                         | 2700                | 2249         | 2849         | 4369         | 5694         |

Other cover heights are available to suits building parameters. Please contact your sales consultant.

# Style 8 - Case Height: 935mm & 1005mm

## Precision (E-Series) Outputs

Emitter Height: 578mm

Cover Height: 935mm

| Emitter Type:    |                     | E11          | E12          | E22          | E24          |
|------------------|---------------------|--------------|--------------|--------------|--------------|
| Case Depth:      |                     | 103mm        | 153mm        | 176mm        | 259mm        |
| Case Length (mm) | Emitter Length (mm) | $\Delta T50$ | $\Delta T50$ | $\Delta T50$ | $\Delta T50$ |
| 700              | 400                 | 372          | 468          | 717          | 925          |
| 800              | 500                 | 466          | 585          | 897          | 1157         |
| 900              | 600                 | 559          | 702          | 1076         | 1388         |
| 1000             | 700                 | 652          | 819          | 1255         | 1619         |
| 1100             | 800                 | 745          | 936          | 1434         | 1850         |
| 1200             | 900                 | 838          | 1053         | 1614         | 2082         |
| 1300             | 1000                | 931          | 1170         | 1793         | 2313         |
| 1400             | 1100                | 1024         | 1287         | 1972         | 2544         |
| 1500             | 1200                | 1117         | 1404         | 2152         | 2776         |
| 1600             | 1300                | 1210         | 1521         | 2331         | 3007         |
| 1700             | 1400                | 1303         | 1638         | 2510         | 3238         |
| 1800             | 1500                | 1397         | 1755         | 2690         | 3470         |
| 1900             | 1600                | 1490         | 1872         | 2869         | 3701         |
| 2000             | 1700                | 1583         | 1989         | 3048         | 3932         |
| 2100             | 1800                | 1676         | 2106         | 3227         | 4163         |
| 2200             | 1900                | 1769         | 2223         | 3407         | 4395         |
| 2300             | 2000                | 1862         | 2340         | 3586         | 4626         |
| 2400             | 2100                | 1955         | 2457         | 3765         | 4857         |
| 2500             | 2200                | 2048         | 2574         | 3945         | 5089         |
| 2600             | 2300                | 2141         | 2691         | 4124         | 5320         |
| 2700             | 2400                | 2234         | 2808         | 4303         | 5551         |
| 2800             | 2500                | 2328         | 2925         | 4483         | 5783         |
| 2900             | 2600                | 2421         | 3042         | 4662         | 6014         |
| 3000             | 2700                | 2514         | 3159         | 4841         | 6245         |

Emitter Height: 650mm

Cover Height: 1005mm

| Emitter Type:    |                     | E11          | E12          | E22          | E24          |
|------------------|---------------------|--------------|--------------|--------------|--------------|
| Case Depth:      |                     | 103mm        | 153mm        | 176mm        | 259mm        |
| Case Length (mm) | Emitter Length (mm) | $\Delta T50$ | $\Delta T50$ | $\Delta T50$ | $\Delta T50$ |
| 700              | 400                 | 410          | 514          | 784          | 999          |
| 800              | 500                 | 512          | 643          | 980          | 1249         |
| 900              | 600                 | 614          | 772          | 1176         | 1499         |
| 1000             | 700                 | 717          | 900          | 1372         | 1749         |
| 1100             | 800                 | 819          | 1029         | 1568         | 1998         |
| 1200             | 900                 | 922          | 1157         | 1764         | 2248         |
| 1300             | 1000                | 1024         | 1286         | 1960         | 2498         |
| 1400             | 1100                | 1126         | 1415         | 2156         | 2748         |
| 1500             | 1200                | 1229         | 1543         | 2352         | 2998         |
| 1600             | 1300                | 1331         | 1672         | 2548         | 3247         |
| 1700             | 1400                | 1434         | 1800         | 2744         | 3497         |
| 1800             | 1500                | 1536         | 1929         | 2940         | 3747         |
| 1900             | 1600                | 1638         | 2058         | 3136         | 3997         |
| 2000             | 1700                | 1741         | 2186         | 3332         | 4247         |
| 2100             | 1800                | 1843         | 2315         | 3528         | 4496         |
| 2200             | 1900                | 1946         | 2443         | 3724         | 4746         |
| 2300             | 2000                | 2048         | 2572         | 3920         | 4996         |
| 2400             | 2100                | 2150         | 2701         | 4116         | 5246         |
| 2500             | 2200                | 2253         | 2829         | 4312         | 5496         |
| 2600             | 2300                | 2355         | 2958         | 4508         | 5745         |
| 2700             | 2400                | 2458         | 3086         | 4704         | 5995         |
| 2800             | 2500                | 2560         | 3215         | 4900         | 6245         |
| 2900             | 2600                | 2662         | 3344         | 5096         | 6495         |
| 3000             | 2700                | 2765         | 3472         | 5292         | 6745         |

Other cover heights are available to suits building parameters. Please contact your sales consultant.

# Style 8 - Case Height: 1075mm & 1145mm

## Precision (E-Series) Outputs

Emitter Height: 723mm  
Cover Height: 1075mm

| Emitter Type:<br>Case Depth: |                     | E11<br>103mm | E12<br>153mm | E22<br>176mm | E24<br>259mm |
|------------------------------|---------------------|--------------|--------------|--------------|--------------|
| Case Length (mm)             | Emitter Length (mm) | $\Delta T50$ | $\Delta T50$ | $\Delta T50$ | $\Delta T50$ |
| 700                          | 400                 | 446          | 561          | 850          | 1067         |
| 800                          | 500                 | 558          | 702          | 1062         | 1334         |
| 900                          | 600                 | 670          | 842          | 1274         | 1601         |
| 1000                         | 700                 | 781          | 982          | 1487         | 1868         |
| 1100                         | 800                 | 893          | 1122         | 1699         | 2134         |
| 1200                         | 900                 | 1004         | 1263         | 1912         | 2401         |
| 1300                         | 1000                | 1116         | 1403         | 2124         | 2668         |
| 1400                         | 1100                | 1228         | 1543         | 2336         | 2935         |
| 1500                         | 1200                | 1339         | 1684         | 2549         | 3202         |
| 1600                         | 1300                | 1451         | 1824         | 2761         | 3468         |
| 1700                         | 1400                | 1562         | 1964         | 2974         | 3735         |
| 1800                         | 1500                | 1674         | 2105         | 3186         | 4002         |
| 1900                         | 1600                | 1786         | 2245         | 3398         | 4269         |
| 2000                         | 1700                | 1897         | 2385         | 3611         | 4536         |
| 2100                         | 1800                | 2009         | 2525         | 3823         | 4802         |
| 2200                         | 1900                | 2120         | 2666         | 4036         | 5069         |
| 2300                         | 2000                | 2232         | 2806         | 4248         | 5336         |
| 2400                         | 2100                | 2344         | 2946         | 4460         | 5603         |
| 2500                         | 2200                | 2455         | 3087         | 4673         | 5870         |
| 2600                         | 2300                | 2567         | 3227         | 4885         | 6136         |
| 2700                         | 2400                | 2678         | 3367         | 5098         | 6403         |
| 2800                         | 2500                | 2790         | 3508         | 5310         | 6670         |
| 2900                         | 2600                | 2902         | 3648         | 5522         | 6937         |
| 3000                         | 2700                | 3013         | 3788         | 5735         | 7204         |

Emitter Height: 795mm  
Cover Height: 1145mm

| Emitter Type:<br>Case Depth: |                     | E11<br>103mm | E12<br>153mm | E22<br>176mm | E24<br>259mm |
|------------------------------|---------------------|--------------|--------------|--------------|--------------|
| Case Length (mm)             | Emitter Length (mm) | $\Delta T50$ | $\Delta T50$ | $\Delta T50$ | $\Delta T50$ |
| 700                          | 400                 | 482          | 609          | 912          | 1128         |
| 800                          | 500                 | 602          | 761          | 1141         | 1410         |
| 900                          | 600                 | 722          | 913          | 1369         | 1691         |
| 1000                         | 700                 | 843          | 1065         | 1597         | 1973         |
| 1100                         | 800                 | 963          | 1218         | 1825         | 2255         |
| 1200                         | 900                 | 1084         | 1370         | 2053         | 2537         |
| 1300                         | 1000                | 1204         | 1522         | 2281         | 2819         |
| 1400                         | 1100                | 1324         | 1674         | 2509         | 3101         |
| 1500                         | 1200                | 1445         | 1826         | 2737         | 3383         |
| 1600                         | 1300                | 1565         | 1979         | 2965         | 3665         |
| 1700                         | 1400                | 1686         | 2131         | 3193         | 3947         |
| 1800                         | 1500                | 1806         | 2283         | 3422         | 4229         |
| 1900                         | 1600                | 1926         | 2435         | 3650         | 4510         |
| 2000                         | 1700                | 2047         | 2587         | 3878         | 4792         |
| 2100                         | 1800                | 2167         | 2740         | 4106         | 5074         |
| 2200                         | 1900                | 2288         | 2892         | 4334         | 5356         |
| 2300                         | 2000                | 2408         | 3044         | 4562         | 5638         |
| 2400                         | 2100                | 2528         | 3196         | 4790         | 5920         |
| 2500                         | 2200                | 2649         | 3348         | 5018         | 6202         |
| 2600                         | 2300                | 2769         | 3501         | 5246         | 6484         |
| 2700                         | 2400                | 2890         | 3653         | 5474         | 6766         |
| 2800                         | 2500                | 3010         | 3805         | 5703         | 7048         |
| 2900                         | 2600                | 3130         | 3957         | 5931         | 7329         |
| 3000                         | 2700                | 3251         | 4109         | 6159         | 7611         |

Other cover heights are available to suits building parameters. Please contact your sales consultant.

# Style 10 - Case Height: 280mm & 350mm

## Precision (E-Series) Outputs

Emitter Height: 143mm  
Cover Height: 280mm

| Emitter Type:    |                     | E12                  | E24                  |
|------------------|---------------------|----------------------|----------------------|
| Case Depth:      |                     | 153mm (164mm ACTUAL) | 259mm (270mm ACTUAL) |
| Case Length (mm) | Emitter Length (mm) | $\Delta T50$         | $\Delta T50$         |
| 700              | 400                 | 144                  | 320                  |
| 800              | 500                 | 180                  | 400                  |
| 900              | 600                 | 215                  | 479                  |
| 1000             | 700                 | 251                  | 559                  |
| 1100             | 800                 | 287                  | 639                  |
| 1200             | 900                 | 323                  | 719                  |
| 1300             | 1000                | 359                  | 799                  |
| 1400             | 1100                | 395                  | 879                  |
| 1500             | 1200                | 431                  | 959                  |
| 1600             | 1300                | 467                  | 1039                 |
| 1700             | 1400                | 503                  | 1119                 |
| 1800             | 1500                | 539                  | 1199                 |
| 1900             | 1600                | 574                  | 1278                 |
| 2000             | 1700                | 610                  | 1358                 |
| 2100             | 1800                | 646                  | 1438                 |
| 2200             | 1900                | 682                  | 1518                 |
| 2300             | 2000                | 718                  | 1598                 |
| 2400             | 2100                | 754                  | 1678                 |
| 2500             | 2200                | 790                  | 1758                 |
| 2600             | 2300                | 826                  | 1838                 |
| 2700             | 2400                | 862                  | 1918                 |
| 2800             | 2500                | 898                  | 1998                 |
| 2900             | 2600                | 933                  | 2077                 |
| 3000             | 2700                | 969                  | 2157                 |

Emitter Height: 215mm  
Cover Height: 350mm

| Emitter Type:    |                     | E12                  | E24                  |
|------------------|---------------------|----------------------|----------------------|
| Case Depth:      |                     | 153mm (164mm ACTUAL) | 259mm (270mm ACTUAL) |
| Case Length (mm) | Emitter Length (mm) | $\Delta T50$         | $\Delta T50$         |
| 700              | 400                 | 204                  | 439                  |
| 800              | 500                 | 255                  | 549                  |
| 900              | 600                 | 306                  | 658                  |
| 1000             | 700                 | 357                  | 768                  |
| 1100             | 800                 | 408                  | 878                  |
| 1200             | 900                 | 460                  | 987                  |
| 1300             | 1000                | 511                  | 1097                 |
| 1400             | 1100                | 562                  | 1207                 |
| 1500             | 1200                | 613                  | 1316                 |
| 1600             | 1300                | 664                  | 1426                 |
| 1700             | 1400                | 715                  | 1536                 |
| 1800             | 1500                | 766                  | 1646                 |
| 1900             | 1600                | 817                  | 1755                 |
| 2000             | 1700                | 868                  | 1865                 |
| 2100             | 1800                | 919                  | 1975                 |
| 2200             | 1900                | 970                  | 2084                 |
| 2300             | 2000                | 1021                 | 2194                 |
| 2400             | 2100                | 1072                 | 2304                 |
| 2500             | 2200                | 1123                 | 2414                 |
| 2600             | 2300                | 1174                 | 2523                 |
| 2700             | 2400                | 1225                 | 2633                 |
| 2800             | 2500                | 1277                 | 2743                 |
| 2900             | 2600                | 1328                 | 2852                 |
| 3000             | 2700                | 1379                 | 2962                 |

**Please Note:** Style 10 LST covers are quoted to be 153mm & 259mm deep, although the actual depth is 164mm & 270mm; This is due to the introduction of the rear panel.

# Style 10 - Case Height: 420mm

## Precision (E-Series) Outputs

Emitter Height: 288mm  
Cover Height: 420mm

| Emitter Type:<br>Case Depth: |                     | E12<br>153mm (164mm ACTUAL) | E24<br>259mm (270mm ACTUAL) |
|------------------------------|---------------------|-----------------------------|-----------------------------|
| Case Length (mm)             | Emitter Length (mm) | $\Delta T50$                | $\Delta T50$                |
| 700                          | 400                 | 264                         | 550                         |
| 800                          | 500                 | 330                         | 688                         |
| 900                          | 600                 | 396                         | 825                         |
| 1000                         | 700                 | 462                         | 963                         |
| 1100                         | 800                 | 528                         | 1100                        |
| 1200                         | 900                 | 594                         | 1238                        |
| 1300                         | 1000                | 660                         | 1375                        |
| 1400                         | 1100                | 726                         | 1513                        |
| 1500                         | 1200                | 792                         | 1650                        |
| 1600                         | 1300                | 858                         | 1788                        |
| 1700                         | 1400                | 924                         | 1925                        |
| 1800                         | 1500                | 990                         | 2063                        |
| 1900                         | 1600                | 1056                        | 2200                        |
| 2000                         | 1700                | 1122                        | 2338                        |
| 2100                         | 1800                | 1188                        | 2475                        |
| 2200                         | 1900                | 1254                        | 2613                        |
| 2300                         | 2000                | 1320                        | 2750                        |
| 2400                         | 2100                | 1386                        | 2888                        |
| 2500                         | 2200                | 1452                        | 3025                        |
| 2600                         | 2300                | 1518                        | 3163                        |
| 2700                         | 2400                | 1584                        | 3300                        |
| 2800                         | 2500                | 1650                        | 3438                        |
| 2900                         | 2600                | 1716                        | 3575                        |
| 3000                         | 2700                | 1782                        | 3713                        |

Emitter Height: 360mm  
Cover Height: 490mm

| Emitter Type:<br>Case Depth: |                     | E12<br>153mm (164mm ACTUAL) | E24<br>259mm (270mm ACTUAL) |
|------------------------------|---------------------|-----------------------------|-----------------------------|
| Case Length (mm)             | Emitter Length (mm) | $\Delta T50$                | $\Delta T50$                |
| 700                          | 400                 | 332                         | 664                         |
| 800                          | 500                 | 416                         | 831                         |
| 900                          | 600                 | 499                         | 997                         |
| 1000                         | 700                 | 582                         | 1163                        |
| 1100                         | 800                 | 665                         | 1329                        |
| 1200                         | 900                 | 748                         | 1495                        |
| 1300                         | 1000                | 831                         | 1661                        |
| 1400                         | 1100                | 914                         | 1827                        |
| 1500                         | 1200                | 997                         | 1993                        |
| 1600                         | 1300                | 1080                        | 2159                        |
| 1700                         | 1400                | 1163                        | 2325                        |
| 1800                         | 1500                | 1247                        | 2492                        |
| 1900                         | 1600                | 1330                        | 2658                        |
| 2000                         | 1700                | 1413                        | 2824                        |
| 2100                         | 1800                | 1496                        | 2990                        |
| 2200                         | 1900                | 1579                        | 3156                        |
| 2300                         | 2000                | 1662                        | 3322                        |
| 2400                         | 2100                | 1745                        | 3488                        |
| 2500                         | 2200                | 1828                        | 3654                        |
| 2600                         | 2300                | 1911                        | 3820                        |
| 2700                         | 2400                | 1994                        | 3986                        |
| 2800                         | 2500                | 2078                        | 4153                        |
| 2900                         | 2600                | 2161                        | 4319                        |
| 3000                         | 2700                | 2244                        | 4485                        |

**Please Note:** Style 10 LST covers are quoted to be 153mm & 259mm deep, although the actual depth is 164mm & 270mm; This is due to the introduction of the rear panel.

## Horizontal LST with Primo (RT-Series) Emitter

# Technical Specifications – LST Horizontal Using Primo (RT-Series) Emitter

When fitted with a LST cover, the Primo emitter needs to be mounted with a special bracket.

Standard bracket  
to RT11 and RT33



Special bracket  
to fit RT22 and RT22



## Dimensions for LST Cover fitting with Style 2 & 6

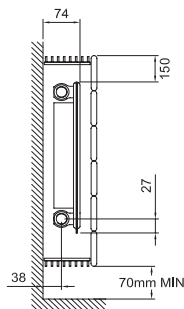

RT11

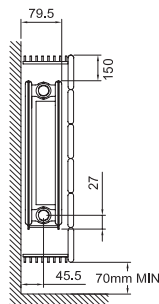

RT21

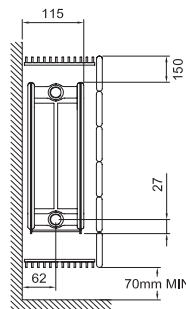

RT22

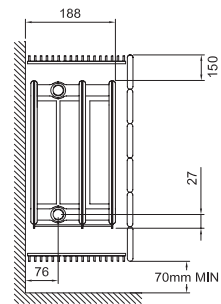

RT33

## Dimensions for LST Cover fitting with Style 3, 4, 7 & 8

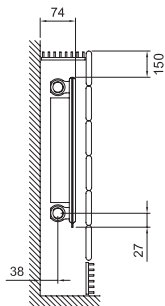

RT11

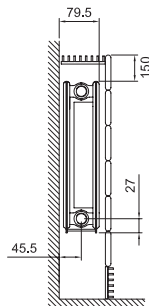

RT21

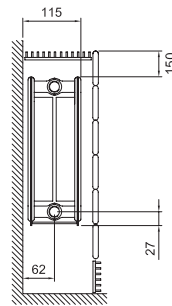

RT22

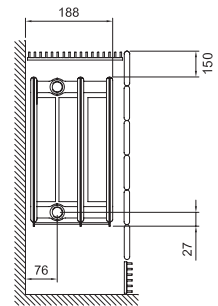

RT33

## Dimensions for LST Cover - Style 10

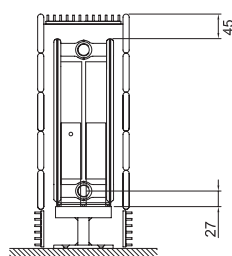

RT22

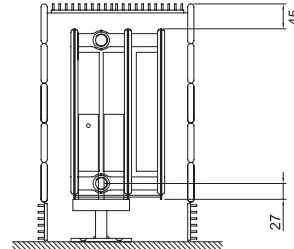

RT33

Emitter heights in the following output tables are the maxima for the given casing heights. However, lower height emitters may be selected in order to increase space available within the casing for pipe-work. It may also be desirable to keep case heights consistent for aesthetic reasons.

Merriott recommends the casing should be 300mm longer than the emitter underneath. The output listed are based on this arrangement. For any additional information, please contact your Merriott sales consultant.

# Technical Specifications

## Primo (RT-Series) Emitter

| Water Content |       |       |       |       |       |       |
|---------------|-------|-------|-------|-------|-------|-------|
| Height        | 300mm | 400mm | 500mm | 600mm | 700mm | 900mm |
| Litres/Metre  |       |       |       |       |       |       |
| RT11          | 1.81  | 2.24  | 2.67  | 3.10  | 3.53  | 4.40  |
| RT21          | 3.60  | 4.47  | 5.33  | 6.20  | 7.07  | 8.80  |
| RT22          | 3.50  | 4.37  | 5.23  | 6.10  | 7.00  | 8.80  |
| RT33          | 5.40  | 6.60  | 7.80  | 9.00  | 10.38 | 13.14 |

| Dry Weight |       |       |       |       |       |       |
|------------|-------|-------|-------|-------|-------|-------|
| Height     | 300mm | 400mm | 500mm | 600mm | 700mm | 900mm |
| Kgs/Metre  |       |       |       |       |       |       |
| RT11       | 8.53  | 11.44 | 14.35 | 17.26 | 20.16 | 25.98 |
| RT21       | 14.33 | 19.04 | 23.75 | 28.47 | 33.18 | 42.61 |
| RT22       | 16.92 | 22.73 | 28.55 | 34.36 | 40.18 | 51.81 |
| RT33       | 26.80 | 36.53 | 46.27 | 56.00 | 57.10 | 59.30 |

| Emitter Type: | Height (mm) | Available Lengths (mm) |     |     |     |      |      |      |      |      |      |      |      |      |      |      |
|---------------|-------------|------------------------|-----|-----|-----|------|------|------|------|------|------|------|------|------|------|------|
| RT11          | 300         | 400                    | 500 | 600 | 700 | 800  | 900  | 1000 | 1100 | 1200 | 1300 | 1400 | 1600 | 1800 | 2000 | -    |
|               | 400         | 400                    | 500 | 600 | 700 | 800  | 900  | 1000 | 1100 | 1200 | 1300 | 1400 | 1600 | 1800 | 2000 | -    |
|               | 500         | 300                    | 400 | 500 | 600 | 700  | 800  | 900  | 1000 | 1100 | 1200 | 1300 | 1400 | 1600 | 1800 | 2000 |
|               | 600         | 300                    | 400 | 500 | 600 | 700  | 800  | 900  | 1000 | 1100 | 1200 | 1300 | 1400 | 1600 | 1800 | 2000 |
|               | 700         | 300                    | 400 | 500 | 600 | 700  | 800  | 900  | 1000 | 1100 | 1200 | 1300 | 1400 | 1600 | 1800 | 2000 |
| RT21          | 300         | 400                    | 500 | 600 | 700 | 900  | 1000 | 1100 | 1200 | 1400 | 1600 | -    | -    | -    | -    | -    |
|               | 400         | 400                    | 500 | 600 | 700 | 800  | 900  | 1000 | 1100 | 1200 | 1400 | 1600 | 1800 | 2000 | -    | -    |
|               | 500         | 300                    | 400 | 500 | 600 | 700  | 800  | 900  | 1000 | 1100 | 1200 | 1400 | 1600 | 1800 | 2000 | -    |
|               | 600         | 300                    | 400 | 500 | 600 | 700  | 800  | 900  | 1000 | 1100 | 1200 | 1400 | 1600 | 1800 | 2000 | -    |
|               | 700         | 500                    | 600 | 700 | 800 | 900  | 1000 | 1200 | -    | -    | -    | -    | -    | -    | -    | -    |
| RT22          | 300         | 400                    | 500 | 600 | 800 | 1000 | 1200 | 1400 | 1600 | 1800 | 2000 | -    | -    | -    | -    | -    |
|               | 400         | 400                    | 500 | 600 | 700 | 800  | 900  | 1000 | 1100 | 1200 | 1300 | 1400 | 1600 | 1800 | 2000 | -    |
|               | 500         | 300                    | 400 | 500 | 600 | 700  | 800  | 900  | 1000 | 1100 | 1200 | 1300 | 1400 | 1600 | 1800 | 2000 |
|               | 600         | 300                    | 400 | 500 | 600 | 700  | 800  | 900  | 1000 | 1100 | 1200 | 1300 | 1400 | 1600 | 1800 | 2000 |
|               | 700         | 300                    | 400 | 500 | 600 | 700  | 800  | 900  | 1000 | 1100 | 1200 | 1300 | 1400 | 1600 | 1800 | 2000 |
| RT33          | 300         | 400                    | 500 | 600 | 700 | 800  | 900  | 1000 | 1100 | 1200 | 1400 | 1600 | 1800 | 2000 | -    | -    |
|               | 400         | 400                    | 500 | 600 | 700 | 800  | 900  | 1000 | 1100 | 1200 | 1300 | 1400 | 1600 | 1800 | 2000 | -    |
|               | 500         | 300                    | 400 | 500 | 600 | 700  | 800  | 900  | 1000 | 1100 | 1200 | 1300 | 1400 | 1600 | 1800 | 2000 |
|               | 600         | 300                    | 400 | 500 | 600 | 700  | 800  | 900  | 1000 | 1100 | 1200 | 1300 | 1400 | 1600 | 1800 | 2000 |
|               | 700         | 300                    | 400 | 500 | 600 | 700  | 800  | 900  | 1000 | 1100 | 1200 | 1300 | 1400 | 1600 | 1800 | 2000 |

Longer lengths are available on request, up 3000mm. Please contact your sales consultant. All other data related to the emitter can be found in the Primo brochure.



# Primo (RT-Series) Outputs

## Watts per metre of emitter

### Style 2 LST Cover

| Emitter Type:<br>Case Depth: |                                | RT11<br>103mm | RT21<br>103mm | RT22<br>153mm | RT33<br>259mm |
|------------------------------|--------------------------------|---------------|---------------|---------------|---------------|
| Case Height (mm)             | Maximum Emitter<br>Height (mm) | $\Delta T50$  | $\Delta T50$  | $\Delta T50$  | $\Delta T50$  |
| 490                          | 300                            | 522           | 783           | 1031          | 1512          |
| 560                          | 300                            | 522           | 783           | 1031          | 1512          |
| 560                          | 400                            | 678           | 987           | 1301          | 1930          |
| 630                          | 300                            | 522           | 783           | 1031          | 1512          |
| 630                          | 400                            | 678           | 987           | 1301          | 1930          |
| 700                          | 300                            | 522           | 783           | 1031          | 1512          |
| 700                          | 400                            | 678           | 987           | 1301          | 1930          |
| 700                          | 500                            | 823           | 1175          | 1555          | 2307          |
| 770                          | 300                            | 522           | 783           | 1031          | 1512          |
| 770                          | 400                            | 678           | 987           | 1301          | 1930          |
| 770                          | 500                            | 823           | 1175          | 1555          | 2307          |
| 840                          | 300                            | 522           | 783           | 1031          | 1512          |
| 840                          | 400                            | 678           | 987           | 1301          | 1930          |
| 840                          | 500                            | 823           | 1175          | 1555          | 2307          |
| 840                          | 600                            | 958           | 1351          | 1797          | 2643          |

### Style 3 LST Cover

| Emitter Type:<br>Case Depth: |                                | RT11<br>103mm | RT21<br>103mm | RT22<br>153mm | RT33<br>259mm |
|------------------------------|--------------------------------|---------------|---------------|---------------|---------------|
| Case Height (mm)             | Maximum Emitter<br>Height (mm) | $\Delta T50$  | $\Delta T50$  | $\Delta T50$  | $\Delta T50$  |
| 490                          | 300                            | 522           | 783           | 1031          | 1512          |
| 560                          | 300                            | 522           | 783           | 1031          | 1512          |
| 560                          | 400                            | 678           | 987           | 1301          | 1930          |
| 630                          | 300                            | 522           | 783           | 1031          | 1512          |
| 630                          | 400                            | 678           | 987           | 1301          | 1930          |
| 700                          | 300                            | 522           | 783           | 1031          | 1512          |
| 700                          | 400                            | 678           | 987           | 1301          | 1930          |
| 700                          | 500                            | 823           | 1175          | 1555          | 2307          |
| 770                          | 300                            | 522           | 783           | 1031          | 1512          |
| 770                          | 400                            | 678           | 987           | 1301          | 1930          |
| 770                          | 500                            | 823           | 1175          | 1555          | 2307          |
| 840                          | 300                            | 522           | 783           | 1031          | 1512          |
| 840                          | 400                            | 678           | 987           | 1301          | 1930          |
| 840                          | 500                            | 823           | 1175          | 1555          | 2307          |
| 840                          | 600                            | 958           | 1351          | 1797          | 2643          |

# Primo (RT-Series) Outputs

## Watts per metre of emitter

### Style 4 LST Cover

| Emitter Type:<br>Case Depth: |                                | RT11<br>103mm | RT21<br>103mm | RT22<br>153mm | RT33<br>259mm |
|------------------------------|--------------------------------|---------------|---------------|---------------|---------------|
| Case Height (mm)             | Maximum Emitter<br>Height (mm) | $\Delta T50$  | $\Delta T50$  | $\Delta T50$  | $\Delta T50$  |
| 560                          | 300                            | 522           | 783           | 1031          | 1512          |
| 630                          | 300                            | 522           | 783           | 1031          | 1512          |
| 700                          | 300                            | 522           | 783           | 1031          | 1512          |
| 700                          | 400                            | 678           | 987           | 1301          | 1930          |
| 770                          | 300                            | 522           | 783           | 1031          | 1512          |
| 770                          | 400                            | 678           | 987           | 1301          | 1930          |
| 770                          | 500                            | 823           | 1175          | 1555          | 2307          |
| 840                          | 300                            | 522           | 783           | 1031          | 1512          |
| 840                          | 400                            | 678           | 987           | 1301          | 1930          |
| 840                          | 500                            | 823           | 1175          | 1555          | 2307          |

### Style 6 LST Cover

| Emitter Type:<br>Case Depth: |                                | RT11<br>103mm | RT21<br>103mm | RT22<br>153mm | RT33<br>259mm |
|------------------------------|--------------------------------|---------------|---------------|---------------|---------------|
| Case Height (mm)             | Maximum Emitter<br>Height (mm) | $\Delta T50$  | $\Delta T50$  | $\Delta T50$  | $\Delta T50$  |
| 585                          | 300                            | 522           | 783           | 1031          | 1512          |
| 655                          | 300                            | 522           | 783           | 1031          | 1512          |
| 655                          | 400                            | 678           | 987           | 1301          | 1930          |
| 795                          | 300                            | 522           | 783           | 1031          | 1512          |
| 795                          | 400                            | 678           | 987           | 1301          | 1930          |
| 795                          | 500                            | 823           | 1175          | 1555          | 2307          |
| 865                          | 300                            | 522           | 783           | 1031          | 1512          |
| 865                          | 400                            | 678           | 987           | 1301          | 1930          |
| 865                          | 500                            | 823           | 1175          | 1555          | 2307          |
| 865                          | 600                            | 958           | 1351          | 1797          | 2643          |
| 935                          | 300                            | 522           | 783           | 1031          | 1512          |
| 935                          | 400                            | 678           | 987           | 1301          | 1930          |
| 935                          | 500                            | 823           | 1175          | 1555          | 2307          |
| 935                          | 600                            | 958           | 1351          | 1797          | 2643          |

# Primo (RT-Series) Outputs

## Watts per metre of emitter

### Style 7 LST Cover

| Emitter Type:<br>Case Depth: |                                | RT11<br>103mm | RT21<br>103mm | RT22<br>153mm | RT33<br>259mm |
|------------------------------|--------------------------------|---------------|---------------|---------------|---------------|
| Case Height (mm)             | Maximum Emitter<br>Height (mm) | $\Delta T50$  | $\Delta T50$  | $\Delta T50$  | $\Delta T50$  |
| 585                          | 300                            | 522           | 783           | 1031          | 1512          |
| 655                          | 300                            | 522           | 783           | 1031          | 1512          |
| 655                          | 400                            | 678           | 987           | 1301          | 1930          |
| 725                          | 300                            | 522           | 783           | 1031          | 1512          |
| 725                          | 400                            | 678           | 987           | 1301          | 1930          |
| 795                          | 300                            | 522           | 783           | 1031          | 1512          |
| 795                          | 400                            | 678           | 987           | 1301          | 1930          |
| 795                          | 500                            | 823           | 1175          | 1555          | 2307          |
| 865                          | 300                            | 522           | 783           | 1031          | 1512          |
| 865                          | 400                            | 678           | 987           | 1301          | 1930          |
| 865                          | 500                            | 823           | 1175          | 1555          | 2307          |
| 865                          | 600                            | 958           | 1351          | 1797          | 2643          |
| 935                          | 300                            | 522           | 783           | 1031          | 1512          |
| 935                          | 400                            | 678           | 987           | 1301          | 1930          |
| 935                          | 500                            | 823           | 1175          | 1555          | 2307          |
| 935                          | 600                            | 958           | 1351          | 1797          | 2643          |
| 1005                         | 300                            | 522           | 783           | 1031          | 1512          |
| 1005                         | 400                            | 678           | 987           | 1301          | 1930          |
| 1005                         | 500                            | 823           | 1175          | 1555          | 2307          |
| 1005                         | 600                            | 958           | 1351          | 1797          | 2643          |
| 1005                         | 700                            | 1084          | 1514          | 2028          | 2942          |

### Style 8 LST Cover

| Emitter Type:<br>Case Depth: |                                | RT11<br>103mm | RT21<br>103mm | RT22<br>153mm | RT33<br>259mm |
|------------------------------|--------------------------------|---------------|---------------|---------------|---------------|
| Case Height (mm)             | Maximum Emitter<br>Height (mm) | $\Delta T50$  | $\Delta T50$  | $\Delta T50$  | $\Delta T50$  |
| 585                          | 300                            | 522           | 783           | 1031          | 1512          |
| 655                          | 300                            | 522           | 783           | 1031          | 1512          |
| 725                          | 300                            | 522           | 783           | 1031          | 1512          |
| 725                          | 400                            | 678           | 987           | 1301          | 1930          |
| 795                          | 300                            | 522           | 783           | 1031          | 1512          |
| 795                          | 400                            | 678           | 987           | 1301          | 1930          |
| 795                          | 500                            | 823           | 1175          | 1555          | 2307          |
| 865                          | 300                            | 522           | 783           | 1031          | 1512          |
| 865                          | 400                            | 678           | 987           | 1301          | 1930          |
| 865                          | 500                            | 823           | 1175          | 1555          | 2307          |
| 935                          | 300                            | 522           | 783           | 1031          | 1512          |
| 935                          | 400                            | 678           | 987           | 1301          | 1930          |
| 935                          | 500                            | 823           | 1175          | 1555          | 2307          |
| 935                          | 600                            | 958           | 1351          | 1797          | 2643          |
| 1005                         | 300                            | 522           | 783           | 1031          | 1512          |
| 1005                         | 400                            | 678           | 987           | 1301          | 1930          |
| 1005                         | 500                            | 823           | 1175          | 1555          | 2307          |
| 1005                         | 600                            | 958           | 1351          | 1797          | 2643          |
| 1005                         | 700                            | 1084          | 1514          | 2028          | 2942          |

# Primo (RT-Series) Outputs

## Watts per metre of emitter

### Style 10 LST Cover

| Emitter Type:<br>Case Depth: |                                | RT22<br>153mm |              | RT33<br>259mm |              |
|------------------------------|--------------------------------|---------------|--------------|---------------|--------------|
| Case Height (mm)             | Maximum Emitter<br>Height (mm) | $\Delta T50$  | $\Delta T56$ | $\Delta T50$  | $\Delta T56$ |
| 420                          | 300                            | 1031          | 1195         | 1512          | 1752         |
| 490                          | 300                            | 1031          | 1195         | 1512          | 1752         |

**Please Note:** Style 10 LST covers are quoted to be 153mm & 259mm deep, although the actual depth is 164mm & 270mm; This is due to the introduction of the rear panel.

# Additional Options - Horizontal LST

## E-Series & RT-Series

### Wall-to-Wall System

When ordering Merriott Wall-to-Wall LSTs, simply specify the full wall length and indicate which LST style you require.

The Merriott Team will make the appropriate alterations for the panel length and supply all required end-spacers and joiner brackets (see diagram below).

LST covers have a maximum length of 3000mm in one section. When LSTs have been joined, there will be a 20mm gap between the front panels where you will be able to see the front flange of the joiner bracket. This is painted the same colour as the casing, making it completely unnoticeable.

The diagram below shows an isometric view of a typical Merriott LST in a wall-to-wall application, with a left hand spacer, joiner bracket and right hand spacer. Merriott also offers 90° and 135° internal and external corner applications to fit around corners. Please contact the Merriott Sales Office for more information.

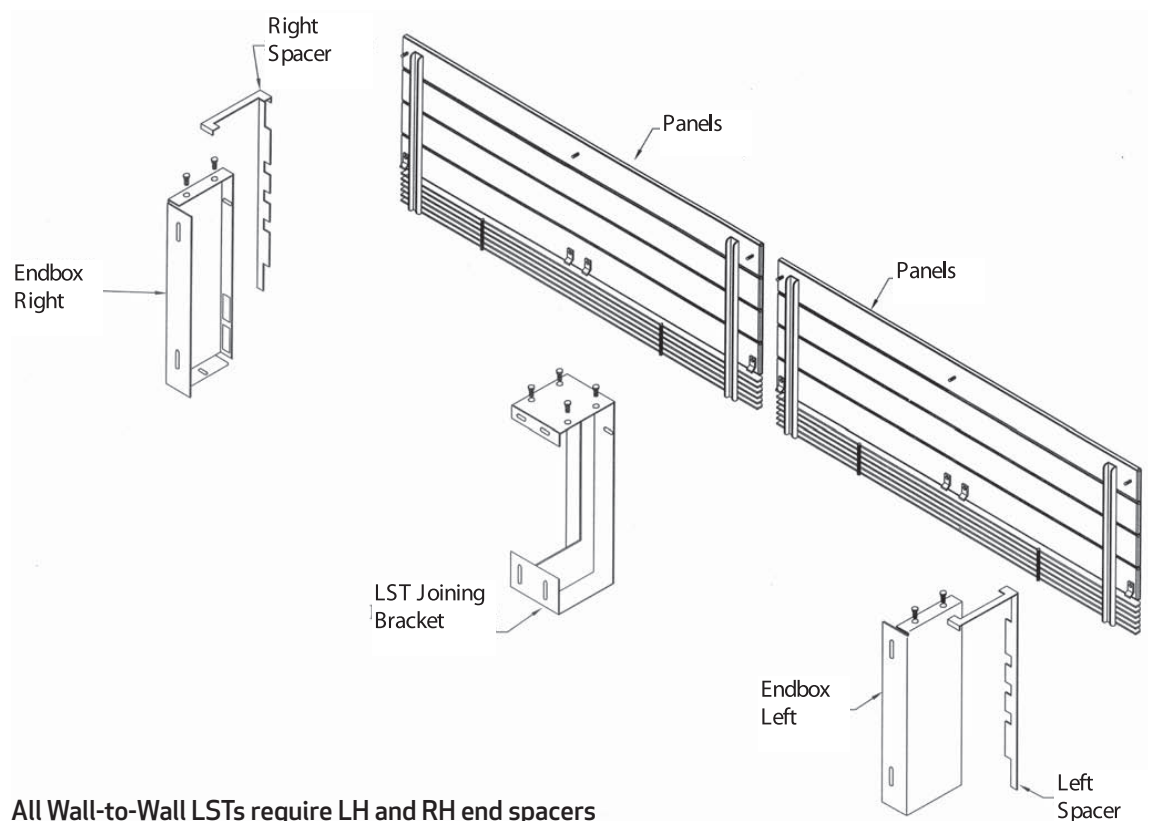

## Vertical LST with Profile Emitter

# Vertical Model Options

## Vertical LST Casing Styles

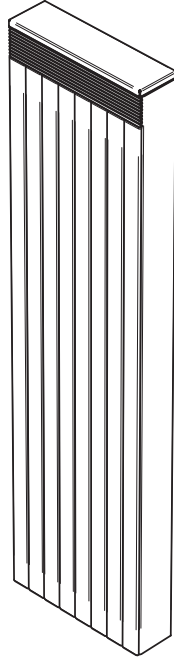

**Style 26 - WALL MOUNTED**

- Forward facing front grille
- Solid top

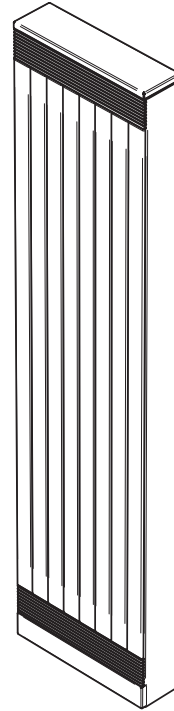

**Style 28 - FLOOR MOUNTED**

- Forward facing front grilles at top and bottom
- Solid top

## Vertical Profile Emitter

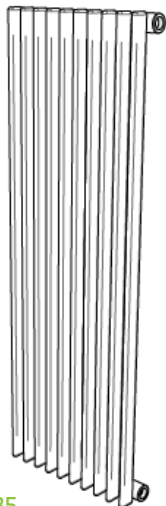

**ES35**

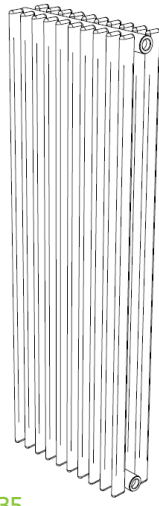

**ED35**

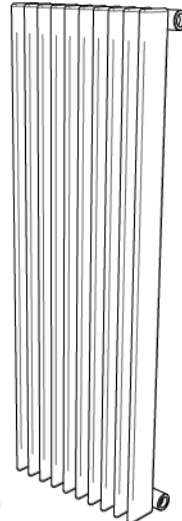

**ES70**

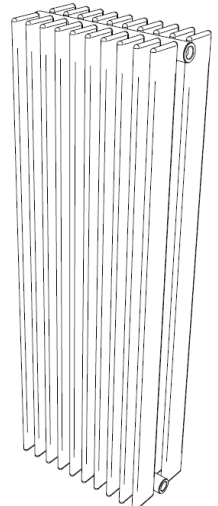

**ED70**

# Technical Specifications - Vertical LST

## Profile Vertical Radiators with Style 26 casing

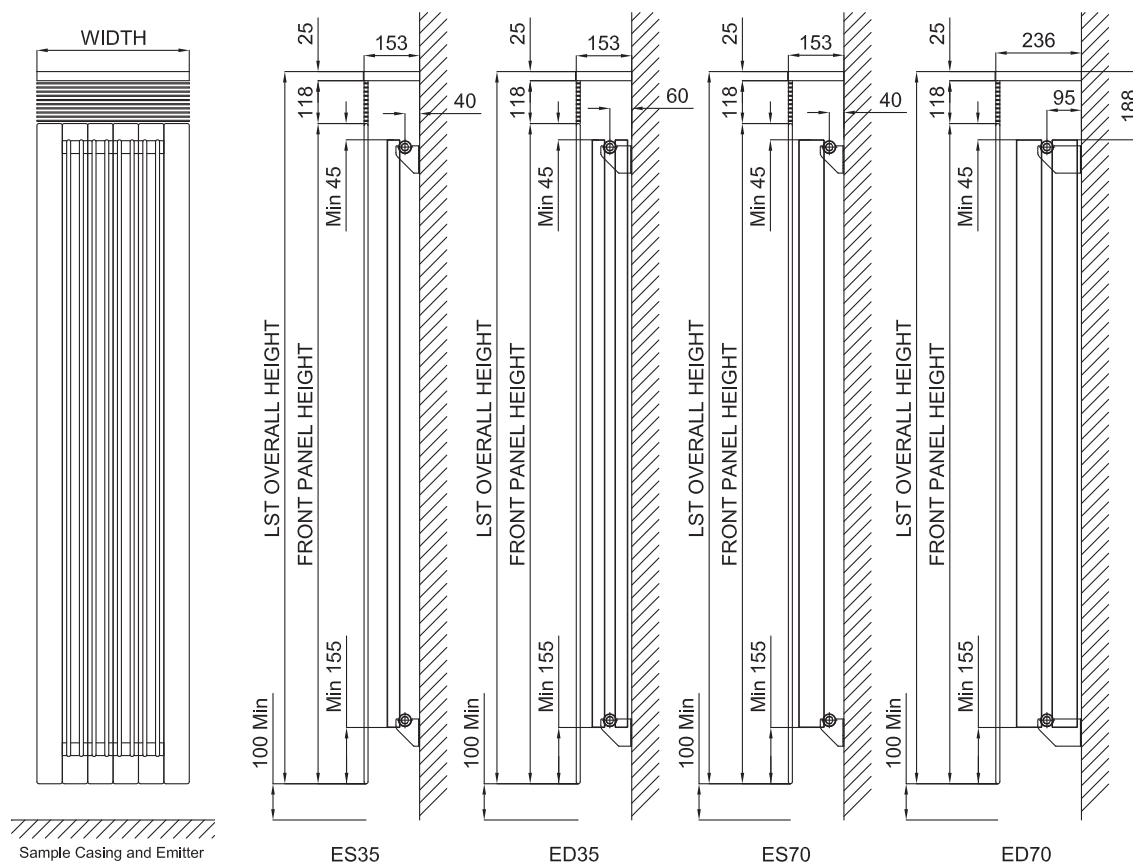

### Typical LST Case Width

For a Profile emitter with connection details EF/GH = Emitter width + 140mm.

For a Profile emitter with connection details BD/AD = Emitter width + 280mm (increments of 70mm).

### Typical LST Height

Profile emitter height + 343mm

### Example

| Emitter Type | Emitter Size | Profile Output ( $\Delta T50$ ) | Suggested LST Case Size |
|--------------|--------------|---------------------------------|-------------------------|
| ES35         | 2000 X 420   | 1007                            | 2343 X 560 X 153        |
| ED35         | 2000 X 420   | 1474                            | 2343 X 560 X 153        |
| ES70         | 2000 X 400   | 1203                            | 2343 X 560 X 153        |
| ED70         | 2000 X 400   | 2053                            | 2343 X 560 X 236        |



# Vertical Profile LST Outputs

## Style LC26

The emitters used in the output table below are an EF/GH connection. Should side connections be required (A, B, C or D) please increase the case width by a minimum of 210mm to allow for pipework.

| Case Size   |            | Emitter Type:  |               | ES35         | ED35         | Emitter Type:  |               | ES70         | ED70         |
|-------------|------------|----------------|---------------|--------------|--------------|----------------|---------------|--------------|--------------|
| Case Height | Case Width | Emitter Height | Emitter Width | $\Delta T50$ | $\Delta T50$ | Emitter Height | Emitter Width | $\Delta T50$ | $\Delta T50$ |
| 1943        | 490        | 1600           | 350           | 678          | 1036         | 1600           | 320           | 777          | 1332         |
| 1943        | 560        | 1600           | 420           | 814          | 1243         | 1600           | 400           | 971          | 1665         |
| 1943        | 630        | 1600           | 490           | 949          | 1450         | 1600           | 480           | 1166         | 1998         |
| 1943        | 700        | 1600           | 560           | 1085         | 1658         | 1600           | 560           | 1360         | 2331         |
| 1943        | 770        | 1600           | 630           | 1220         | 1865         | 1600           | 640           | 1554         | 2664         |
| 1943        | 840        | 1600           | 700           | 1356         | 2072         | 1600           | 720           | 1748         | 2997         |
| 2043        | 490        | 1700           | 350           | 718          | 1087         | 1700           | 320           | 825          | 1410         |
| 2043        | 560        | 1700           | 420           | 861          | 1304         | 1700           | 400           | 1031         | 1762         |
| 2043        | 630        | 1700           | 490           | 1005         | 1522         | 1700           | 480           | 1238         | 2115         |
| 2043        | 700        | 1700           | 560           | 1148         | 1739         | 1700           | 560           | 1444         | 2467         |
| 2043        | 770        | 1700           | 630           | 1292         | 1956         | 1700           | 640           | 1650         | 2819         |
| 2043        | 840        | 1700           | 700           | 1436         | 2174         | 1700           | 720           | 1856         | 3172         |
| 2143        | 490        | 1800           | 350           | 758          | 1138         | 1800           | 320           | 873          | 1487         |
| 2143        | 560        | 1800           | 420           | 909          | 1365         | 1800           | 400           | 1092         | 1859         |
| 2143        | 630        | 1800           | 490           | 1061         | 1593         | 1800           | 480           | 1310         | 2231         |
| 2143        | 700        | 1800           | 560           | 1212         | 1820         | 1800           | 560           | 1528         | 2603         |
| 2143        | 770        | 1800           | 630           | 1364         | 2048         | 1800           | 640           | 1746         | 2975         |
| 2143        | 840        | 1800           | 700           | 1515         | 2276         | 1800           | 720           | 1965         | 3347         |
| 2243        | 490        | 1900           | 350           | 798          | 1184         | 1900           | 320           | 918          | 1565         |
| 2243        | 560        | 1900           | 420           | 958          | 1421         | 1900           | 400           | 1147         | 1956         |
| 2243        | 630        | 1900           | 490           | 1118         | 1658         | 1900           | 480           | 1376         | 2348         |
| 2243        | 700        | 1900           | 560           | 1277         | 1894         | 1900           | 560           | 1606         | 2739         |
| 2243        | 770        | 1900           | 630           | 1437         | 2131         | 1900           | 640           | 1835         | 3130         |
| 2243        | 840        | 1900           | 700           | 1597         | 2368         | 1900           | 720           | 2065         | 3521         |
| 2343        | 490        | 2000           | 350           | 839          | 1228         | 2000           | 320           | 962          | 1643         |
| 2343        | 560        | 2000           | 420           | 1007         | 1474         | 2000           | 400           | 1203         | 2054         |
| 2343        | 630        | 2000           | 490           | 1175         | 1720         | 2000           | 480           | 1443         | 2464         |
| 2343        | 700        | 2000           | 560           | 1342         | 1965         | 2000           | 560           | 1684         | 2875         |
| 2343        | 770        | 2000           | 630           | 1510         | 2211         | 2000           | 640           | 1924         | 3286         |
| 2343        | 840        | 2000           | 700           | 1678         | 2456         | 2000           | 720           | 2165         | 3696         |
| 2443        | 490        | 2100           | 350           | 880          | 1272         | 2100           | 320           | 1010         | 1724         |
| 2443        | 560        | 2100           | 420           | 1056         | 1526         | 2100           | 400           | 1263         | 2155         |
| 2443        | 630        | 2100           | 490           | 1232         | 1781         | 2100           | 480           | 1515         | 2586         |
| 2443        | 700        | 2100           | 560           | 1407         | 2035         | 2100           | 560           | 1768         | 3017         |
| 2443        | 770        | 2100           | 630           | 1583         | 2289         | 2100           | 640           | 2020         | 3448         |
| 2443        | 840        | 2100           | 700           | 1759         | 2544         | 2100           | 720           | 2273         | 3879         |
| 2543        | 490        | 2200           | 350           | 920          | 1314         | 2200           | 320           | 1058         | 1806         |
| 2543        | 560        | 2200           | 420           | 1104         | 1576         | 2200           | 400           | 1323         | 2257         |
| 2543        | 630        | 2200           | 490           | 1289         | 1839         | 2200           | 480           | 1587         | 2708         |
| 2543        | 700        | 2200           | 560           | 1473         | 2102         | 2200           | 560           | 1852         | 3160         |
| 2543        | 770        | 2200           | 630           | 1657         | 2364         | 2200           | 640           | 2116         | 3611         |
| 2543        | 840        | 2200           | 700           | 1841         | 2627         | 2200           | 720           | 2381         | 4063         |

# Technical Specifications - Vertical LST

## Profile Vertical Radiators with Style 28 casing

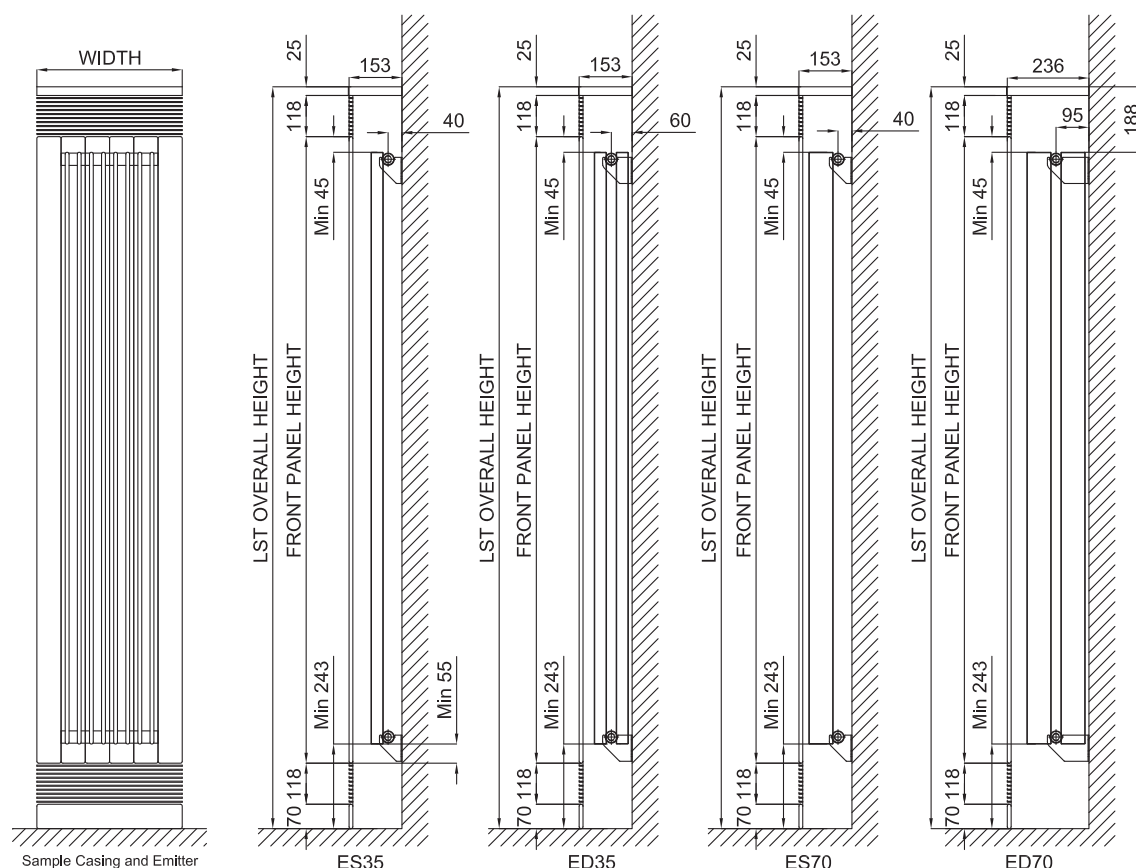

### Typical LST Case Width

For a Profile emitter with connection details EF/GH = Emitter width + 140mm.

For a Profile emitter with connection details BD/AD = Emitter width + 280mm (increments of 70mm).

### Typical LST Height

Profile emitter height + 431mm

### Example

| Emitter Type | Emitter Size | Profile Output ( $\Delta T50$ ) | Profile Output ( $\Delta T56$ ) | Suggested LST Case Size |
|--------------|--------------|---------------------------------|---------------------------------|-------------------------|
| ES35         | 2000 X 420   | 1007                            | 1167                            | 2431 X 560 X 153        |
| ED35         | 2000 X 420   | 1474                            | 1697                            | 2431 X 560 X 153        |
| ES70         | 2000 X 400   | 1203                            | 1393                            | 2431 X 560 X 153        |
| ED70         | 2000 X 400   | 2053                            | 2379                            | 2431 X 560 X 236        |

# Vertical Profile LST Outputs

## Style LC28

The emitters used in the output table below are an EF/GH connection. Should side connections be required (A, B, C or D) please increase the case width by a minimum of 140mm to allow for pipework.

| Case Size   |            | Emitter Type:  |               | ES35         | ED35         | Emitter Type:  |               | ES70         | ED70         |
|-------------|------------|----------------|---------------|--------------|--------------|----------------|---------------|--------------|--------------|
| Case Height | Case Width | Emitter Height | Emitter Width | $\Delta T50$ | $\Delta T50$ | Emitter Height | Emitter Width | $\Delta T50$ | $\Delta T50$ |
| 2031        | 490        | 1600           | 350           | 678          | 1036         | 1600           | 320           | 777          | 1332         |
| 2031        | 560        | 1600           | 420           | 814          | 1243         | 1600           | 400           | 971          | 1665         |
| 2031        | 630        | 1600           | 490           | 949          | 1450         | 1600           | 480           | 1166         | 1998         |
| 2031        | 700        | 1600           | 560           | 1085         | 1658         | 1600           | 560           | 1360         | 2331         |
| 2031        | 770        | 1600           | 630           | 1220         | 1865         | 1600           | 640           | 1554         | 2664         |
| 2031        | 840        | 1600           | 700           | 1356         | 2072         | 1600           | 720           | 1748         | 2997         |
| 2131        | 490        | 1700           | 350           | 718          | 1087         | 1700           | 320           | 825          | 1410         |
| 2131        | 560        | 1700           | 420           | 861          | 1304         | 1700           | 400           | 1031         | 1762         |
| 2131        | 630        | 1700           | 490           | 1005         | 1522         | 1700           | 480           | 1238         | 2115         |
| 2131        | 700        | 1700           | 560           | 1148         | 1739         | 1700           | 560           | 1444         | 2467         |
| 2131        | 770        | 1700           | 630           | 1292         | 1956         | 1700           | 640           | 1650         | 2819         |
| 2131        | 840        | 1700           | 700           | 1436         | 2174         | 1700           | 720           | 1856         | 3172         |
| 2231        | 490        | 1800           | 350           | 758          | 1138         | 1800           | 320           | 873          | 1487         |
| 2231        | 560        | 1800           | 420           | 909          | 1365         | 1800           | 400           | 1092         | 1859         |
| 2231        | 630        | 1800           | 490           | 1061         | 1593         | 1800           | 480           | 1310         | 2231         |
| 2231        | 700        | 1800           | 560           | 1212         | 1820         | 1800           | 560           | 1528         | 2603         |
| 2231        | 770        | 1800           | 630           | 1364         | 2048         | 1800           | 640           | 1746         | 2975         |
| 2231        | 840        | 1800           | 700           | 1515         | 2276         | 1800           | 720           | 1965         | 3347         |
| 2331        | 490        | 1900           | 350           | 798          | 1184         | 1900           | 320           | 918          | 1565         |
| 2331        | 560        | 1900           | 420           | 958          | 1421         | 1900           | 400           | 1147         | 1956         |
| 2331        | 630        | 1900           | 490           | 1118         | 1658         | 1900           | 480           | 1376         | 2348         |
| 2331        | 700        | 1900           | 560           | 1277         | 1894         | 1900           | 560           | 1606         | 2739         |
| 2331        | 770        | 1900           | 630           | 1437         | 2131         | 1900           | 640           | 1835         | 3130         |
| 2331        | 840        | 1900           | 700           | 1597         | 2368         | 1900           | 720           | 2065         | 3521         |
| 2431        | 490        | 2000           | 350           | 839          | 1228         | 2000           | 320           | 962          | 1643         |
| 2431        | 560        | 2000           | 420           | 1007         | 1474         | 2000           | 400           | 1203         | 2054         |
| 2431        | 630        | 2000           | 490           | 1175         | 1720         | 2000           | 480           | 1443         | 2464         |
| 2431        | 700        | 2000           | 560           | 1342         | 1965         | 2000           | 560           | 1684         | 2875         |
| 2431        | 770        | 2000           | 630           | 1510         | 2211         | 2000           | 640           | 1924         | 3286         |
| 2431        | 840        | 2000           | 700           | 1678         | 2456         | 2000           | 720           | 2165         | 3696         |
| 2531        | 490        | 2100           | 350           | 880          | 1272         | 2100           | 320           | 1010         | 1724         |
| 2531        | 560        | 2100           | 420           | 1056         | 1526         | 2100           | 400           | 1263         | 2155         |
| 2531        | 630        | 2100           | 490           | 1232         | 1781         | 2100           | 480           | 1515         | 2586         |
| 2531        | 700        | 2100           | 560           | 1407         | 2035         | 2100           | 560           | 1768         | 3017         |
| 2531        | 770        | 2100           | 630           | 1583         | 2289         | 2100           | 640           | 2020         | 3448         |
| 2531        | 840        | 2100           | 700           | 1759         | 2544         | 2100           | 720           | 2273         | 3879         |
| 2631        | 490        | 2200           | 350           | 920          | 1314         | 2200           | 320           | 1058         | 1806         |
| 2631        | 560        | 2200           | 420           | 1104         | 1576         | 2200           | 400           | 1323         | 2257         |
| 2631        | 630        | 2200           | 490           | 1289         | 1839         | 2200           | 480           | 1587         | 2708         |
| 2631        | 700        | 2200           | 560           | 1473         | 2102         | 2200           | 560           | 1852         | 3160         |
| 2631        | 770        | 2200           | 630           | 1657         | 2364         | 2200           | 640           | 2116         | 3611         |
| 2631        | 840        | 2200           | 700           | 1841         | 2627         | 2200           | 720           | 2381         | 4063         |

# Optional TRV Configurations – All Emitters

Merriott offers a comprehensive range of access options for Thermostatic Radiator Valves (TRV) as well as pipework.

End panels can be supplied with cut-outs or knockouts, catflaps and pipework cutout. Should no reference to any features is specify at the time of quoting, the LST cover will be delivered with blank end panels.

## End panel TRV cutout and knockout

Handings must be specify at the time of quoting. If this is not available, at the time of order, knockouts will be supplied.

- All TRV cutouts will be positioned to allow for an inline TRV to protrude. See below proposed position on the end panels. Alternative positions are available at an extra cost.
- TRV make and model needs to be provided at the time of order as the cutout sizes vary.

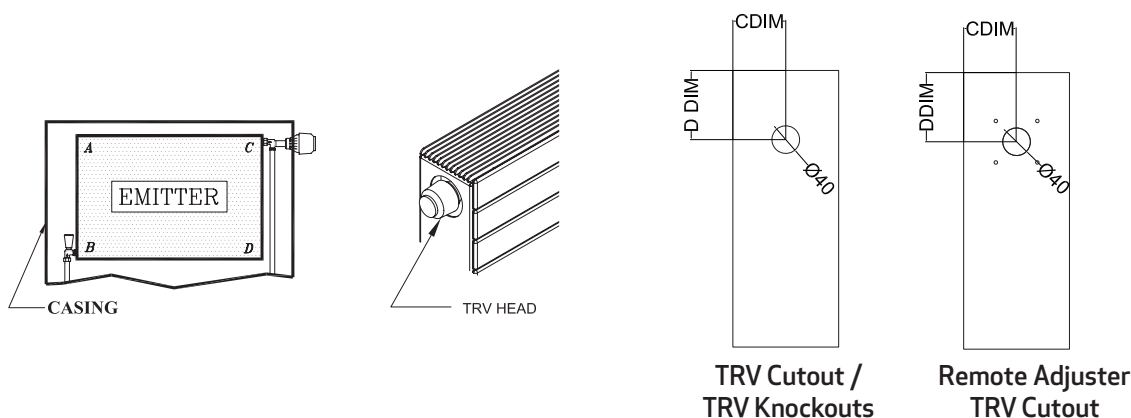

| STYLE 2, 3, 4, 10 | CDIM (mm) | DDIM (mm) |
|-------------------|-----------|-----------|
| E10, E11, E12     | 38        | 52        |
| E20, E21          | 60        | 52        |
| E22               | 105       | 52        |
| E22S              | 80        | 52        |
| E23, E24          | 125       | 52        |

| STYLE 6, 7, 8 | CDIM (mm) | DDIM (mm) |
|---------------|-----------|-----------|
| E10, E11, E12 | 38        | 135       |
| E20, E21      | 60        | 135       |
| E22           | 105       | 135       |
| E22S          | 80        | 135       |
| E23, E24      | 125       | 135       |

## Front Facing Remote Adjuster TRV Cutout

Handings and location for the cutout used for front facing remote sensor / adjuster TRV as well as the make and model of the TRV must be specified at the time of order.

This is suitable for radiator with BD connection.

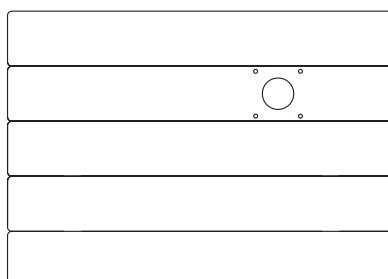
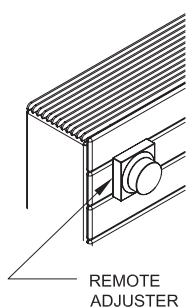

# Optional TRV Configurations – All Emitters

## Catflap or access door

A catflap is a useful option when using a remote caterpillar sensor TRV located inside the casing.

The standard dimensions for a catflap are 70mm x 140mm. Handings and the location on the end panel should be specified at the time of order (top/bottom, left/right)

Catflap access is non lockable. They are available in other RAL colours for areas used by people visually impaired.

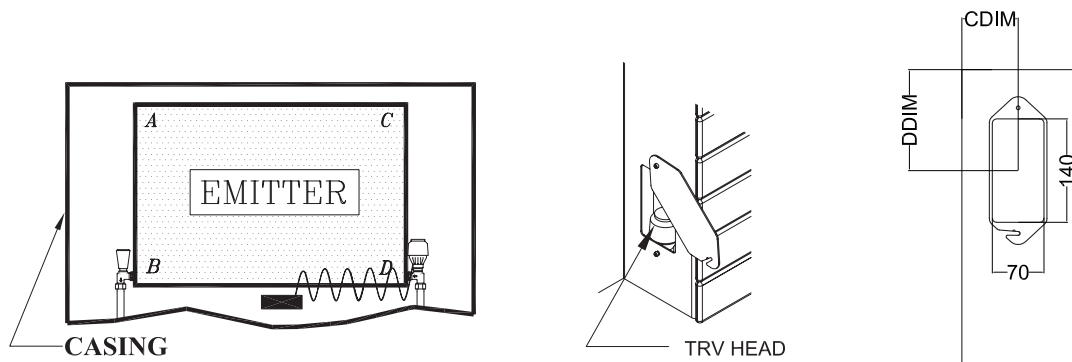

## Pipework cutout

Pipework cutout is as standard 75mm x 100mm. Should anything different be required, it must be specified at the time of order.

Pipework cutouts are available in conjunction with all types of TRV cutouts and catflaps. Handings must be specified at the time of order.

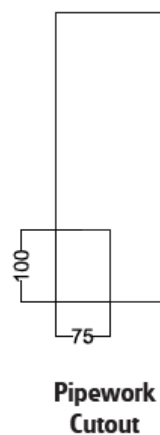

# Optional Grilles - All Emitters

- Hinged top grille handing should be specified at the time of order
- Anti-ligature mesh should be specified at time of order and is used instead of all grilles on specified LST
- Use of anti-ligature grilles will reduce output by 26% and unit will no longer be NHS compliant at 43 deg

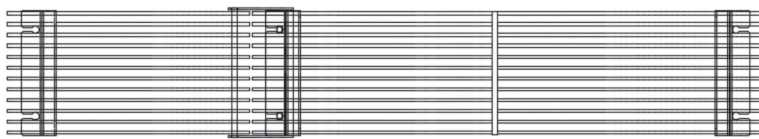

Hinged top grille



Anti-Ligature top grille

# Contact details

## Merriott UK (Manufacturing Facility)

QRL Radiator Group, Imperial Park, Newport, NP10 8FS

Tel: +44 (0) 1633 657 000

Fax: +44 (0) 1633 681 864

## UK Enquiries

Tel: 01633 657223

Fax: 01633 657215

[sales@merriottuk.com](mailto:sales@merriottuk.com)

## Merriott Ireland

Derrylin, Co. Fermanagh, BT92 9AU

## Irish Enquiries

### Northern Ireland

Tel: 0800 389 9980

Fax: 0286 774 2998

[sales@merriotuk.com](mailto:sales@merriotuk.com)

### Republic of Ireland

Tel: 1800 882 332

Fax: 0486 774 2998

[sales@merriot.ie](mailto:sales@merriot.ie)

[www.merriottuk.com](http://www.merriottuk.com) / [www.merriott.ie](http://www.merriott.ie)

Follow us on  @merriottuk and 